



Bush & Co.



# Flat 11 Millcroft Court Mill Road, Cambridge - Guide Price £165,000

Millcroft Court is a purpose built retirement complex of similar homes set within beautifully kept communal garden areas and with ample residents car parking. The development sits back from Mill Road with a barrier access and offers many conveniences with good range of shops, cafes, supermarkets, post office, chemist, doctors etc all on your doorstep. The city centre, Addenbrookes hospital and the railway station are all within easy reach too. Millcroft Court has an enviable community feel with a large residents lounge which hosts regular events, a quiet reading room with seating terrace overlooking gardens and two laundry rooms. There is a house manager on site during working hours and each apartment has a 24 hour careline system installed. Number 11 is situated in a lovely ground floor position within the development overlooking the beautifully kept gardens, the launderette is also close by. The

## IMPORTANT NOTICE

These particulars, whilst believed to be accurate are set out as a general outline only for guidance and do not constitute any part of an offer or contract. Intending purchasers should not rely on them as statements of representation of fact, but must satisfy themselves by inspection or otherwise as to their accuracy. No person in this firms employment has the authority to make or give any representation or warranty in respect of the property.

apartment comprises hallway with storage cupboard, sitting room which is open to the re-fitted kitchen area, generous double bedroom with built in wardrobes and bathroom with bath, W.C. The patio doors open up directly onto the communal gardens. The windows are double glazed and there is an electric heating system.

TENURE - Leasehold  
TERM - 99 years from 1987  
MAINTENANCE CHARGES - £1676.39 twice yearly  
GROUND RENT - £137.54 twice yearly  
COUNCIL TAX - Band B  
LOCAL AUTHORITY - Cambridge City Council  
FIXTURES & FITTINGS - Unless specifically mentioned in these particulars all fixtures and fittings are expressly excluded from the sale



Millcroft Court, Mill Road, Cambridge, CB1 3PE

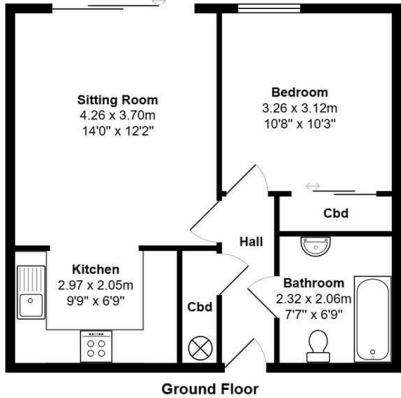

Total Area: 44.4 m² ... 477 ft²  
All measurements are approximate and for display purposes only  
Plan prepared by charlesjharrison.co.uk

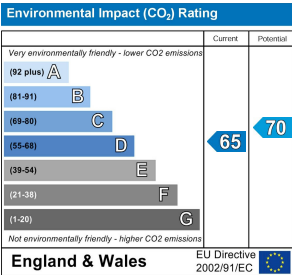
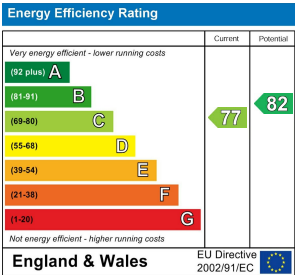

Sales Office:  
169 Mill Road, Cambridge CB1 3AN  
01223 246262 sales@bushandco.co.uk

Lettings Office:  
8 The Broadway, Mill Road, Cambridge CB1 3AH  
01223 508085 Lettings@bushandco.co.uk