



# Barons Way

Kingsthorpe Village, Northampton

oriordanbond  
SALES & LETTINGS





GROUND FLOOR  
1027 sq.ft. (95.4 sq.m.) approx.

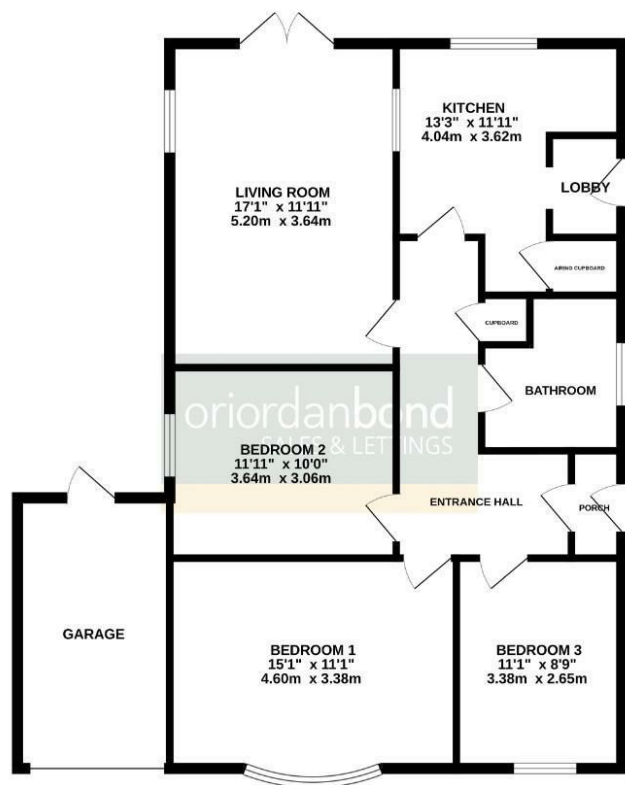

TOTAL FLOOR AREA: 1027 sq.ft. (95.4 sq.m.) approx.

While every attempt has been made to ensure the accuracy of the floorplan contained here, measurements of areas, volumes, rooms and any other items are approximate and no responsibility is taken for any error, omission or mis-statement. This plan is for illustrative purposes only and should be used as such for any prospective purchaser. The services, systems and appliances shown have not been tested and no guarantee as to their operability or efficiency can be given.  
Made with Metropix (2020)

## Barons Way

Kingsthorpe Village

NN2 8HP

PRICE £365,000

A rarely available three bedroom detached bungalow with further potential, located in the popular Kingsthorpe Village, offered to the market with no onward chain. The property is within easy access to local amenities and a short drive to open countryside.

Accommodation comprises entrance hall, three double bedrooms, large family shower room with walk-in shower, dual aspect sitting room with French doors to the rear garden and a large kitchen with side access. Outside is a south/westerly facing rear garden with patio area leading to laid to lawn. To the front of the property is a blocked paved driveway providing off road parking for several vehicles leading to a single garage with electric roller door. Further benefits include gas radiator heating and uPVC double glazing. (B/937/M)

### Additional information

- Council Tax Band: D
- Energy Efficiency Rating: D

### Viewing

Viewing strictly by appointment – details below

### Disclaimer

O'Riordan Bond Estate Agents Limited has not tested apparatus, equipment, fittings or services and so cannot verify they are in working order. The buyer is advised to obtain verification from their solicitor or surveyor.

O'Riordan Bond Kingsthorpe Sales

01604 722007

kingsthorpe@oriordanbond.co.uk

