



The Green

Kingsthorpe Village, Northampton

oriordanbond
SALES & LETTINGS



GROUND FLOOR
706 sq.ft. (65.6 sq.m.) approx.

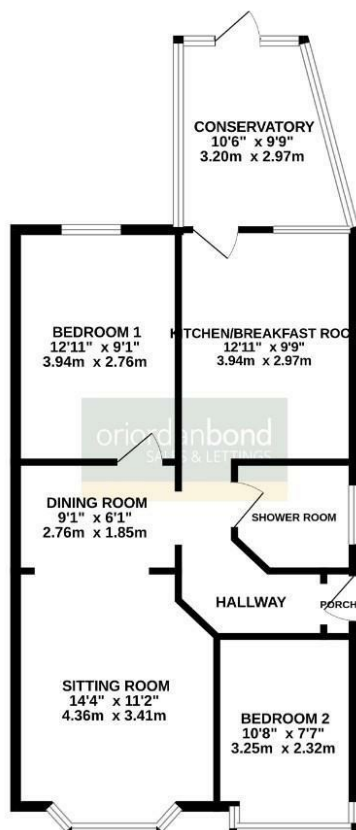

TOTAL FLOOR AREA : 706 sq.ft. (65.6 sq.m.) approx.
Whilst every attempt has been made to ensure the accuracy of the floorplan contained here, measurements of doors, windows, rooms and any other items are approximate and no responsibility is taken for any error, omission or misstatement. This plan is for illustrative purposes only and should be used as such by any prospective purchaser. The services, systems and appliances shown have not been tested and no guarantee as to their operability or efficiency can be given.
Made with AutoCAD 2012

The Green

Kingsthorpe Village
NN2 6QD

OFFERS OVER £210,000

A two bedroom semi-detached bungalow set in popular Kingsthorpe village. The property is a short walk from local shops, schools, a bus stop and the village green.

Accommodation comprises entrance hall, spacious bay fronted sitting room open to dining area, large kitchen/breakfast room, conservatory, two bedrooms and a shower room with walk-in corner shower. Outside to the rear of the property is a private garden with patio area leading to laid lawn and shrub borders. To the front of the property is a low maintenance garden and stone boundary wall. Further benefits include uPVC double glazing and gas radiator heating. (B/706/M)

Additional information

- Council Tax Band: B
- Energy Efficiency Rating:

Viewing

Viewing strictly by appointment – details below

Disclaimer

O'Riordan Bond Estate Agents Limited has not tested apparatus, equipment, fittings or services and so cannot verify they are in working order. The buyer is advised to obtain verification from their solicitor or surveyor.

O'Riordan Bond Kingsthorpe Sales
01604 722007

kingsthorpe@oriordanbond.co.uk

