



Finney Drive

Grange Park, Northampton

oriordanbond
SALES & LETTINGS



Finney Drive

Grange Park
NN4 5DT

Guide Price
£300,000

O'Riordan Bond is delighted to offer for sale this well presented three bedroom town house, on the sought after estate of Grange Park, close to local amenities, Woodland View Primary School and Foxfield Country Park.

Accommodation comprises entrance hall, utility room, bathroom and bedroom three on the ground floor. To the first floor is a good size sitting room and kitchen/dining room. The second floor offers two double bedrooms both with en-suite shower rooms. Outside is an enclosed private garden to the rear and a driveway to the front providing off road parking leading to an integral garage. Further benefits include uPVC double glazing and gas radiator heating. (A/1155/M)

- Well presented three bedroom town house
- Two en-suite bedrooms and further shower room
- Good size sitting room and kitchen/diner
- Gas radiator heating
- Enclosed rear garden
- Off road parking and integral garage





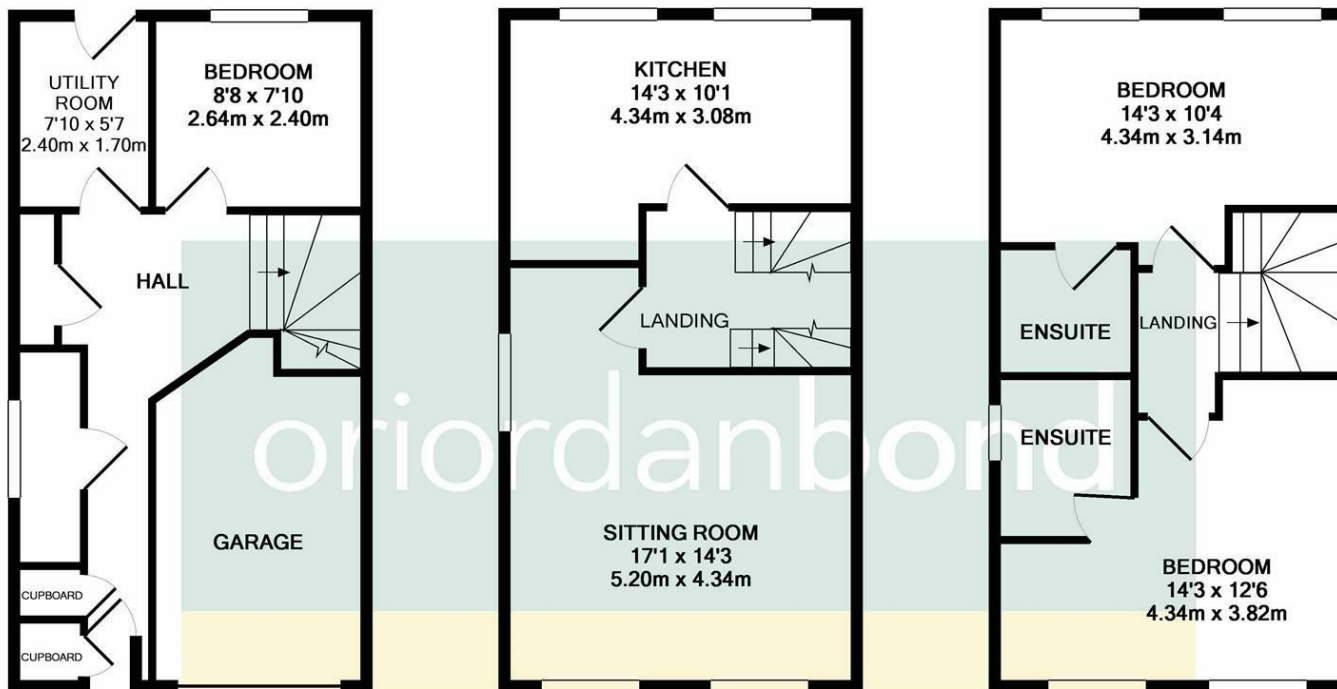

GROUND FLOOR
APPROX. FLOOR
AREA 382 SQ.FT.
(35.5 SQ.M.)

1ST FLOOR
APPROX. FLOOR
AREA 387 SQ.FT.
(35.9 SQ.M.)

TOTAL APPROX. FLOOR AREA 1155 SQ.FT. (107.3 SQ.M.)

Whilst every attempt has been made to ensure the accuracy of the floor plan contained here, measurements of doors, windows, rooms and any other items are approximate and no responsibility is taken for any error, omission, or mis-statement. This plan is for illustrative purposes only and should be used as such by any prospective purchaser. The services, systems and appliances shown have not been tested and no guarantee as to their operability or efficiency can be given
Made with Metropix ©2020

2ND FLOOR
APPROX. FLOOR
AREA 387 SQ.FT.
(35.9 SQ.M.)



Additional information

- Council Tax Band: D
- Energy Efficiency Rating: C

Viewing

Viewing strictly by appointment – details below

Disclaimer

O'Riordan Bond Estate Agents Limited has not tested apparatus, equipment, fittings or services and so cannot verify they are in working order. The buyer is advised to obtain verification from their solicitor or surveyor.

O'Riordan Bond Grange Park Sales
01604 432007

grangepark@oriordanbond.co.uk

