



# Tate Grove

Hardingstone, Northampton

oriordanbond  
SALES & LETTINGS





## Tate Grove

Hardingstone  
NN4 6UY

PRICE £260,000

Recently renovated throughout is this modern two bedroom semi-detached family home, in the popular location of Hardingstone, offered for sale with no onward chain.

The accommodation comprises entrance hall, sitting room, kitchen/dining room and conservatory leading to a south facing garden. On the first floor are two bedrooms and a family bathroom. Outside are front and rear gardens and a single garage with off road parking in front. Further benefits include gas radiator heating serviced by a two year old boiler and uPVC double glazing. (A/593/M)

### Additional information

- Council Tax Band: B
- Energy Efficiency Rating: D

### Viewing

Viewing strictly by appointment – details below

### Disclaimer

O'Riordan Bond Estate Agents Limited has not tested apparatus, equipment, fittings or services and so cannot verify they are in working order. The buyer is advised to obtain verification from their solicitor or surveyor.

O'Riordan Bond Grange Park Sales  
01604 432007

grangepark@oriordanbond.co.uk

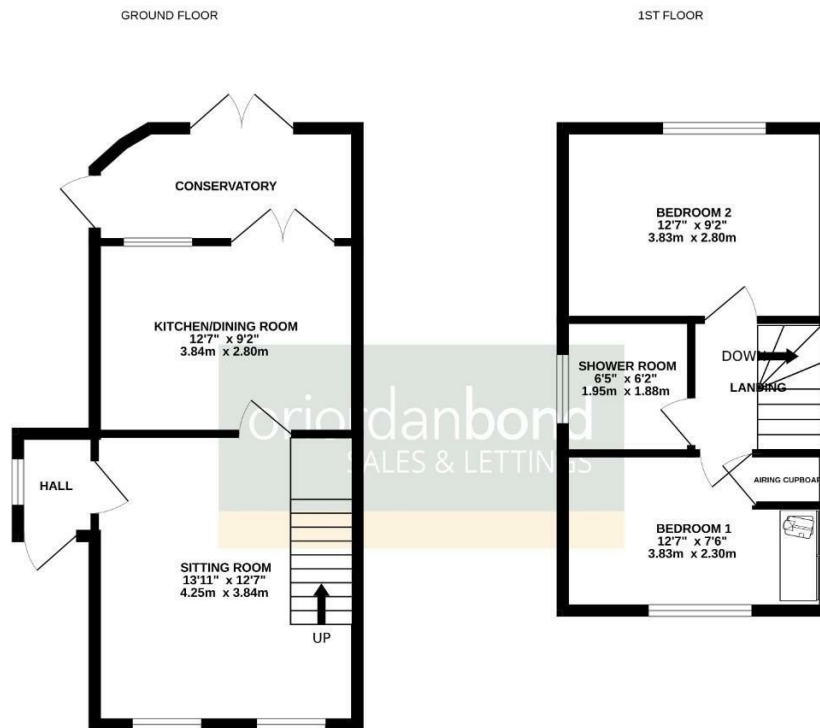

TOTAL FLOOR AREA : 593 sq ft. (55.1 sq.m.) approx.

Whilst every attempt has been made to ensure the accuracy of the floorplan contained here, measurements of doors, windows, rooms and any other items are approximate and no responsibility is taken for any error, omission or mis-statement. This plan is for illustrative purposes only and should be used as such by any prospective purchaser. The services, systems and appliances shown have not been tested and no guarantee as to their operability or efficiency can be given.

Made with Hectagor CSD25