



11 Brookes Mews

Earls Barton, Northamptonshire

oriordanbond
TOWN & COUNTRY



GROUND FLOOR
850 sq.ft. (79.0 sq.m.) approx.

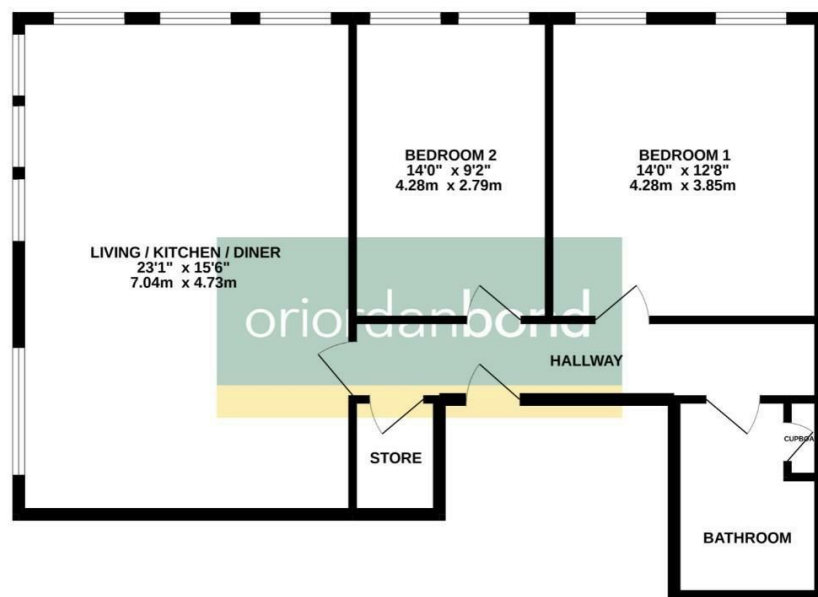

TOTAL FLOOR AREA : 850sq ft. (79.0 sq.m.) approx.
Whilst every attempt has been made to ensure the accuracy of the floorplan contained here, measurements of doors, windows, rooms and any other items are approximate and no responsibility is taken for any error, omission or mis-statement. This plan is for illustrative purposes only and should be used as such by any prospective purchaser. The services, systems and appliances shown have not been tested and no guarantee is given as to their operability or efficiency can be given.
Made with Metropix 63222

11 Brookes Mews

Earls Barton

NN6 0LD

PRICE £198,000

A spacious two double bedroom ground floor apartment situated within the heart of the thriving village of Earls Barton. Formerly part of a classic shoe factory that was also the original building behind the hit film 'Kinky Boots.' This stylish and modern apartment has recently been updated by the current owner.

Accommodation comprises secure communal entry, entrance hall with telecom entry system, open plan re-fitted kitchen/dining/living room, kitchen area with built-in appliances, large island with breakfast/dining bar, two bedrooms and three-piece re-fitted bathroom. Benefits include under floor heating, replacement uPVC windows, exposed brickwork throughout and two allocated parking spaces. (B/850/-)

LEASEHOLD INFORMATION - Lease Remaining - 99 years / Ground Rent - £125 pcm / Service Charge - Included in Ground Rent

Additional information

- Council Tax Band: C
- Energy Efficiency Rating: D

Viewing

Viewing strictly by appointment – details below

Disclaimer

O'Riordan Bond Estate Agents Limited has not tested apparatus, equipment, fittings or services and so cannot verify they are in working order. The buyer is advised to obtain verification from their solicitor or surveyor.

O'Riordan Bond Earls Barton Sales

01604 810088

earlsbarton@oriordanbond.co.uk