



Thompson Close

St Crispin, Northampton

oriordanbond
SALES & LETTINGS



Thompson Close

St Crispin
NN5 4UE

PRICE £315,000

GROUND FLOOR
607 sq.ft. (56.4 sq.m.) approx.

1ST FLOOR
599 sq.ft. (55.7 sq.m.) approx.

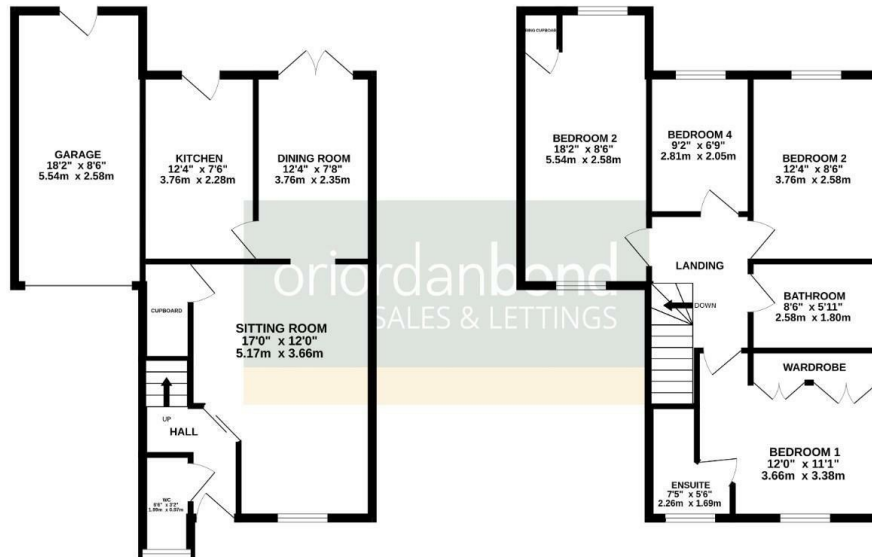

TOTAL FLOOR AREA: 1206 sq.ft. (112.1 sq.m.) approx.
Whilst every attempt has been made to ensure the accuracy of the floorplan contained here, measurements of doors, windows, rooms and any other items are approximate and no responsibility is taken for any error, omission or mis-statement. This plan is for illustrative purposes only and should be used as such by any prospective purchaser. The services, systems and appliances shown have not been tested and no guarantee is given as to their operability or efficiency can be given.
Made with Metreplex 02/02/25

Additional information

- Council Tax Band: D
- Energy Efficiency Rating: C

Viewing

Viewing strictly by appointment – details below

Disclaimer

O'Riordan Bond Estate Agents Limited has not tested apparatus, equipment, fittings or services and so cannot verify they are in working order. The buyer is advised to obtain verification from their solicitor or surveyor.

O'Riordan Bond Duston Sales
01604 589007

duston@oriordanbond.co.uk

