



# St Crispin Crescent

St Crispin, Northampton

oriordanbond  
SALES & LETTINGS





GROUND FLOOR  
431 sq.ft. (40.1 sq.m.) approx.

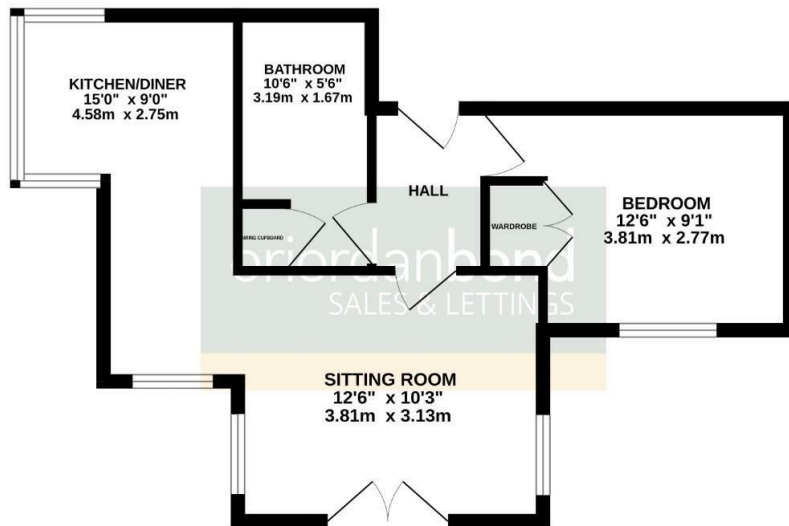

TOTAL FLOOR AREA : 431 sq.ft. (40.1 sq.m.) approx.  
Whilst every attempt has been made to ensure the accuracy of the floorplan contained here, measurements of doors, windows, rooms and any other items are approximate and no responsibility is taken for any error, omission or mis-statement. This plan is for illustrative purposes only and should be used as such by any prospective purchaser. The services, systems and appliances shown have not been tested and no guarantee as to their operability or efficiency can be given.  
Made with Metagen C2025

## St Crispin Crescent

St Crispin  
NN5 6GD

OFFERS OVER £115,000

Offered to the market with no onward chain and making an ideal purchase for first time buyers and buy-to-let investors is this one bedroom apartment. Located within the desirable area of St Crispin, the property is set on the first floor in the block.

Accommodation comprises entrance hall, sitting room with Juliette balcony, kitchen/dining room, family bathroom and a double size bedroom with fitted wardrobes. The property also benefits from gas radiator heating, uPVC double glazing, secure intercom entry system and one allocated parking space (B/431/-)

Leasehold Information: Remaining Lease - 105 years (as of 2025) / Service Charge - £740 every six months / Ground Rent - £225 per annum

### Additional information

- Council Tax Band: B
- Energy Efficiency Rating: C

### Viewing

Viewing strictly by appointment – details below

### Disclaimer

O'Riordan Bond Estate Agents Limited has not tested apparatus, equipment, fittings or services and so cannot verify they are in working order. The buyer is advised to obtain verification from their solicitor or surveyor.

O'Riordan Bond Duston Sales  
01604 589007

duston@oriordanbond.co.uk

