



Chatsworth Avenue

Goldenash, Northampton

oriordanbond
SALES & LETTINGS



Chatsworth Avenue

Goldenash
NN3 8JD

Guide Price
£270,000

An immaculate three bedroom semi-detached property, situated in the popular area of Goldenash, within a cul-de-sac location. The property provides good access to local schools and amenities as well as Weston Favell Shopping Centre.

The accommodation comprises porch, large sitting room and a re-fitted kitchen/dining room open to the conservatory. To the first floor are three bedrooms and a re-fitted family bathroom. Outside is a low maintenance rear garden with newly paved patio and side access. To the front is off road parking for two cars leading to a single garage with newly installed electronic door. Further benefits include uPVC double glazing and gas radiator heating. (A/967/S)

- Immaculate three bedroom semi-detached
- Re-fitted kitchen/dining room
- Re-fitted bathroom
- Gas radiator heating
- Enclosed rear garden
- Driveway and garage with electric door





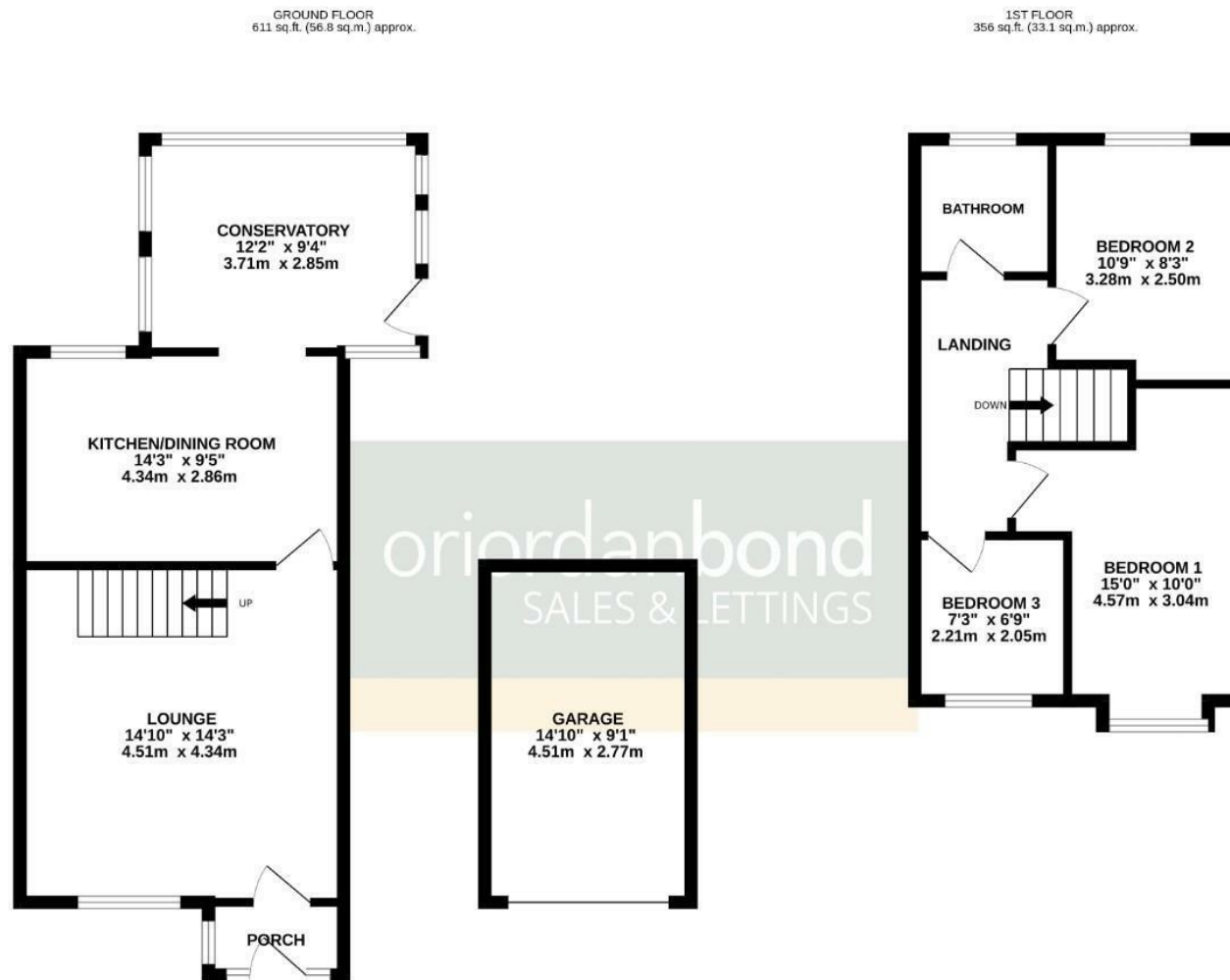

TOTAL FLOOR AREA : 967 sq.ft. (89.9 sq.m.) approx.

Whilst every attempt has been made to ensure the accuracy of the floorplan contained here, measurements of doors, windows, rooms and any other items are approximate and no responsibility is taken for any error, omission or mis-statement. This plan is for illustrative purposes only and should be used as such by any prospective purchaser. The services, systems and appliances shown have not been tested and no guarantee as to their operability or efficiency can be given.
Made with Metropix ©2025



Additional information

- Council Tax Band: B
- Energy Efficiency Rating: E

Viewing

Viewing strictly by appointment – details below

Disclaimer

O'Riordan Bond Estate Agents Limited has not tested apparatus, equipment, fittings or services and so cannot verify they are in working order. The buyer is advised to obtain verification from their solicitor or surveyor.

O'Riordan Bond Weston Favell Sales

01604 784007

westonfavell@oriordanbond.co.uk

