



# Newby Court

Eastfield, Northampton

oriordanbond  
SALES & LETTINGS





GROUND FLOOR  
473 sq.ft. (43.9 sq.m.) approx.

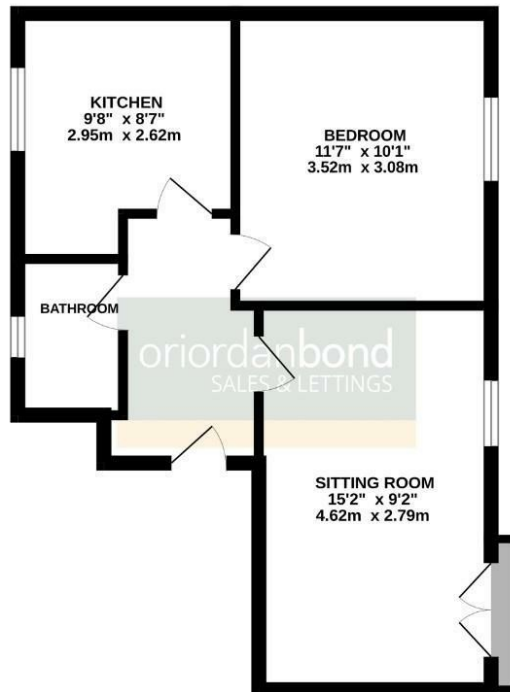

TOTAL FLOOR AREA: 473 sq.ft. (43.9 sq.m.) approx.  
Whilst every attempt has been made to ensure the accuracy of the floorplan contained herein, measurements of doors, windows, rooms and any other items are approximate and no responsibility is taken for any error, omission or misstatement. This plan is for illustrative purposes only and should be used as such by any prospective purchaser. The services, systems and appliances shown have not been tested and no guarantee as to their operability or efficiency can be given.  
Made with floorplan.co.uk

## Newby Court

Eastfield

NN3 2AP

PRICE £110,000

**A first floor one double bedroom apartment, set within the popular area of Eastfield, with good access to local shops and amenities and offered for sale with no onward chain.**

The accommodation comprises entrance hall, sitting room with access to a balcony overlooking Eastfield Park, fitted kitchen, double bedroom and a three-piece bathroom suite. Benefits include uPVC double glazing and a brick shed. (B/473/balc)

Leasehold Information: Lease Remaning - 110 years (as of 2026) / Ground Rent and Service Charge - £52 per month

### Additional information

- Council Tax Band: A
- Energy Efficiency Rating:

### Viewing

Viewing strictly by appointment – details below

### Disclaimer

O'Riordan Bond Estate Agents Limited has not tested apparatus, equipment, fittings or services and so cannot verify they are in working order. The buyer is advised to obtain verification from their solicitor or surveyor.

**O'Riordan Bond Abington East Sales**  
**01604 639007**

abingtoneast@oriordanbond.co.uk

