

RAILWAY HOUSE  
2 REMPSTONE ROAD  
SWANAGE  
DORSET  
BH19 1DW  
*Opposite the Steam Railway Station*



Tel: 01929 423333  
(24 hours)  
Web: [www.milesandson.co.uk](http://www.milesandson.co.uk)  
Email: [property@milesandson.co.uk](mailto:property@milesandson.co.uk)



## **Priests Way, Swanage, Dorset BH19 2RS**

Detached holiday lodge offers a retreat for those seeking a tranquil escape. approximately a mile from Swanage town centre.

This property serves as an ideal gateway to the Jurassic Coast, a UNESCO World Heritage Site renowned for its dramatic cliffs and rich geological history. The lodge boasts picturesque sea and hill views.

Inside, the accommodation features two well-appointed ensuite bedrooms, each complemented by dressing rooms, ensuring ample space and comfort for guests or family members. The thoughtful design and layout of the lodge create a warm and inviting atmosphere, perfect for unwinding after a day of exploring the beautiful surroundings.

Whether you are looking for a holiday home or a peaceful getaway, this park home in Swanage presents an exceptional opportunity to embrace coastal living in a stunning location. Don't miss the chance to make this charming lodge your own and experience the best of what this picturesque area has to offer.

**Asking Price £165,000**

Priests Way, Swanage, Dorset BH19 2RS





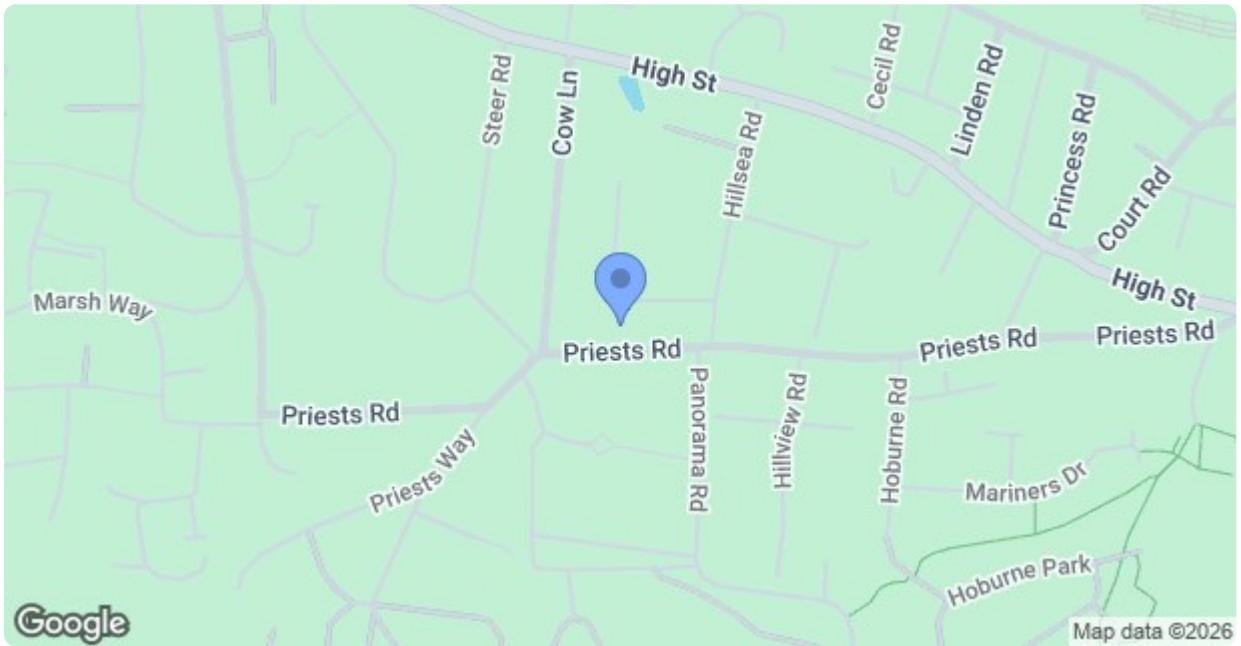
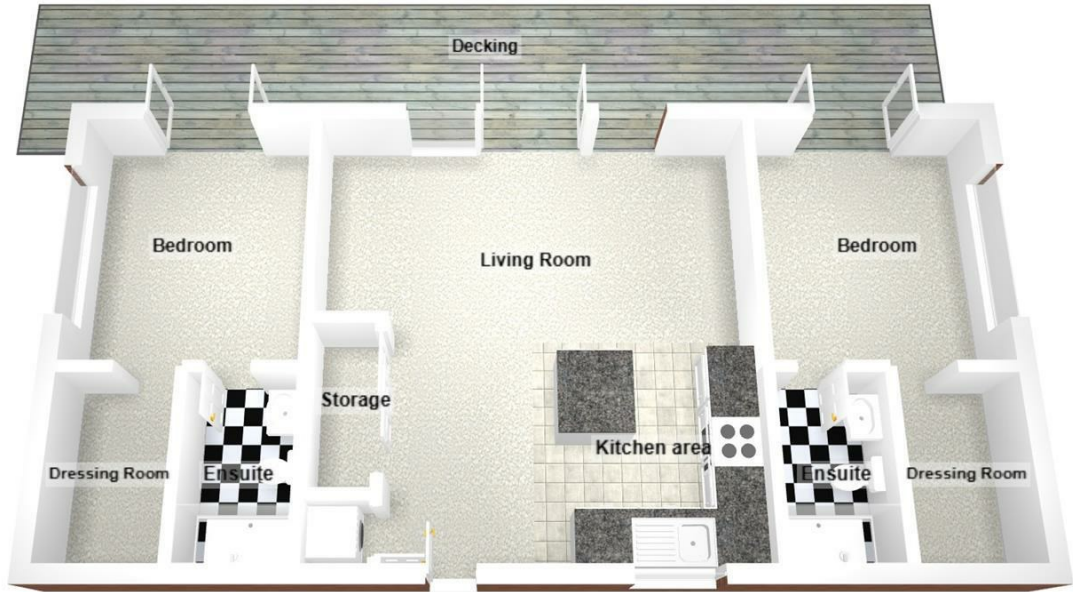

Energy Efficiency Rating		
	Current	Potential
<i>Very energy efficient - lower running costs</i>		
(92 plus) <b>A</b>		
(81-91) <b>B</b>		
(69-80) <b>C</b>		
(55-68) <b>D</b>		
(39-54) <b>E</b>		
(21-38) <b>F</b>		
(1-20) <b>G</b>		
<i>Not energy efficient - higher running costs</i>		
<b>England &amp; Wales</b>	EU Directive 2002/91/EC	