



The Ridings

Paddock Wood TN12 6YA

Guide Price £175,000



COUNTRY HOMES

Paddock Wood TN12 6YA

One bedroom, ground floor apartment with allocated parking space located close to Paddock Wood train station.

KHP Country Homes are pleased to present this one bedroom ground floor flat in a popular location within Paddock Wood. Accommodation comprises kitchen, bathroom, one double bedroom and living room. The property offers communal gardens to the rear and an off-road parking space.

Paddock Wood offers a wide variety of shopping facilities including a large Waitrose, Tesco & Jempson store with Post Office. Further stores include a bakers, opticians, dry cleaners plus a variety of coffee shops and a Department store. For those that require transport links into the Capital, there is a mainline station to London Charing Cross, Waterloo East & London Bridge. Paddock Wood also offers both Primary and Secondary schools. The larger towns of Tonbridge and Tunbridge Wells offer further shopping and leisure facilities.

Early viewing is highly recommended.

- SOLD BY KHP COUNTRY HOMES
- Kitchen
- Living room
- Family bathroom
- Parking space
- Local amenities close by
- Great transport links
- Paddock Wood Mainline Station within walking distance
- Early viewing highly encouraged
- END OF CHAIN



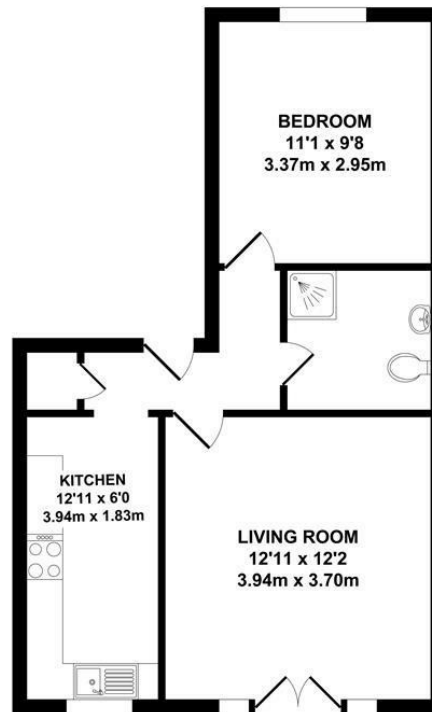

TOTAL APPROX. FLOOR AREA 440 SQ.FT. (40.86 SQ.M.)

Whilst every attempt has been made to ensure the accuracy of the floor plan contained here, measurements of doors, windows, rooms and any other items are approximate and no responsibility is taken for any error, omission or mis-statement. This plan is for illustrative purposes only and should be used as such by any prospective purchaser. The services, systems and appliances shown have not been tested and no guarantee as to their operability or efficiency can be given.

Zome Media ©2024

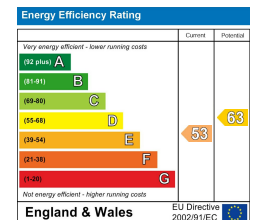

6 Commercial Road, Paddock Wood, Kent, TN12 6EL
 01892 838 080
 countryhomes@khp.me



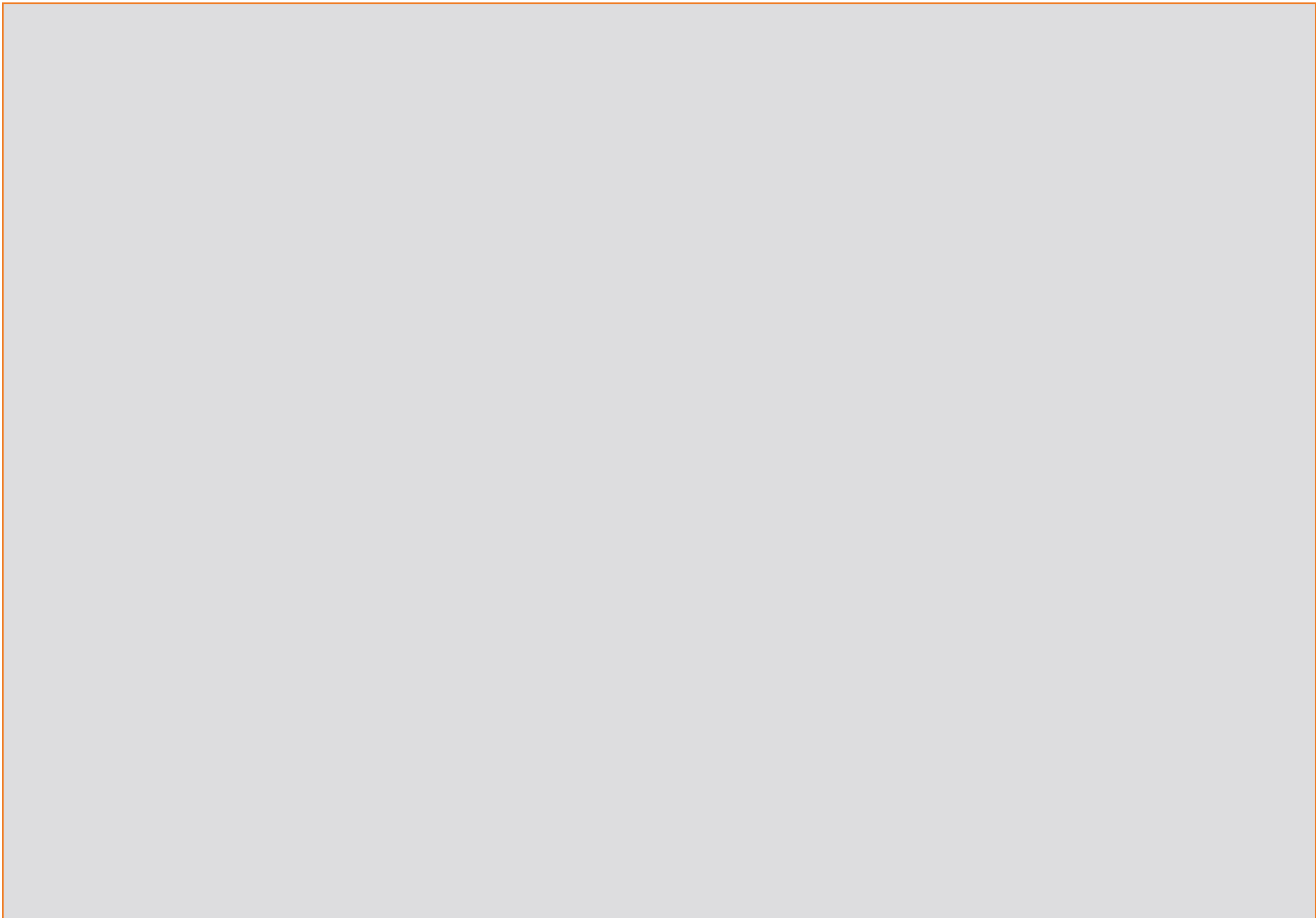

Location Map

Tenure: Leasehold

Council tax band: C

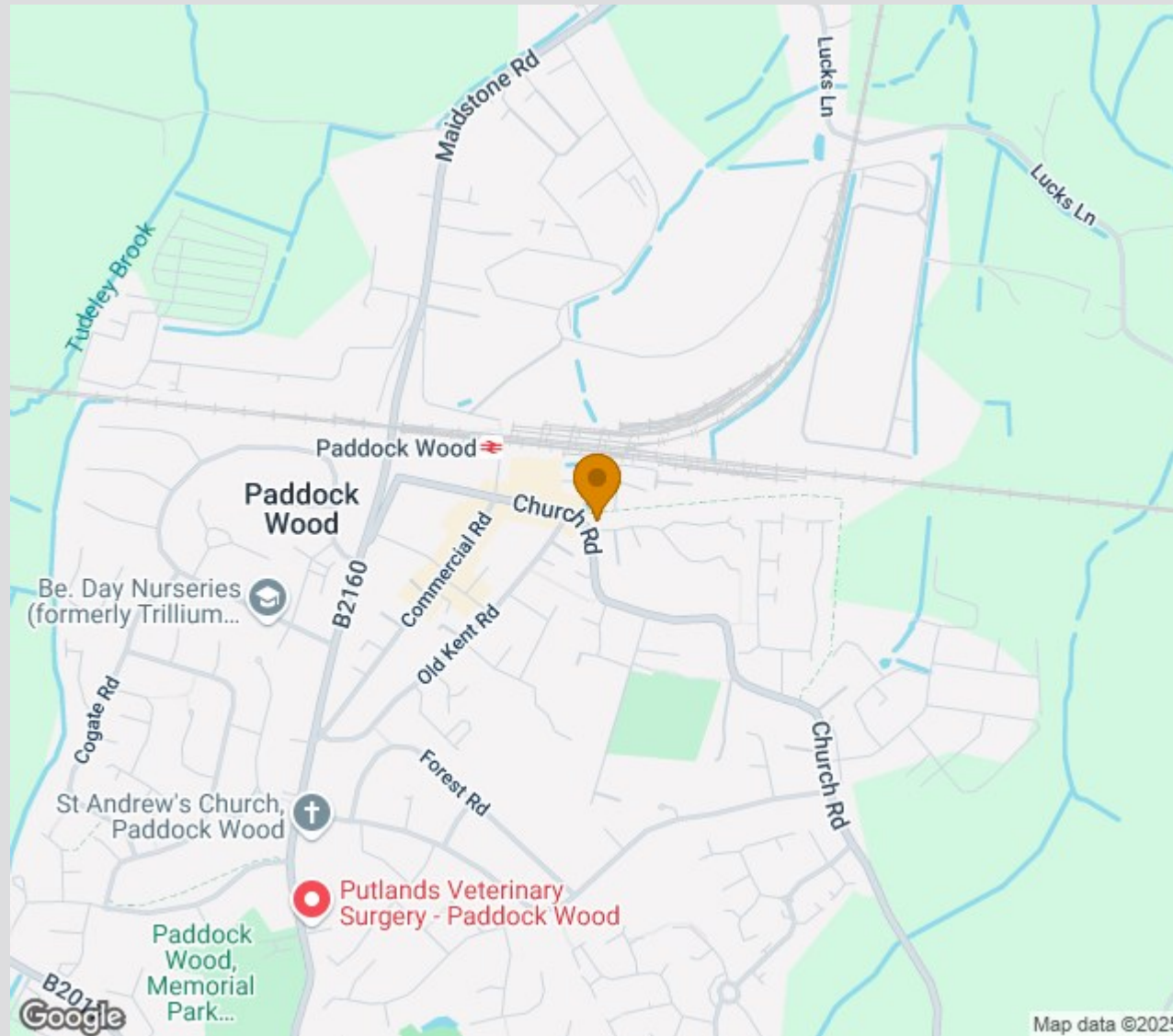

Zoopla.co.uk
Smarter property search



TO VIEW CONTACT:

01892 838 080

countryhomes@khp.me

www.khp.me

