



# The Ridings

Paddock Wood TN12 6YB

Offers Over £180,000



COUNTRY HOMES

Paddock Wood TN12 6YB

## STUNNING GROUND FLOOR APARTMENT

Set on the ground floor of this small apartment block is this well presented one double bedroom property. An ideal first time purchase or investment property!

As you can see from the pictures the apartment has been modernised through out. Is ideal for those buyers who just want to move in.

Ideally situated in this quiet location close to local amenities and the mainline station. Call now to view.

- Popular Location
- Ground Floor Flat
- Close to Shops & Mainline Station
- Modern Kitchen & Bathroom
- One Double Bedroom
- Parking Space
- Entry phone
- Chain free



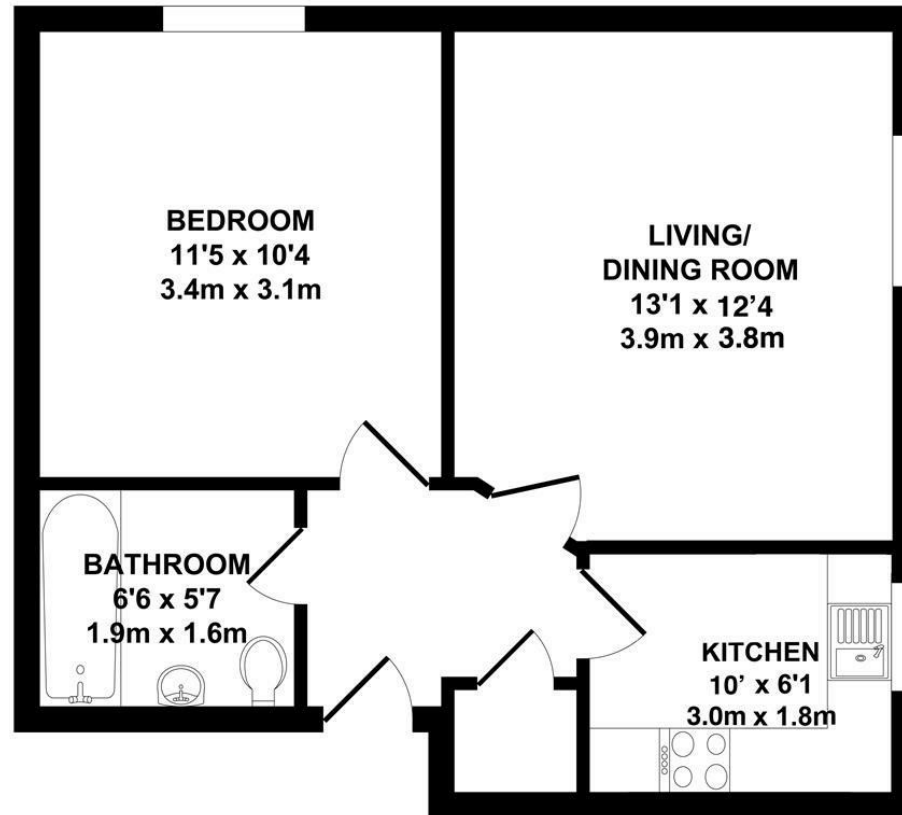

**TOTAL APPROX. FLOOR AREA 495 SQ.FT. (46.00 SQ.M.)**

Whilst every attempt has been made to ensure the accuracy of the floor plan contained here, measurements of doors, windows, rooms and any other items are approximate and no responsibility is taken for any error, omission or misstatement. This plan is for illustrative purposes only and should be used as such by any prospective purchaser. The services, systems and appliances shown have not been tested and no guarantee as to their operability or efficiency can be given.

Zome Media ©2020

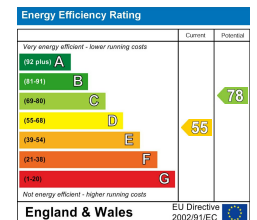



Country

---

Homes

## Location Map

Tenure: Leasehold

Council tax band: C

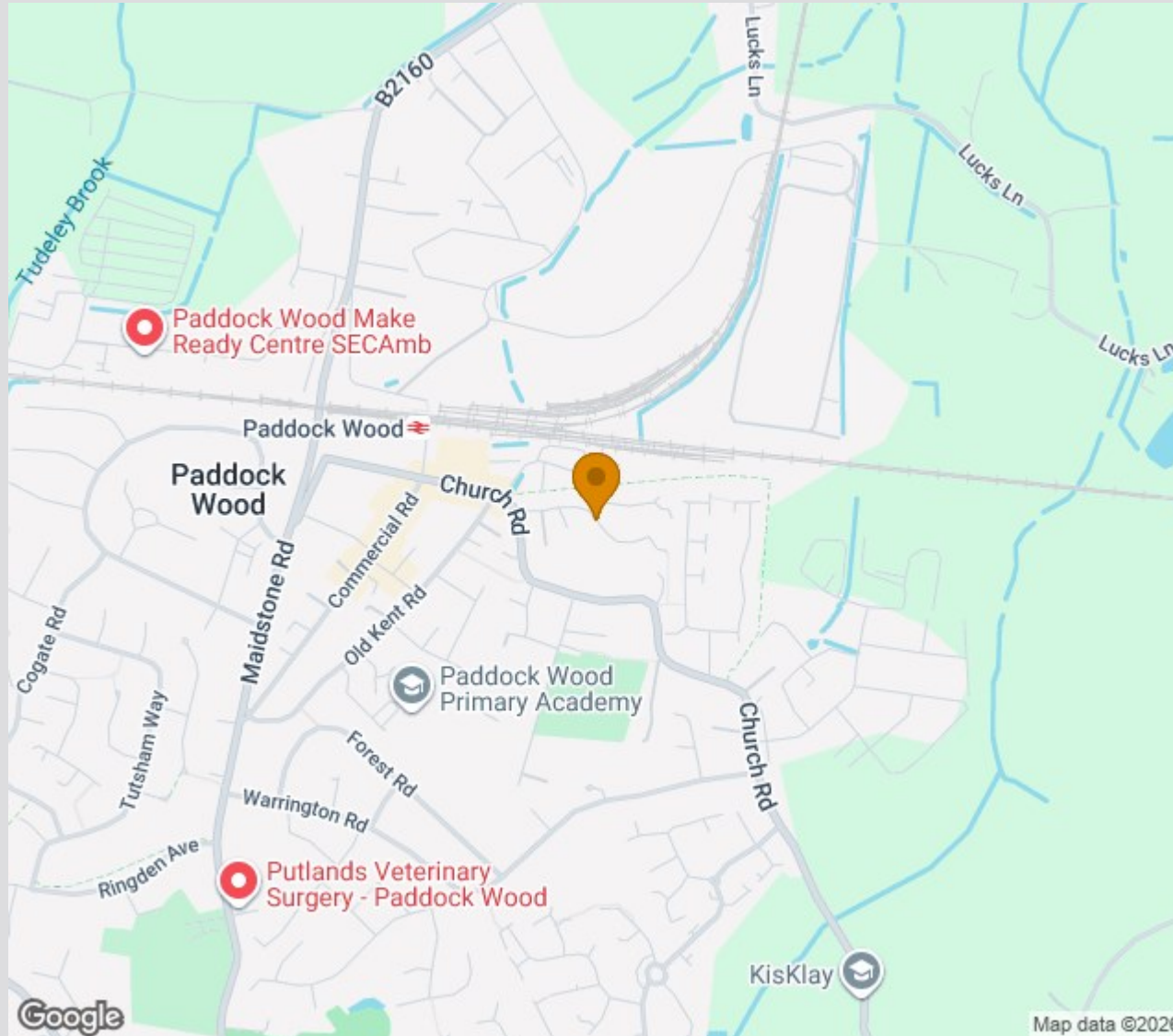

TO VIEW CONTACT:

01892 838 080

countryhomes@khp.me

www.khp.me

