



Gatcombe Close

Maidstone ME16 0EF

Price £375,000



COUNTRY HOMES

Maidstone ME16 0EF

Welcome to this charming property located in the lovely area of Allington. This 3-bedroom house offers a wonderful living space for you and your family.

As you step inside, you are greeted by a downstairs WC and an open plan lounge/diner that provides ample space for entertaining guests or simply relaxing. The property boasts three bedrooms, and a bathroom. Perfect for a growing family, as well as a kitchen leading onto the well maintained garden.

Situated in a peaceful cul-de-sac, this home offers a tranquil environment, perfect for unwinding after a long day. It has a separate garage, with parking available for 2 vehicles in front of it.

The property's proximity to well respected primary schools makes it an ideal choice for families with young children, ensuring a stress-free school run each day.

Overall, this well-presented property in Gatcombe Close, Allington, is a fantastic opportunity for anyone looking for a comfortable and convenient place to call home. Don't miss out on the chance to make this lovely house your own! Call now to arrange your viewing.

- Close to schools
- Close to Maidstone Hospital
- Play park



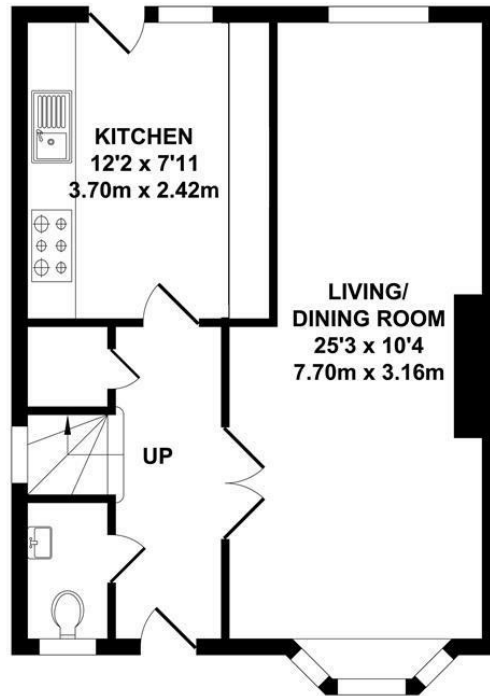

GROUND FLOOR
APPROX. FLOOR AREA
479 SQ.FT.
(44.48 SQ.M.)

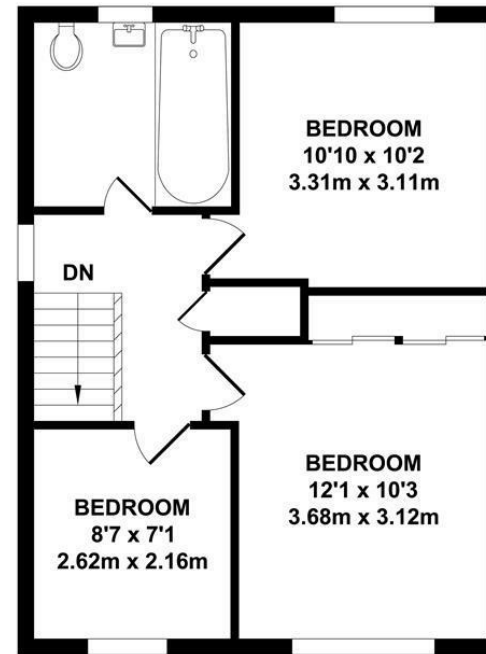

FIRST FLOOR
APPROX. FLOOR AREA
471 SQ.FT.
(43.74 SQ.M.)

TOTAL APPROX. FLOOR AREA 950 SQ.FT. (88.22 SQ.M.)

Whilst every attempt has been made to ensure the accuracy of the floor plan contained here, measurements of doors, windows, rooms and any other items are approximate and no responsibility is taken for any error, omission or mis-statement. This plan is for illustrative purposes only and should be used as such by any prospective purchaser. The services, systems and appliances shown have not been tested and no guarantee as to their operability or efficiency can be given.

Zome Media ©2025

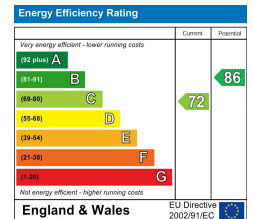





Location Map

Tenure: Freehold

Council tax band: D

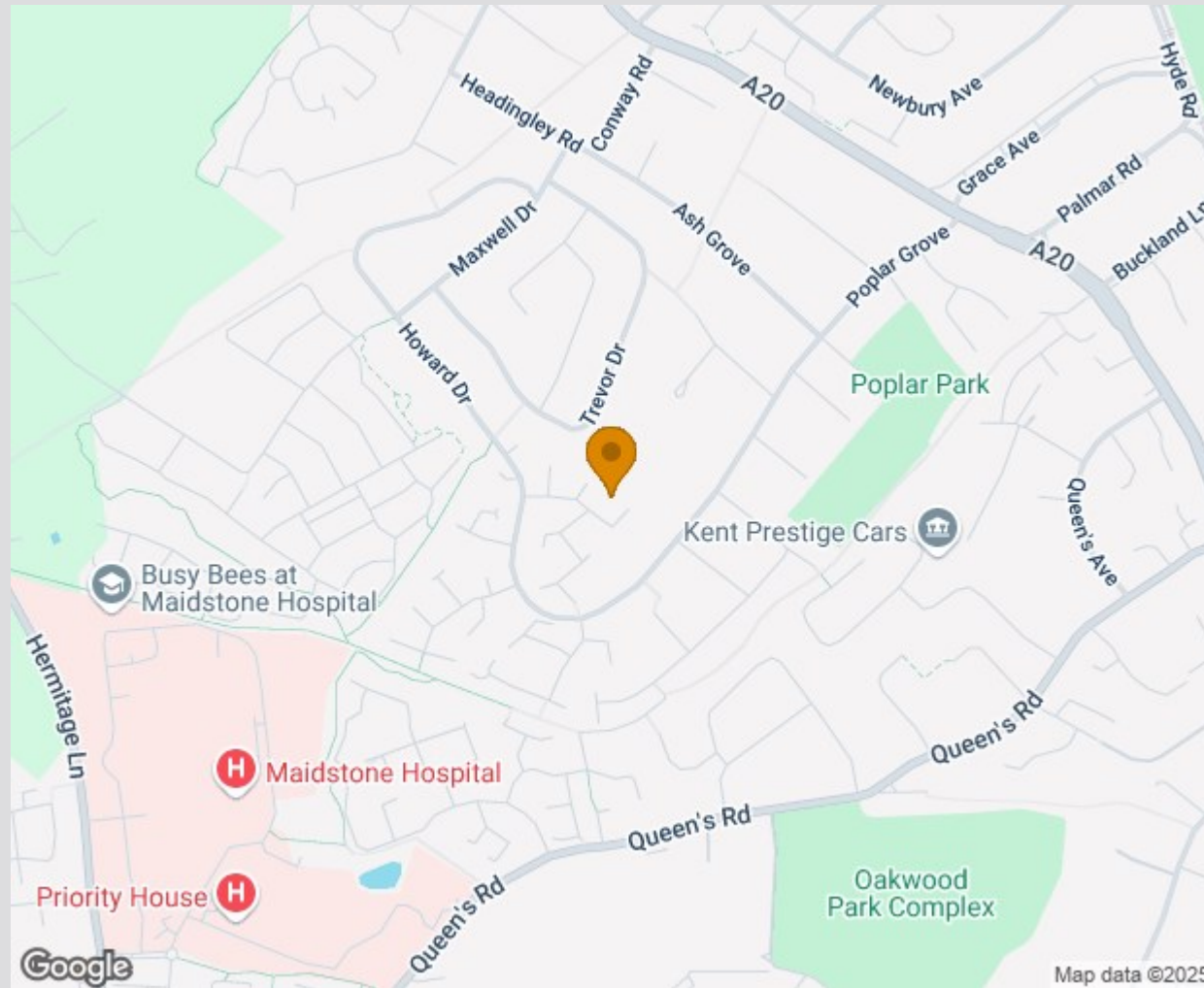

TO VIEW CONTACT: 01622 94 22 22 allington@khp.me
www.khp.me



Zoopla.co.uk
Smarter property search

