



Whatman Drive

Maidstone ME14 5FZ

£320,000



COUNTRY HOMES

Maidstone ME14 5FZ

We are excited to introduce our new listing in Vinters Park, Maidstone.

This modern home comes with three bedrooms, over three floors.

Downstairs there's an open-plan kitchen/living/dining room with French doors to the patio garden.

On the first floor you'll find two bedrooms and the family bathroom. Your main bedroom with dressing area can be found on the top floor.

This "ready to move straight into" home, has a garage for a single car, visitor parking bays and on road parking.

Perfect location for everything, close by to Mote park, shopping amenities like M&S and next, as well as Maidstone town centre, local primary and secondary schools and close to the M20 Junction 7.

Call now to arrange a viewing!

- Close to schools
- Close to shops
- M20 junction 7



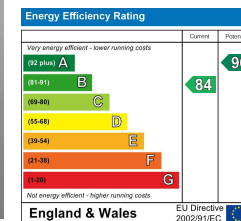
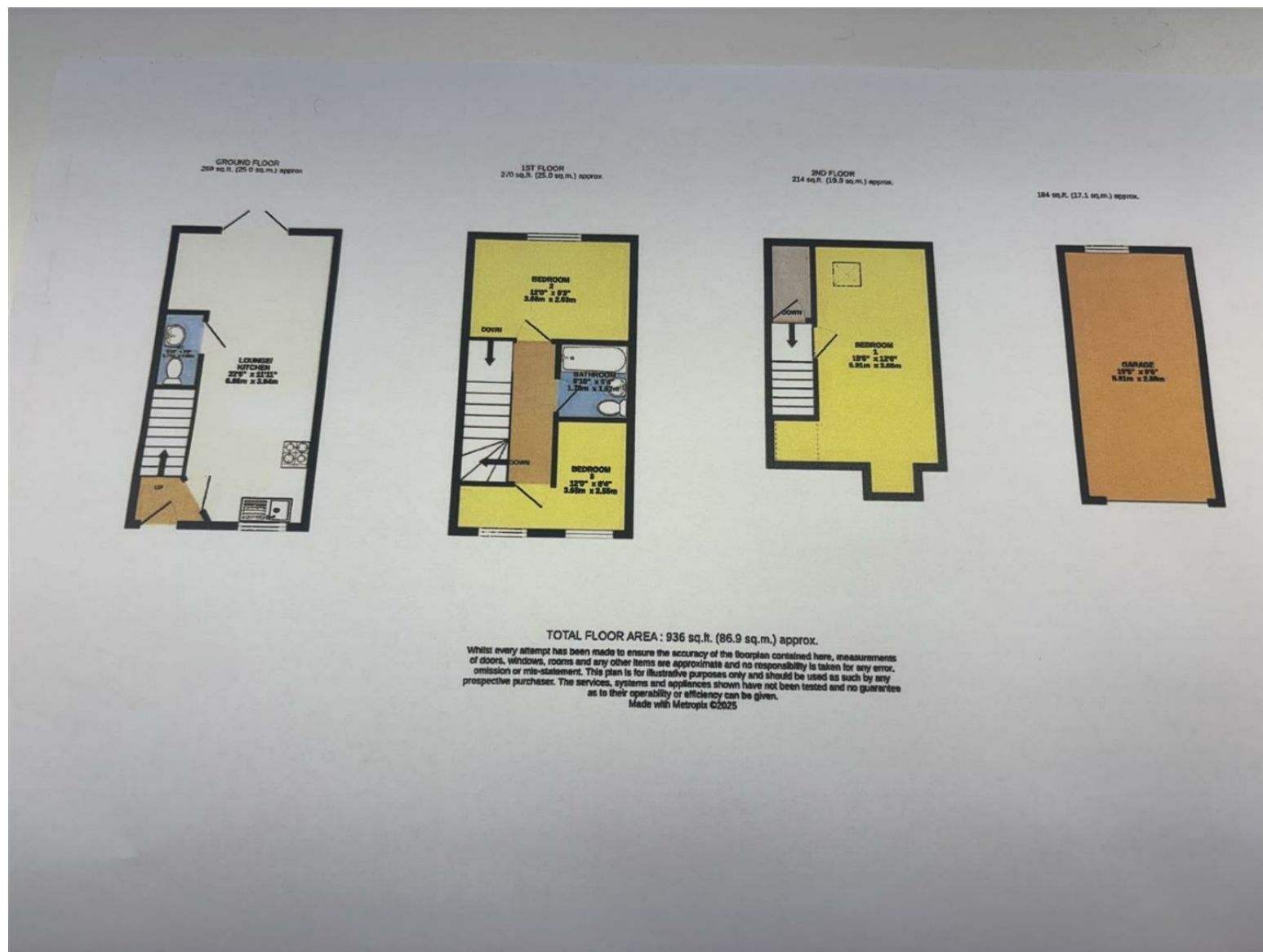

Unit 2 Mid Kent Shopping Centre, Allington, Kent ME16 0PR
01622 94 22 22
allington@khp.me





Location Map

Tenure: Freehold

Council tax band: D

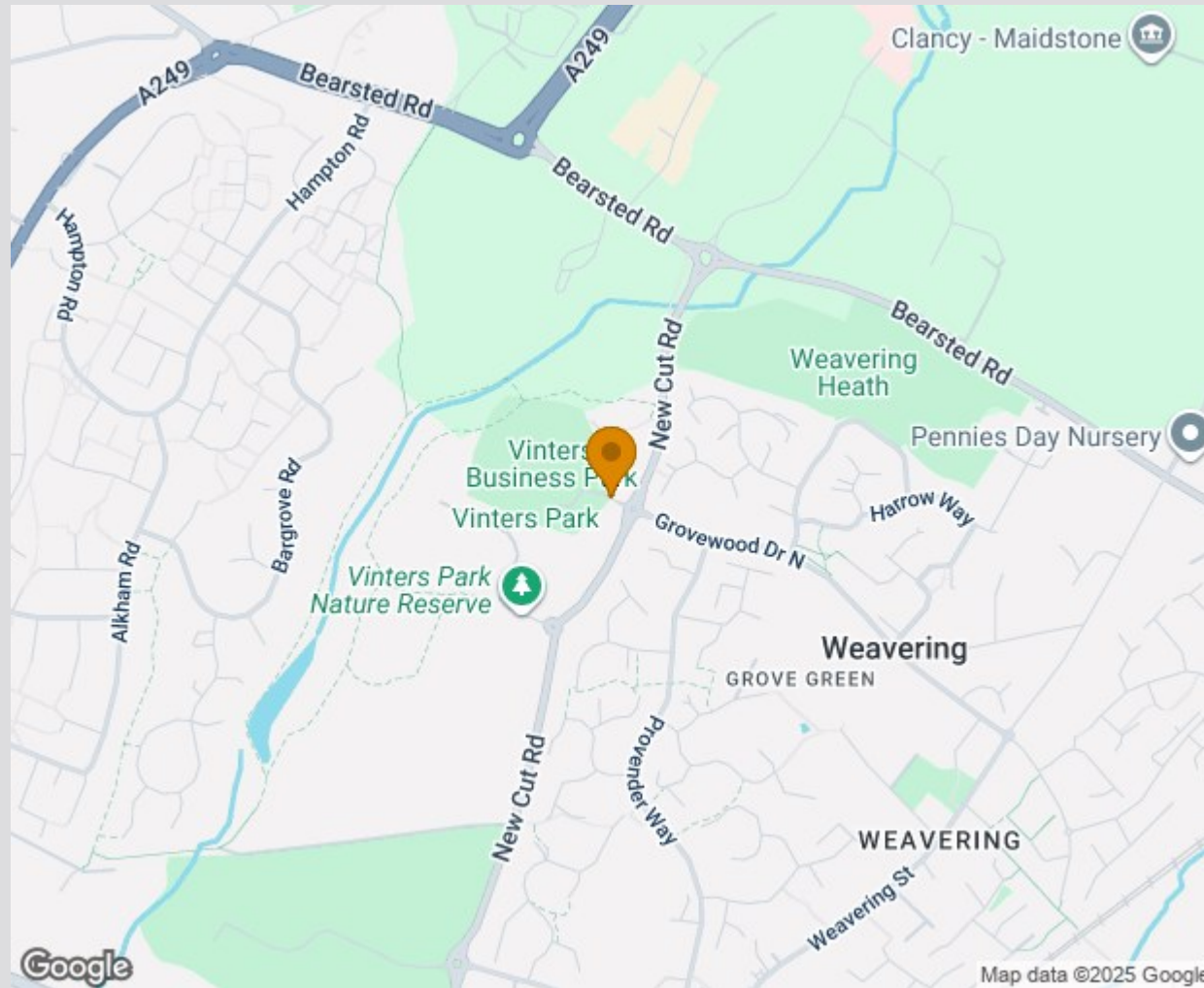

TO VIEW CONTACT: 01622 94 22 22 allington@khp.me

www.khp.me



Zoopla.co.uk
Smarter property search

