



The Links

Addington ME19 5RX

O.I.R.O £800,000



COUNTRY HOMES

Addington ME19 5RX

NO CHAIN

Nestled in the desirable area of The Links, Addington, this impressive detached house offers a perfect blend of comfort and convenience. Spanning an expansive floorspace the property boasts five well-proportioned bedrooms, making it an ideal family home. The master bedroom features an ensuite bathroom, providing a private sanctuary for relaxation.

The house is designed for modern living, with three reception rooms that offer versatile spaces for entertaining guests or enjoying quiet family time. The layout is both practical and inviting, ensuring that every corner of the home is utilised to its fullest potential.

This property is situated in a popular close, adjacent to a picturesque golf course, which adds to the charm of the location. The surrounding area is not only tranquil but also conveniently located, providing easy access to local amenities and transport links.

Additionally, the property includes a garage and a driveway, offering ample parking space and storage solutions. This home is perfect for those seeking a peaceful yet accessible lifestyle in a sought-after neighbourhood. With its generous living space and prime location, this detached house is a wonderful opportunity for anyone looking to settle in Addington. With the potential to put your own mark on it, call now to view your future home.

- Detached
- 5 bedrooms
- Ensuite to master
- In a Close
- Development next to golf course
- Convenient location
- Good size
- Garage and driveway
- Flexible living space
- Viewing encouraged



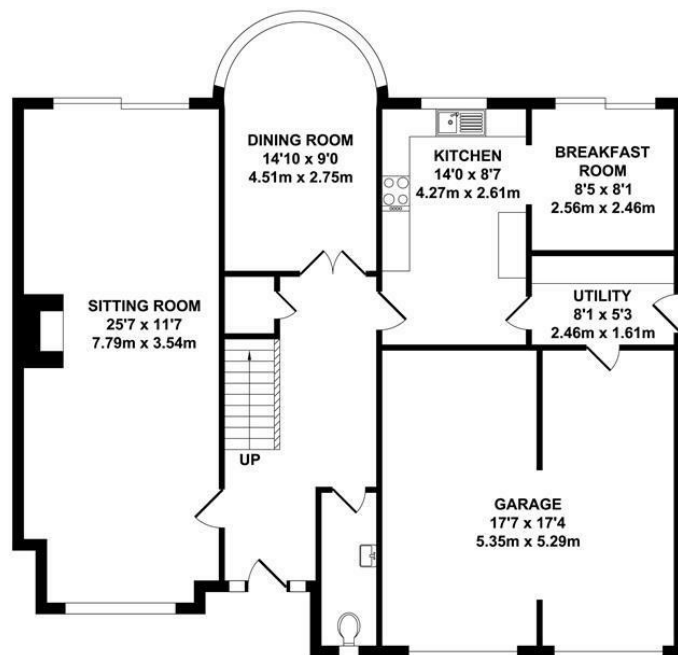

GROUND FLOOR
APPROX. FLOOR AREA
1210 SQ.FT.
(112.44 SQ.M.)

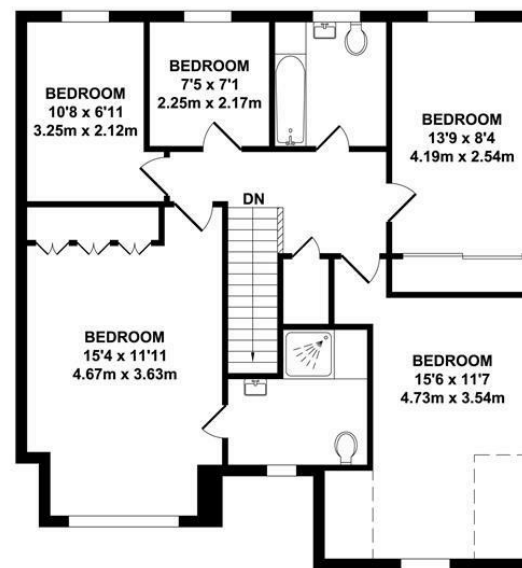

FIRST FLOOR
APPROX. FLOOR AREA
884 SQ.FT.
(82.14 SQ.M.)

TOTAL APPROX. FLOOR AREA 2094 SQ.FT. (194.58 SQ.M.)

Whilst every attempt has been made to ensure the accuracy of the floor plan contained here, measurements of doors, windows, rooms and any other items are approximate and no responsibility is taken for any error, omission or mis-statement. This plan is for illustrative purposes only and should be used as such by any prospective purchaser. The services, systems and appliances shown have not been tested and no guarantee as to their operability or efficiency can be given.

Zome Media ©2025

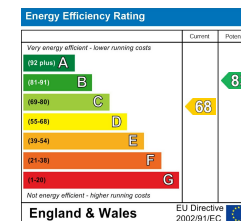





Location Map

Tenure: Freehold

Council tax band: G

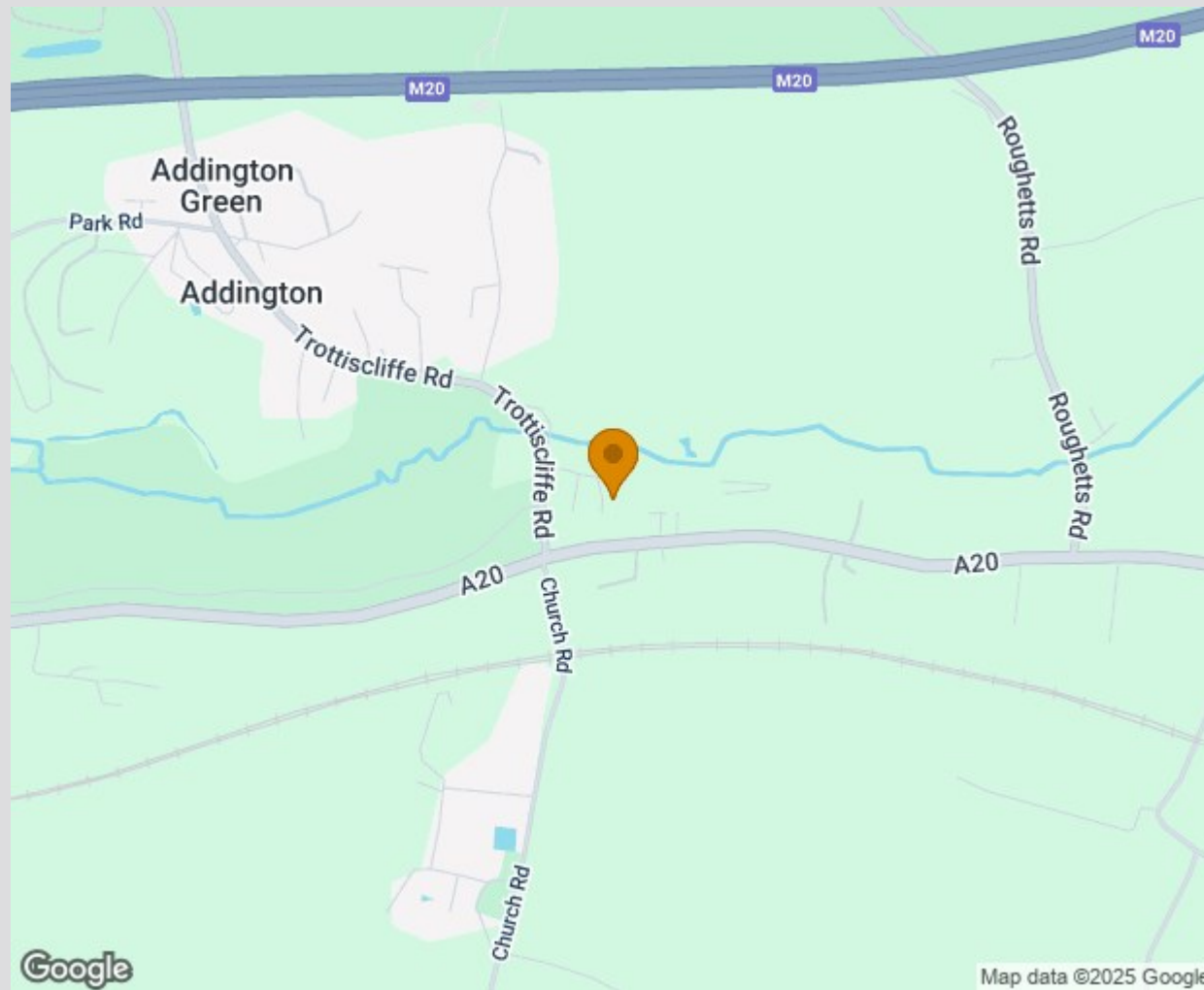

TO VIEW CONTACT: 01732 87 11 11 westmallings@khp.me

www.khp.me



Zoopla.co.uk
Smarter property search

