



Willow Wents

Mereworth ME18 5NF

£485,000



COUNTRY HOMES

Mereworth ME18 5NF

Nestled in the charming semi-rural area of Willow Wents, Mereworth, this delightful three-bedroom semi-detached house offers a perfect blend of modern living and tranquil surroundings. The property boasts a spacious reception room, ideal for both relaxation and entertaining guests.

The heart of the home is undoubtedly the modern kitchen, which is well-equipped and designed to meet the needs of contemporary family life. With ample storage and workspace, it is a delightful space for culinary enthusiasts.

The three well-proportioned bedrooms provide comfortable accommodation, making this home suitable for families or those seeking extra space. The property also features two bathrooms, ensuring convenience for all residents.

Outside, you will find allocated parking for two vehicles, a valuable asset in this serene location. The semi-rural setting offers a peaceful lifestyle while still being within easy reach of local amenities and transport links.

This property presents an excellent opportunity for those looking to enjoy the benefits of a modern home in a picturesque environment. Whether you are a first-time buyer or seeking a family residence, this semi-detached house in Mereworth is certainly worth considering.



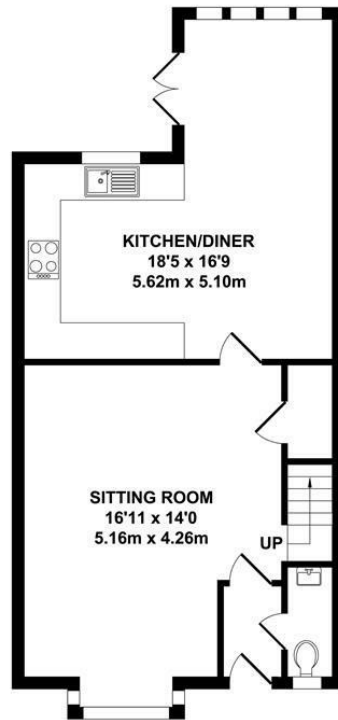

GROUND FLOOR
APPROX. FLOOR AREA
537 SQ.FT.
(49.92 SQ.M.)

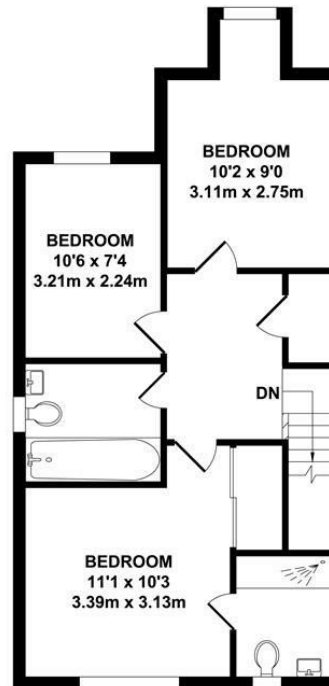

FIRST FLOOR
APPROX. FLOOR AREA
518 SQ.FT.
(48.12 SQ.M.)

TOTAL APPROX. FLOOR AREA 1055 SQ.FT. (98.04 SQ.M.)

Whilst every attempt has been made to ensure the accuracy of the floor plan contained here, measurements of doors, windows, rooms and any other items are approximate and no responsibility is taken for any error, omission or mis-statement. This plan is for illustrative purposes only and should be used as such by any prospective purchaser. The services, systems and appliances shown have not been tested and no guarantee as to their operability or efficiency can be given.

Zome Media ©2025

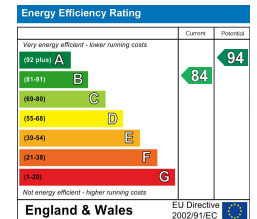





Location Map

Tenure: Freehold

Council tax band: E

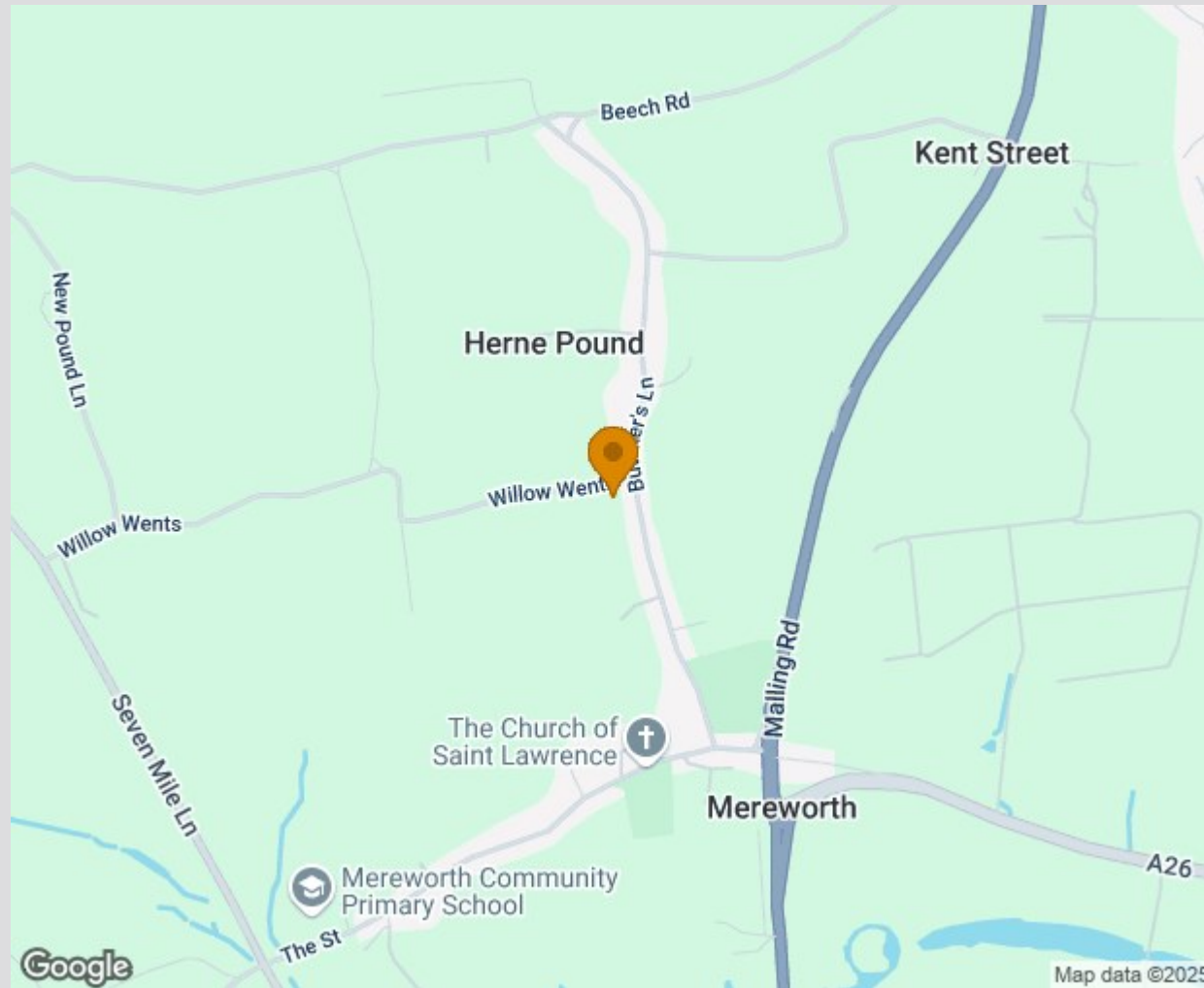

TO VIEW CONTACT: 01732 87 11 11 westmallings@khp.me

www.khp.me



Zoopla.co.uk
Smarter property search

