

[www.jeffreygross.co.uk](http://www.jeffreygross.co.uk)

CARDIFF

VALE

CAERPHILLY

BRISTOL



*Bute Terrace*

CITY CENTRE

54 Meridian Plaza, Bute Terrace, Cardiff, CF10

APPROX. GROSS INTERNAL FLOOR AREA 322 SQ FT 29.9 SQ METRES



Comments by Ms Francesca Vigliotti

Property Specialist  
Ms Francesca Vigliotti

francesca@jeffreycross.co.uk

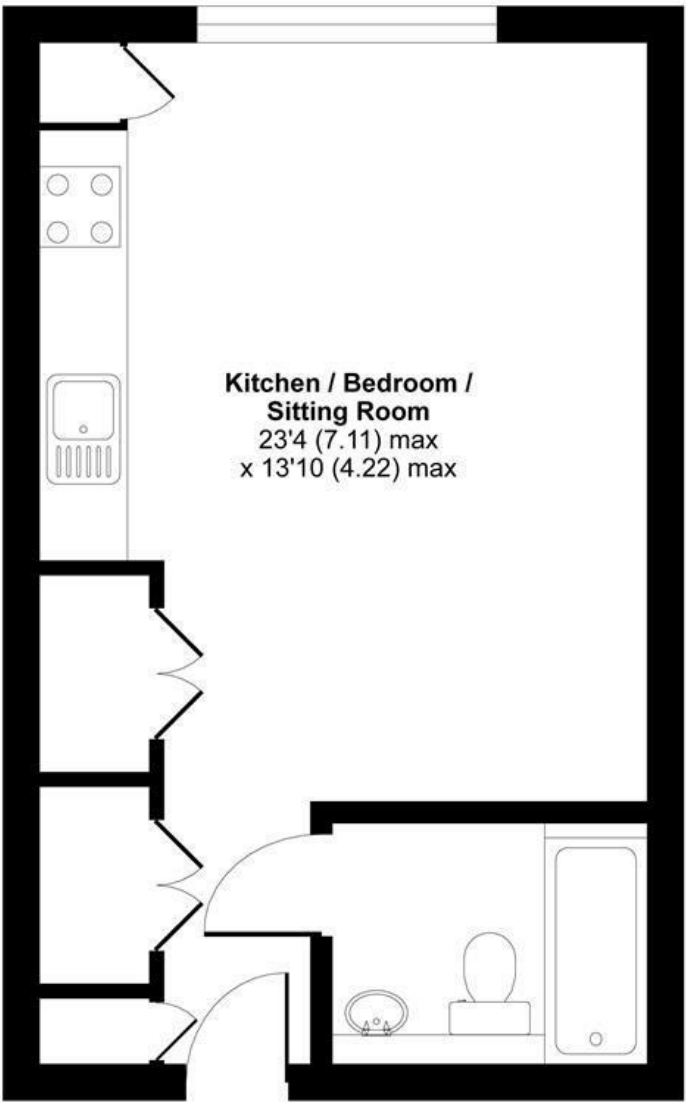

FIFTH FLOOR

Whilst every attempt has been made to ensure the accuracy of the floor plan contained here, measurements of doors, windows and rooms are approximate and no responsibility is taken for any error, omission or misstatement. These plans are for representation purposes only as defined by RICS Code of Measuring Practice and should be used as such by any prospective purchaser. Specifically no guarantee is given on the total square footage of the property if quoted on this plan. Any figure given is for initial guidance only and should not be relied on as a basis of valuation.



Comments by the Homeowner



# Bute Terrace

City Centre, Cardiff, CF10 2FP

PCM

£1,150 PCM



1 Bedroom(s)



1 Bathroom(s)



sq ft



Contact our  
**Penylan Branch**  
02920 499680

A modern furnished studio apartment in the heart of the City Centre in the popular development Meridian Plaza. The apartment briefly comprises of a lounge, that doubles up as a bedroom with fitted wardrobes, a modern fully fitted kitchen including a dishwasher, bathroom with a shower and underfloor heating. There are no bills included in the rent. There are no bills  
Seventh Floor furnished 1 bed flat comprising 1 double bedroom, lounge/kitchen & bathroom.24hr Concierge.





CARDIFF

VALE

CAERPHILLY

BRISTOL

[www.jeffreygross.co.uk](http://www.jeffreygross.co.uk)



