



www.jeffreygross.co.uk

CARDIFF

VALE

CAERPHILLY

BRISTOL

Broadway

ADAMSDOWN



Comments by Mr Rhys Carter



Property Specialist

Mr Rhys Carter

Senior valuer

rhys.carter@jeffreygross.co.uk

Broadway, Adamsdown

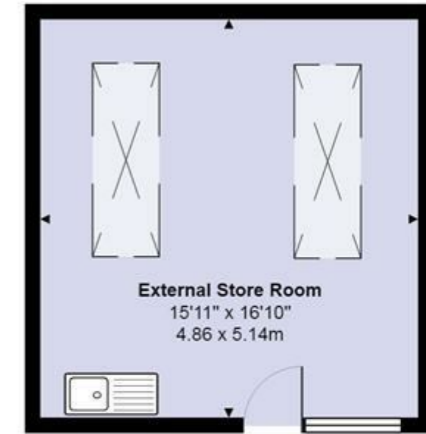
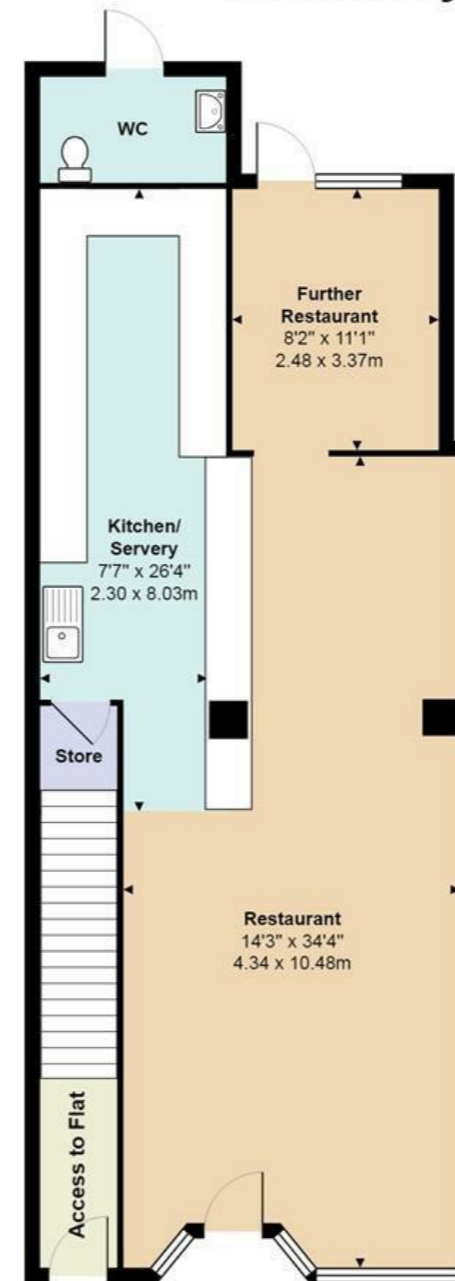

Total Area: 1098 ft² ... 102.0 m²

All measurements are approximate and for display purposes only

Superb A3 space in a prime location.

Comments by the Homeowner





Broadway

Adamsdown, Cardiff, CF24 1NF

PCM

£1,100 PCM



0 Bedroom(s)



0 Bathroom(s)



sq ft



Contact our
Penylan Branch

02920 499680

Superb A3 space in the popular Broadway, Adamsdown - in the heart of the popular eateries and commercial units of the area. Available on flexible terms. Contact Jeffrey Ross on 02920499680 to arrange a viewing.

INFO
A3 Consent
Large rear storage/preparation area.





CARDIFF

VALE

CAERPHILLY

BRISTOL

www.jeffreygross.co.uk





Energy Efficiency Rating

	Current	Potential
Very energy efficient - lower running costs		
(92 plus) A		
(81-91) B		
(69-80) C		
(55-68) D		
(39-54) E		
(21-38) F		
(1-20) G		
Not energy efficient - higher running costs		
England & Wales	EU Directive 2002/91/EC	

