



[www.jeffreygross.co.uk](http://www.jeffreygross.co.uk)

CARDIFF

VALE

CAERPHILLY

BRISTOL



*Gwynant Crescent*

LAKESIDE



*Spacious ground floor THREE Double bedroom apartment with independent access and garden*

Comments by Mrs Amanda Trinder



**Property Specialist**  
**Mrs Amanda Trinder**  
Senior valuer

amanda@jeffreycross.co.uk

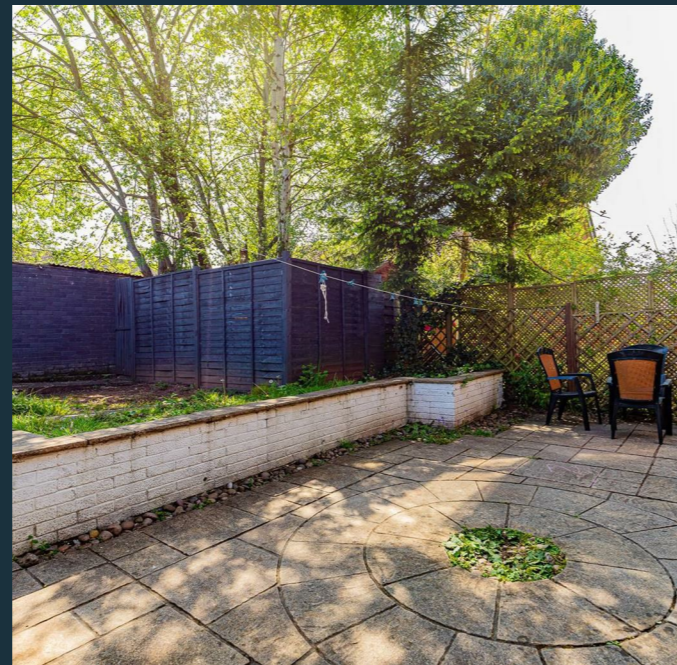

Comments by the Homeowner

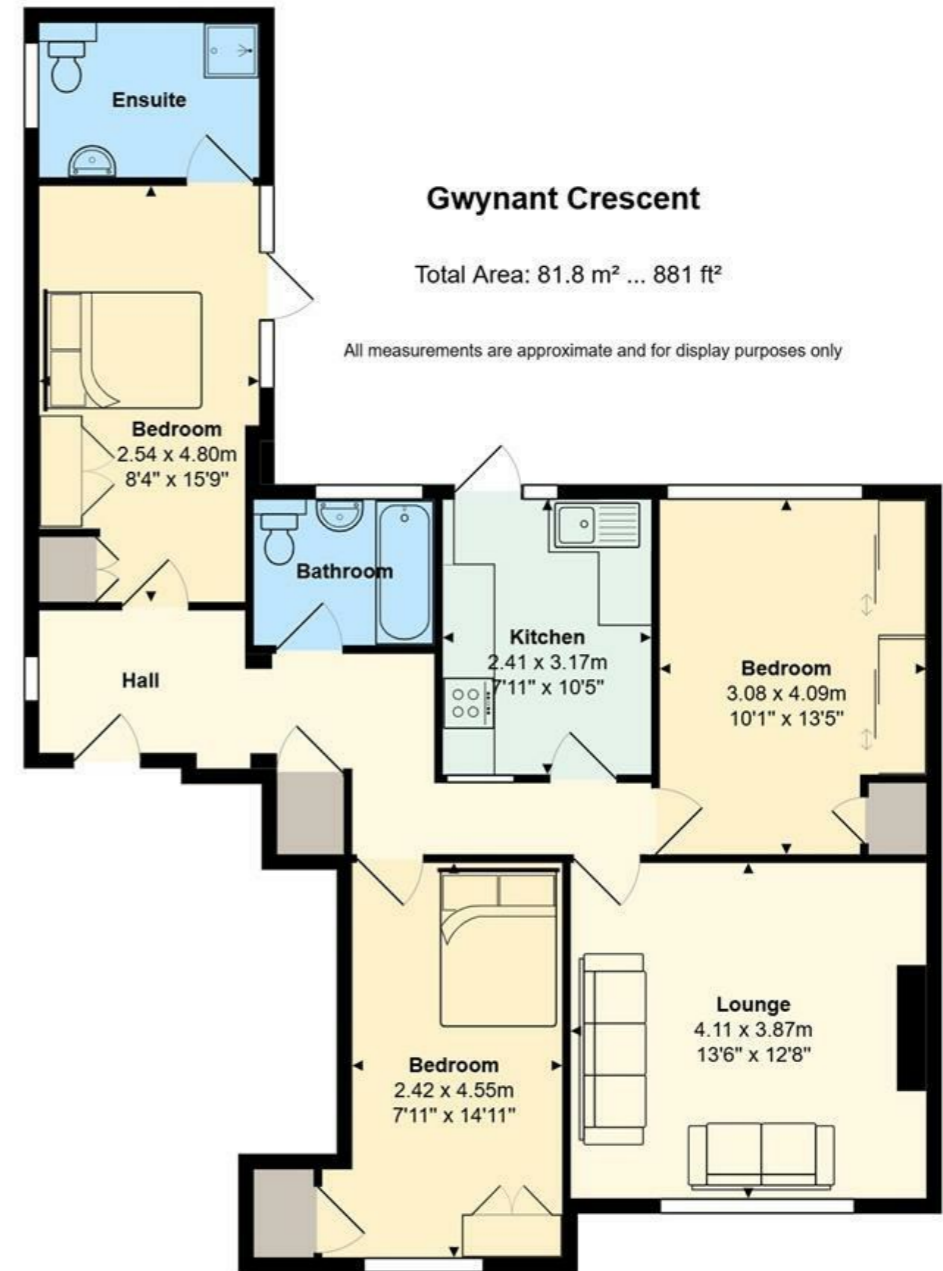



# Gwynant Crescent

Lakeside, Cardiff, CF23 6LT

Offers Over

£250,000



3 Bedroom(s)



2 Bathroom(s)



881.00 sq ft



Contact our  
**Penylan Branch**

02920 499680

\*\*\* Offers Over £250,000 \*\*\* Welcome to this charming ground floor maisonette located on Gwynant Crescent in the desirable area of Lakeside, Cardiff. This delightful property boasts a generous 881 square feet of living space, making it an ideal home for families or those seeking extra room to breathe.

As you enter, you will find a welcoming reception room that offers a perfect space for relaxation or entertaining guests. The maisonette features three well-proportioned bedrooms, providing ample accommodation for family members or guests. The layout is both practical and spacious, ensuring that each room feels comfortable and inviting.

One of the standout features of this property is the private garden, which offers a tranquil outdoor space for gardening, play, or simply enjoying the fresh air. It is a wonderful addition that enhances the overall appeal of the home, allowing for outdoor living in a peaceful setting.

Situated in a great location, this maisonette benefits from the amenities and conveniences of Lakeside within walking distance of local shops, Roath park boating lake and excellent transport links to Cardiff city centre. The area is known for its friendly community and picturesque surroundings, making it a lovely place to call home.

In summary, this spacious three-bedroom maisonette on Gwynant Crescent presents an excellent opportunity for those looking for a comfortable and well-located property in Cardiff. With its private garden and ample living space, it is sure to attract interest from a variety of buyers. Do not miss the chance to view this delightful home.



CARDIFF

VALE

CAERPHILLY

BRISTOL

[www.jeffreyross.co.uk](http://www.jeffreyross.co.uk)



#### Independent Entrance Hall

Lounge 13'6 x 12'8 (4.11m x 3.86m)

Kitchen 7'11 x 10'05 (2.41m x 3.18m)

Bedroom One 15'9 x 8'4 (4.80m x 2.54m)

En-Suite

Bedroom Two 7'11 x 14'11 (2.41m x 4.55m)

Bedroom Three 10'01 x 13'5 (3.07m x 4.09m)

Bathroom

Garden

Council Tax

Band E

#### Tenure

Leasehold

Lease Term Ends in 2086

Year remaining 160

Annual ground rent 0

Is the ground rent fixed for term No

Annual service charge 0

Annual service charge 0

What services are included as part of the service charge? No

Service charge. Peppercorn

How is the gas connected Mains

How is the electricity connected Mains

#### School Catchment

Lakeside Primary School (year 2024-25)

Cardiff High School (year 2024-25)

Ysgol Y Berllan Deg (year 2024-25)

Ysgol Gyfun Gymraeg Bro Edern (year 2024-25)



