

CARDIFF'S HOME FOR  
STYLISH SALES  
& LETTINGS

JeffreyRoss



GLENROY STREET  
ROATH



# GLENROY STREET

ROATH, CF24 3LA - £1,180 PCM

2 bedroom(s) 1 bathroom(s) sq ft

VIDEO AVAILABLE - CHECK IT OUT! Spacious ground-floor TWO BEDROOM apartment that is well-positioned in Roath and within walking distance of the City Centre, all major University campuses and just a stones throw from Wellfield Road and Roath Park. Located on the ground-floor, the property is entered via its own private entrance and offers modern-fitted, lounge / kitchen with stylish kitchen, good quality furnishings and generous floor space. Both bedrooms are a generous sized double (making this perfect for sharers!) and nicely furnished. The rear bedroom also benefits from access into a private, rear courtyard. The property is completed by a bathroom suite with bathtub and shower over. A great option for two friends!

GAS CENTRAL HEATING. FURNISHED.

EPC RATING of C

A holding fee of one weeks' rent will be payable to secure the dwelling. This will be deducted from the final balance payable upon moving into the dwelling, subject to a successful application. Jeffrey Ross Limited reserves the right to retain this payment should the applicant have provided false or misleading information at the time of applying for the dwelling or failed to take reasonable steps to enter into the Standard Occupation Contract.



Energy Efficiency Rating		
	Current	Potential
Very energy efficient - lower running costs		
(92 plus) <b>A</b>		
(81-91) <b>B</b>		
(69-80) <b>C</b>		
(55-68) <b>D</b>		
(39-54) <b>E</b>		
(21-38) <b>F</b>		
(1-20) <b>G</b>		
Not energy efficient - higher running costs		
	71	78
<b>England &amp; Wales</b>	EU Directive 2002/91/EC	

PROPERTY SPECIALIST

Miss Lauren King

lauren.king@jeffreypass.co.uk

02920499680

Lettings Negotiator



Glenroy Street, Roath

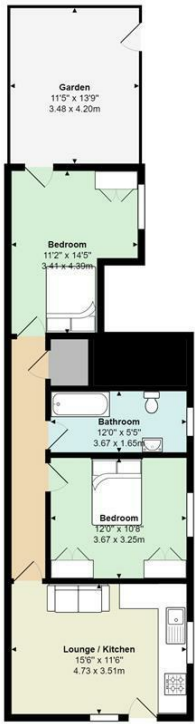

Total Area: 655 ft² ... 60.9 m² (excluding garden)  
All measurements are approximate and for display purposes only