

www.jeffreygross.co.uk

CARDIFF

VALE

CAERPHILLY

BRISTOL



Skypark Road

BEDMINSTER



Comments by Ms Olivia Melville-Brown



Property Specialist
Ms Olivia Melville-Brown
Branch manager

o.melvillebrown@thepropertyoutlet.com



Comments by the Homeowner

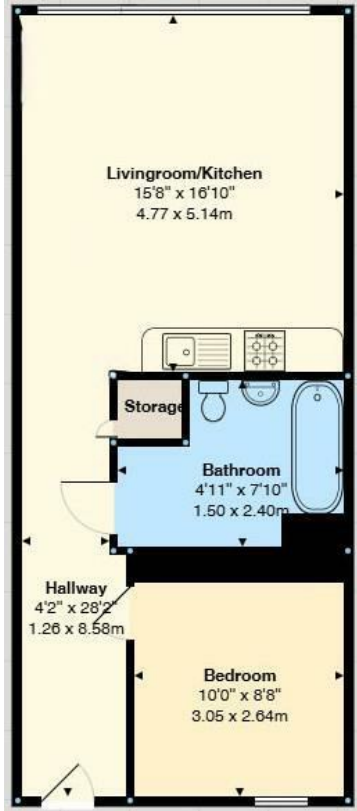



Energy Efficiency Rating		
	Current	Potential
Very energy efficient - lower running costs		
(92 plus) A		
(81-91) B		
(69-80) C	77	83
(55-68) D		
(39-54) E		
(21-38) F		
(1-20) G		
Not energy efficient - higher running costs		
England & Wales	EU Directive 2002/91/EC	



Skypark Road

Bedminster, Bristol, BS3 3NL

PCM

£1,050 PCM



1 Bedroom(s)



1 Bathroom(s)



462.85 sq ft



Contact our
Property Outlet Branch
0117 935 4565

* AVAILABLE NOW*

ONE DOUBLE BEDROOM APARTMENT! The Property Outlet are delighted to offer this fifth floor apartment to the rental market. The accommodation comprises COMMUNAL ENTRANCE WITH LIFT ACCESS, ENTRANCE HALLWAY, DOUBLE BEDROOM, OPEN PLAN KITCHEN/LIVING ROOM with FLOOR TO CEILING WINDOWS & a BATH/SHOWER ROOM & WC. Offered UNFURNISHED but with WHITE GOODS that include a WASHING MACHINE, FRIDGE/FREEZER & an ELECTRIC HOB/OVEN. Benefits include ELECTRIC HEATING & DOUBLE GLAZING. Situated in a CENTRAL LOCATION, this is the only residential building in Bristol with a ROOFTOP sky park with 360 DEGREE views of Bristol, with RUNNING TRACK, & BARBECUE TERRACE. The City Centre & popular North Street are within walking and The Property Outlet feel that this apartment would ideally suit a couple or a single professional. Sorry no pets. PLEASE NOTE THE WATER & SEWERAGE BILLS ARE INCLUDED WITHIN THE MONTHLY RENT.

Holding deposit £242.30



CARDIFF

VALE

CAERPHILLY

BRISTOL

www.jeffreygross.co.uk