

THE
PROPERTY
OUTLET

Bristol's home for Stylish Sales & Lettings



WESSEX AVENUE





WESSEX AVENUE

, BS7 0DE - £2,600 PCM



4 Bedroom(s)



1 Bathroom(s)



1184.04 sq ft

* AVAILABLE 25.08.2025 *

FANTASTIC & WELL PRESENTED FOUR BEDROOM HOME! The Property Outlet are delighted to offer to the rental market this END OF TERRACE HOME situated on a popular street within Horfield. The property has been REDECORATED THROUGH OUT & IS WELL PRESENTED. The accommodation comprises ENTRANCE PORCH, ENTRANCE HALL, LIVING ROOM, DINING ROOM (bedroom 1), REFITTED KITCHEN & a CLOAKROOM/WC. To the first floor there are THREE BEDROOMS & a REFITTED BATH/SHOWER ROOM & W/C. Benefits include GAS CENTRAL HEATING, DOUBLE GLAZING & GARDENS. The property is being marketed FURNISHED and with WHITE GOODS that include a WASHING MACHINE, FRIDGE/FREEZER & an ELECTRIC HOB/OVEN. Situated between Gloucester Road & Filton Avenue making it IDEAL FOR STUDENTS. Sorry no pets.

Holding Deposit £600.00

COUNCIL TAX BAND -



PROPERTY SPECIALIST

Ms Olivia Melville-Brown

o.melvillebrown@thepropertyoutlet

Assistant branch manager

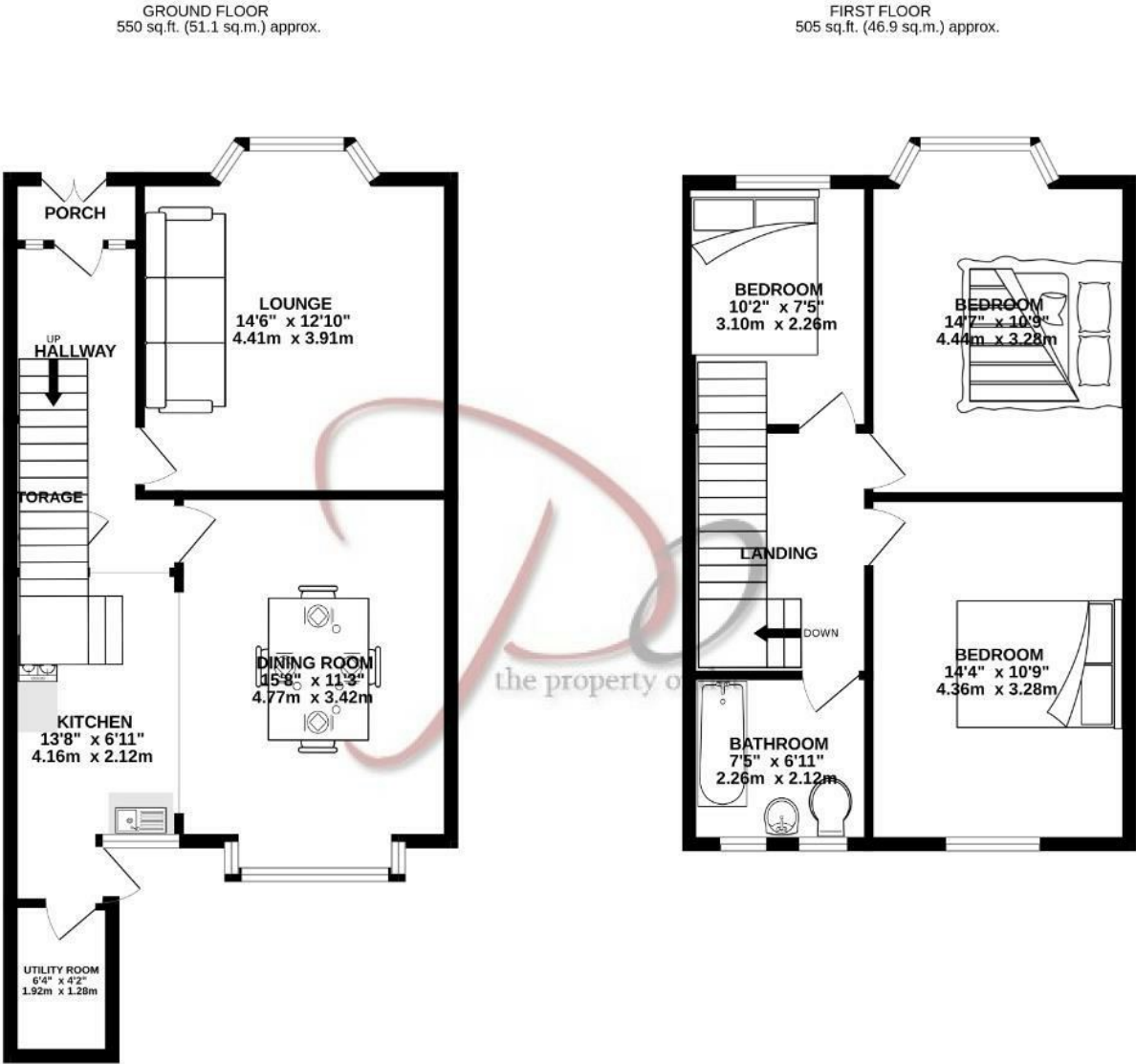

TOTAL FLOOR AREA: 1055 sq.ft. (98.0 sq.m.) approx.

Whilst every attempt has been made to ensure the accuracy of the floorplan contained here, measurements of doors, windows, rooms and any other items are approximate and no responsibility is taken for any error, omission or mis-statement. This plan is for illustrative purposes only and should be used as such by any prospective purchaser. The services, systems and appliances shown have not been tested and no guarantee as to their operability or efficiency can be given.
Made with Metropix ©2023

