



CHESTERFIELD STREET

BARRY



# CHESTERFIELD

EAST END, CF63 1BS

GUIDE PRICE

£150,000 - LEASEHOLD



3 Bed



1 Bath



sq ft

Situated on Chesterfield Street in the heart of Barry, this three bedroom home offers an exciting opportunity for buyers looking to put their own stamp on a property. With three spacious double bedrooms, it provides plenty of room for families, couples, or anyone in need of extra space for guests or a home office.

The property includes a welcoming reception room, ideal for relaxing or entertaining, and a functional bathroom with all the essentials. While the home would benefit from modernisation, it presents a wonderful blank canvas to create a space perfectly suited to your own style and vision.

Convenience is key with this location, as the property sits just moments from local shops, schools, and other amenities. Plus, with no onward chain, you can move forward quickly and easily with your plans.

In short, this three bedroom home on Chesterfield Street represents a fantastic opportunity to craft your dream home in a lively and well connected community.

**HALLWAY**  
3'03"

**LIVING ROOM**  
11'01" x 10'09"

**DINING ROOM**  
10'09" x 11'04"

**KITCHEN**  
8'06" x 11'0"

**INNER HALLWAY**  
3'11" x 2'08"

**BATHROOM**  
5'03" / 8'07" x 4'06" / 7'09"

**BEDROOM ONE**  
10'08" x 14'01"

**BEDROOM TWO**  
11'05" x 9'01"

**BEDROOM THREE**  
11'06" x 8'08"







Energy Efficiency Rating		
	Current	Potential
Very energy efficient - lower running costs		
(92 plus) <b>A</b>		
(81-91) <b>B</b>		<b>81</b>
(69-80) <b>C</b>	<b>71</b>	
(55-68) <b>D</b>		
(39-54) <b>E</b>		
(21-38) <b>F</b>		
(1-20) <b>G</b>		
Not energy efficient - higher running costs		
<b>England &amp; Wales</b>	EU Directive 2002/91/EC	



Chesterfield Street, Barry, CF63 1BS

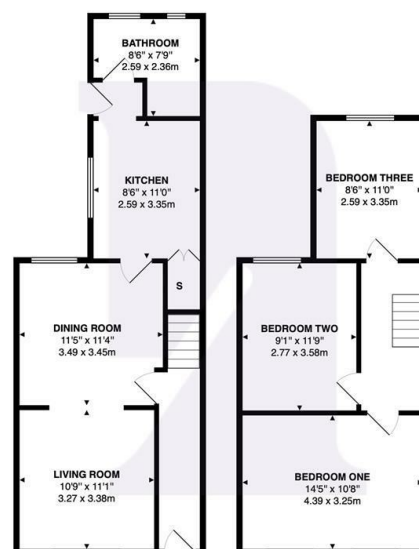

Total Area: 919 ft² ... 85.3 m²  
All measurements are approximate and for display purposes only

BARRY & THE VALE'S HOME FOR

STYLISH SALES  
& LETTINGS



KNIGHTS