



REGENT
ESTATES

HAXTERS CLOSE, BERKHAMSTED

£250,000 Leasehold

ACCOMMODATION

50% SHARED OWNERSHIP AND FIXED PRICE

Regent Estates are delighted to offer a rarely available two double bedroom terrace with was built in 2021 which is spacious, has a downstairs cloak room, south west facing garden and is in excellent condition throughout. Gas fired boiler serving domestic hot water and heating. Mains water, electricity and drainage.

NB. Buyers must meet the eligibility criteria for shared ownership. For further information contacting the Hightown Housing Association home ownership department, please call Regent Estates.

Landlord's details - Hightown Housing Association, Hightown House, Maylands Avenue, Hemel Hempstead - HP2 4XH

Based upon 50% shared ownership, the outgoings on the property are as follows:

£627.33 rent payable per month (as at April 2024)

Service charge: £31.11. per month

Management fee: £8.33p per month

Insurance: £12.72 per month

Staircasing to purchase additional shares in the property is possible, up to full ownership. At 100% ownership, the freehold will transfer to you.

LOCATION

OUTSIDE

IMPORTANT NOTICE

1. These sales particulars have been prepared from information supplied by the vendors and information collated by Regent Estates.
2. Confirmation has been sought from the vendors to confirm these particulars accuracy.
3. All measurements given have a tolerance of 3" in accordance with RICS Code of Measuring Practice.
4. None of these appliances, plumbing or electrics mentioned within these particulars have been tested by ourselves, prospective purchasers are urged to check their condition before entering in to purchase.

VIEWING

Strictly by appointment through Regent Estates.

01442 877878

141-143 High Street, Berkhamsted, Herts,
HP4 3HH

Email: info@regent-estates.com
www.regent-estates.com







Ground Floor

Approx. 37.0 sq. metres (398.0 sq. feet)

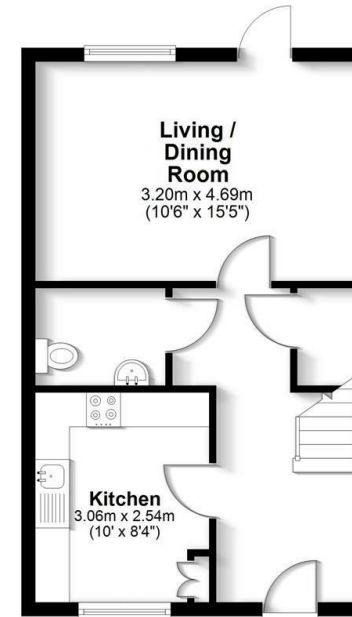

First Floor

Approx. 37.0 sq. metres (398.3 sq. feet)

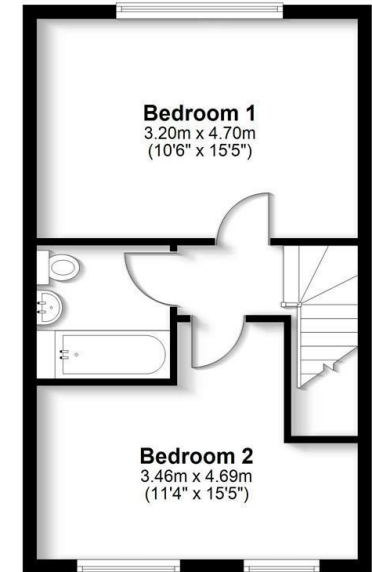

Total area: approx. 74.0 sq. metres (796.4 sq. feet)

FOR ILLUSTRATIVE PURPOSES ONLY - NOT TO SCALE - The position and size of doors, windows, appliances and other features are approximate only. Total area includes garages and outbuildings - © My Home Property Marketing - Unauthorised reproduction prohibited.
Plan produced using PlanUp.

REGENT
ESTATES

TELEPHONE: 01442 877878

141-143 High Street, Berkhamsted,
Herts, HP4 3HH

Email: info@regent-estates.com

www.regent-estates.com