

REGENT ESTATES

REGENT
ESTATES

BERKHAMSTED

£1,425 PCM

ACCOMMODATION

A luxury one bedroom first floor apartment CLOSE TO TOWN CENTRE in an expertly converted PERIOD building with stylishly crafted interior and beautifully finished to the highest standard throughout. ENQUIRE FOR FURTHER DETAILS.

One allocated parking space with EV charging point. Communal courtyard garden, bin/bike store.

Gas central heating. EPC B. Council tax band TBC.

AVAILABLE NOW UNFURNISHED

IMPORTANT NOTICE

1. These sales particulars have been prepared from information supplied by the vendors and information collated by Regent Estates.

2. Confirmation has been sought from the vendors to confirm these particulars accuracy.

3. All measurements given have a tolerance of 3" in accordance with RICS Code of Measuring Practice.

4. None of these appliances, plumbing or electrics mentioned within these particulars have been tested by ourselves, prospective purchasers are urged to check their condition before entering in to purchase.

VIEWING

Strictly by appointment through Regent Estates.

01442 877878

141-143 High Street, Berkhamsted, Herts,
HP4 3HH

Email: info@regent-estates.com

www.regent-estates.com

LOCATION

OUTSIDE



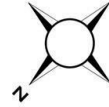

First Floor

Approx. 42.2 sq. metres (454.7 sq. feet)

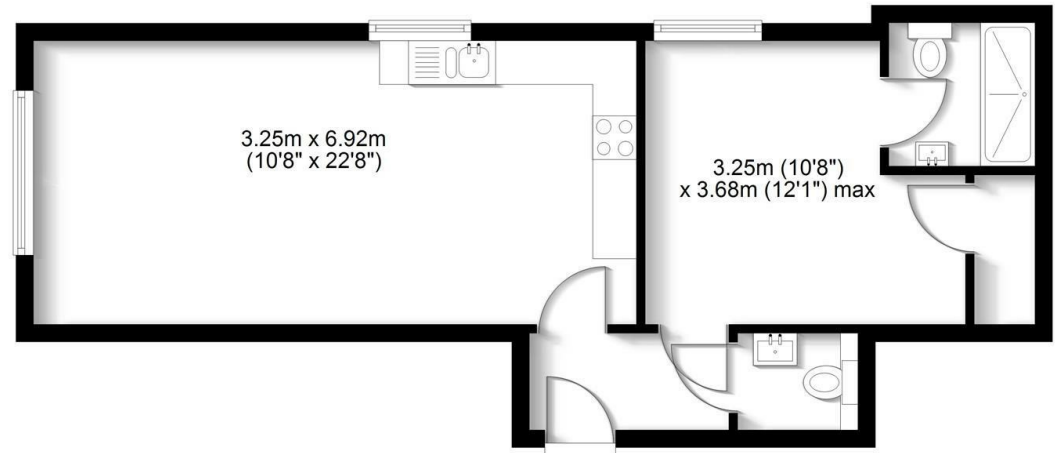

Total area: approx. 42.2 sq. metres (454.7 sq. feet)

FOR ILLUSTRATIVE PURPOSES ONLY - NOT TO SCALE - The position and size of doors, windows, appliances and other features are approximate only. Total area includes garages and outbuildings - © My Home Property Marketing - Unauthorised reproduction prohibited. Plan produced using PlanUp.

REGENT
ESTATES

TELEPHONE: 01442 877878

141-143 High Street, Berkhamsted,
Herts, HP4 3HH

Email: info@regent-estates.com

www.regent-estates.com