



# HARDINGS



Littlebrook Avenue  
£1,125 Per Month





A well presented first floor one bedroom apartment close to Burnham Train Station. The property comprises entrance hall, bathroom, double bedroom and open-plan living room/kitchen. Part furnished. EPC:C. Council Tax Band B. One parking space.

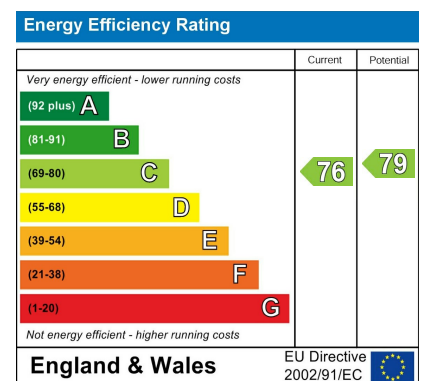

## Features

- First Floor Flat
- Electric Heating
- One Parking Space
- Part furnished
- One Double Bedroom
- Double Glazed Windows
- Close to Burnham Train Station

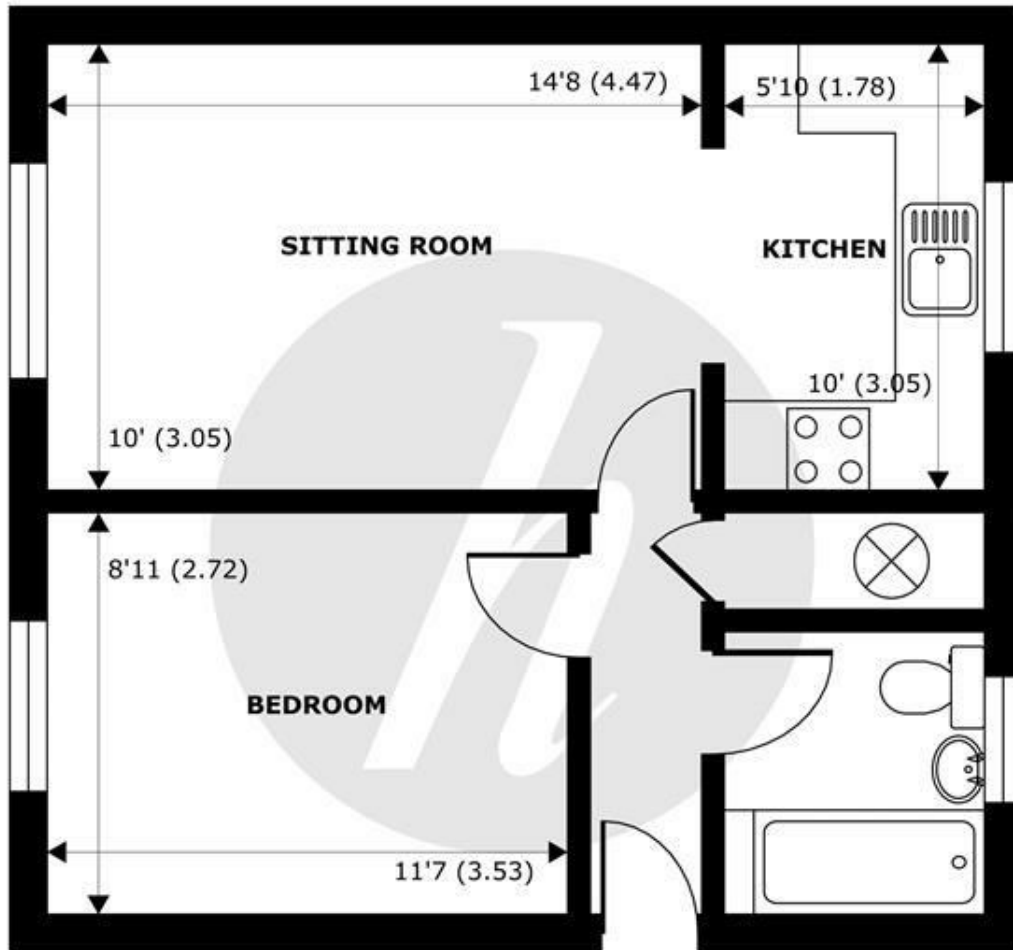
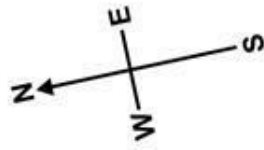

**FIRST FLOOR**  
abt 479 SQFT (44.5 SQMT)

## Littlebrook Avenue, Slough, SL2

Approximate Internal Area = 409 sq ft / 38 sq m  
Approximate External Area = 479 sq ft / 44.5 sq m

For identification only - Not to scale



Floor plan produced in accordance with RICS Property Measurement Standards incorporating International Property Measurement Standards (IPMS2 Residential). © nichecom 2022. Produced for Hardings. REF: 820148



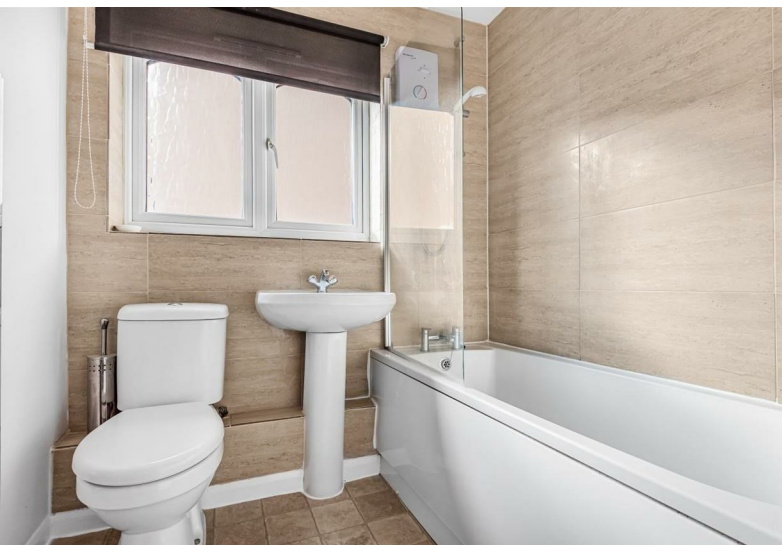

11 High Street, Windsor, Berkshire, SL4 1LD,  
T: 01753 833 118 | E: [info@hardings.co.uk](mailto:info@hardings.co.uk)  
[www.hardings.co.uk](http://www.hardings.co.uk)

