



# HARDINGS



Clewer Fields  
£1,800 PCM





Welcoming to the market this delightful cottage situated within close proximity to Windsor Town Centre.

Nestled away in the charming Clewer Fields, this home has been recently redecorated throughout and boasts two double rooms and a bonus loft room.

Offered Unfurnished, available now.

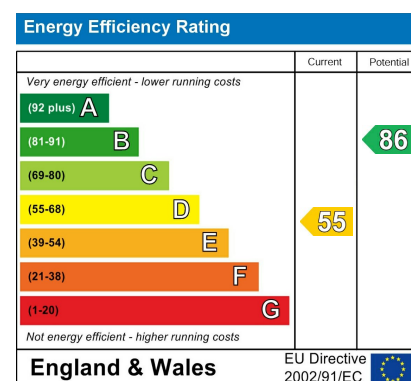

## Features

- Charming Cottage
- Bonus loft room
- Redecorated throughout
- Utility area
- Unfurnished
- 2 double bedrooms
- Modernised bathroom and kitchen
- Living and sitting room
- Small front and rear patio garden
- Available Now



NOT TO SCALE

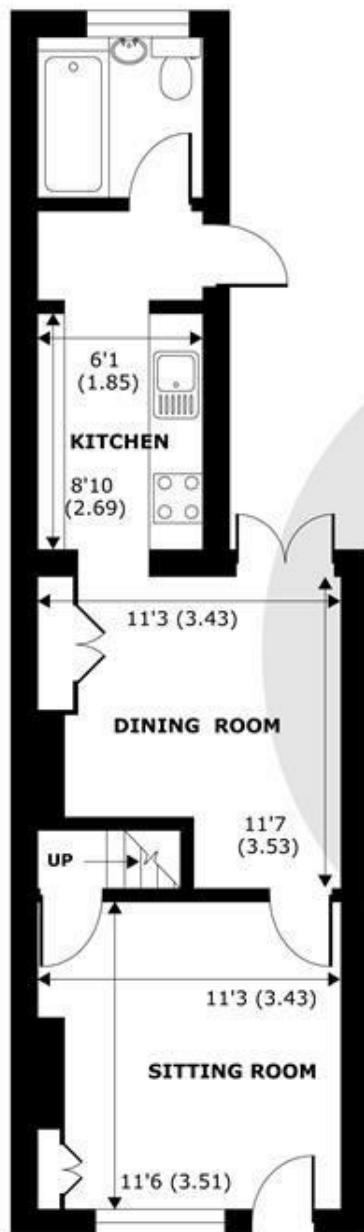

**GROUND FLOOR**  
abt 392 SQFT (47 SQMT)

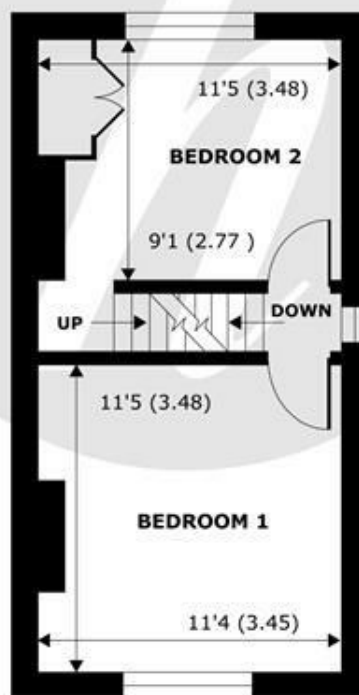

**FIRST FLOOR**  
abt 342 SQFT (31.8 SQMT)

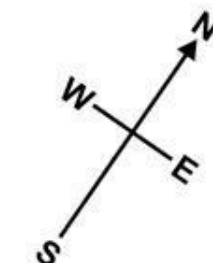

**SECOND FLOOR**  
abt 213 SQFT (19.8 SQMT)

**APPROX. GROSS EXTERNAL FLOOR AREA 1061 SQFT 98.6 SQM**

## Clewer Fields, Windsor, SL4



Whilst every attempt has been made to ensure the accuracy of the floor plan contained here, measurements of doors, windows and rooms are approximate and no responsibility is taken for any error, omission or misstatement. These plans are for representation purposes only as defined by RICS Code of Measuring Practice and should be used as such by any prospective purchaser. Specifically no guarantee is given on the total square footage of the property if quoted on this plan. Any figure given is for initial guidance only and should not be relied on as a basis of valuation.

Copyright nichecom.co.uk 2018 Produced for Hardings ref. 240468



11 High Street, Windsor, Berkshire, SL4 1LD,  
T: 01753 833 118 | E: [info@hardings.co.uk](mailto:info@hardings.co.uk)  
[www.hardings.co.uk](http://www.hardings.co.uk)

