



# HARDINGS



Kingsbury Drive  
Price Guide £350,000







This very well presented one bedroom end-of-terrace property on Kingsbury Drive, in Old Windsor benefits from a contemporary kitchen, modern shower room and large private garden.

A convenient village location within a short distance of local schools, nurseries and amenities, with easy access to Windsor and surrounding transport links.

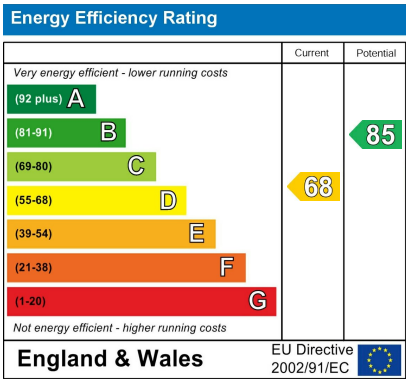

Features

- Village Location
- Modern shower room
- Good sized Private Garden
- Freehold
- Contemporary Kitchen
- Ample on street parking
- Close to local amenities

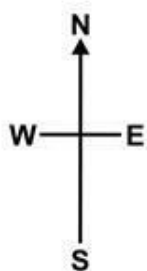

Denotes restricted  
head height

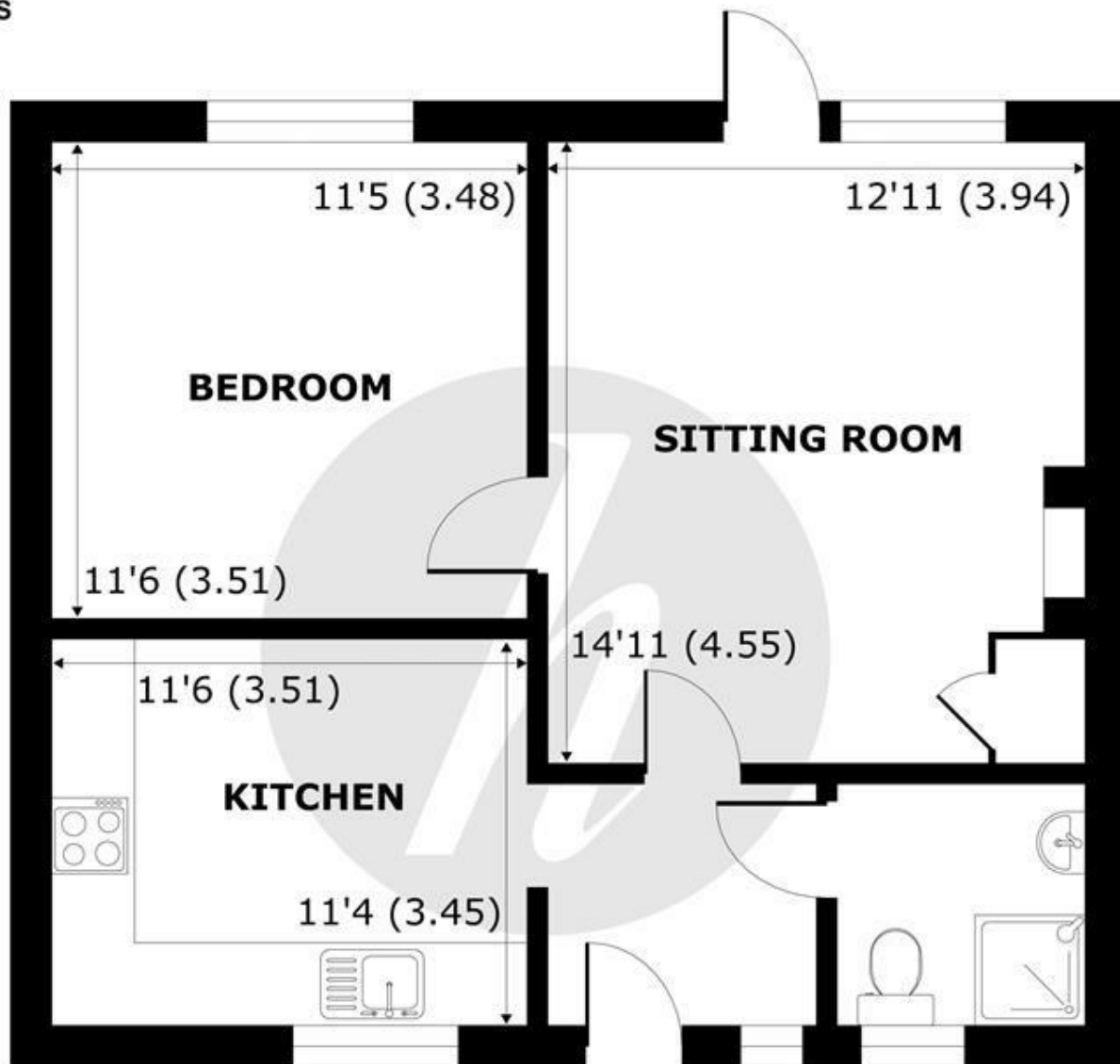

**GROUND FLOOR**  
**abt 533 SQFT (49.5 SQMT)**

**Kingsbury Drive, Old Windsor, Windsor, SL4**

Approximate Internal Area = 533 sq ft / 49.5 sq m

For identification only - Not to scale



Floor plan produced in accordance with RICS Property Measurement 2nd Edition,  
Incorporating International Property Measurement Standards (IPMS2 Residential). © nichecom 2025.  
Produced for Hardings. REF: 1406047







11 High Street, Windsor, Berkshire, SL4 1LD,  
T: 01753 833 118 | E: [info@hardings.co.uk](mailto:info@hardings.co.uk)  
[www.hardings.co.uk](http://www.hardings.co.uk)

