



# HARDINGS



Heathcote Court  
£1,600 PCM





A well presented two bedroom apartment situated on a popular road within a few minutes walking to central Windsor. The property comprises dining room, living room, kitchen, two double bedrooms and a bathroom. One allocated parking space. Unfurnished. EPC:C. Council Tax Band E.

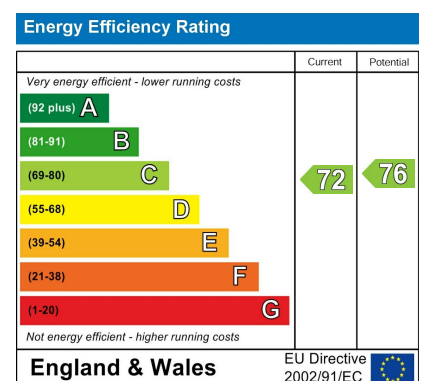

## Features

- Two bedroom apartment
- Short walk to Central Windsor
- Council Tax Band E
- Unfurnished
- EPC:C
- One allocated parking space

NOT TO SCALE

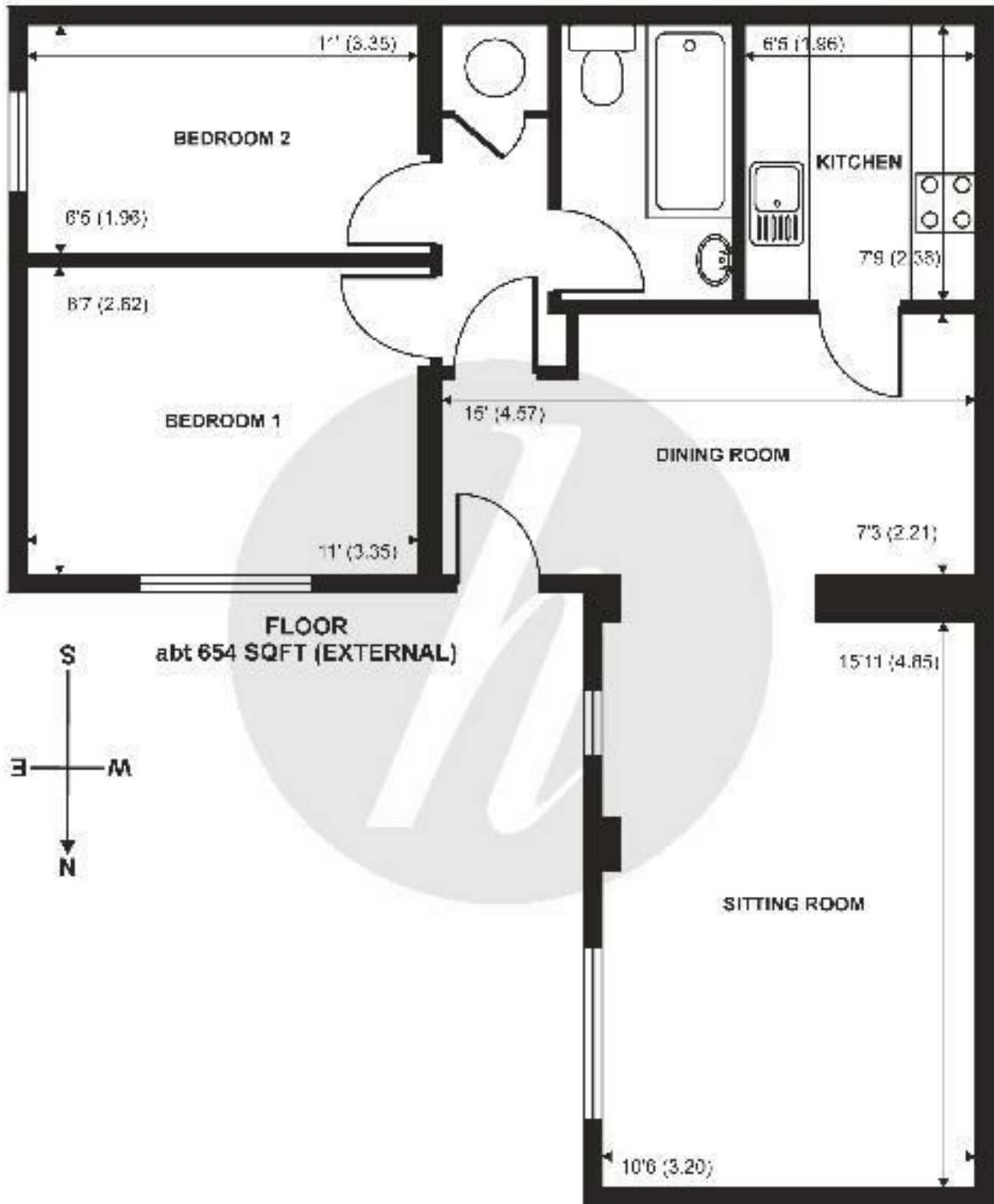

## Heathcote Court Windsor Berkshire

  
**HARDINGS**

While every attempt has been made to ensure the accuracy of the floor plans contained here, measurements of floors, windows, the items and appliances and no responsibility is taken for any error, omission or mis-statement. Floor plans are for information purposes only as defined by R.I.C. Code of Measuring Practice and should be used as such by any prospective purchaser. The services, systems and appliances listed in this specification have not been tested by standards and no guarantee as to their use, adaptability or their efficiency can be given.

Copyright Hardings 2005. Supplied by [www.aiche.com/eng-uk](http://www.aiche.com/eng-uk) tel: 05-07234



11 High Street, Windsor, Berkshire, SL4 1LD,  
T: 01753 833 118 | E: [info@hardings.co.uk](mailto:info@hardings.co.uk)  
[www.hardings.co.uk](http://www.hardings.co.uk)

