



# HARDINGS



Vansittart Road  
£4,500 PCM







Forming part of a terrace of four properties, this is a luxurious four-bedroom mid terraced townhouse, with parking for 2 cars, built by luxury builders 'The BellView Group'. Located on a quiet residential road just a short walk to Windsor town centre, the property encompasses stylish and beautifully appointed accommodation throughout.

On the ground floor, there is an open-plan kitchen/dining room blending seamlessly into a spacious reception area replete with high ceilings and bi-fold doors opening onto a private west-facing private garden. Further benefits include a separate utility room with a cloakroom.

The principal bedroom, which is located on the first floor, enjoys a private terrace, ample storage and en-suite bathroom. There are a further three double bedrooms all offered with en-suite bathrooms.

The property is ideally located for the mainline British Rail links to London (Waterloo & Paddington), M25 & M40, excellent schools and Heathrow Airport.

Offered Unfurnished.

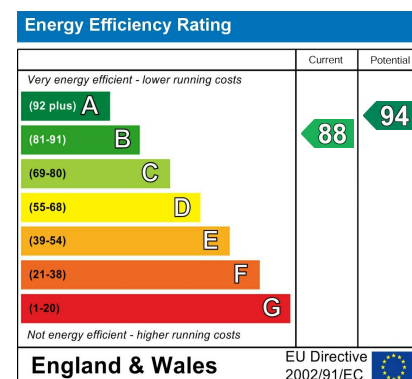

## Features

- Collection of 4 beautiful Newbuild Townhouses by Prestigious Developer, BellView Group
- 3 Further Double Bedrooms, 3 Ensuite Bathrooms
- Large Open Plan Kitchen/ Dining Room/Reception Room
- Utility Room with WC
- Off Street Parking for Two Cars
- Principal Bedroom with En-Suite Bedroom and Terrace
- Study
- Bi-Fold Doors onto Garden
- Town Centre Location
- Available mid October



**GROUND FLOOR**  
abt 824 SQFT (76.5 SQMT)

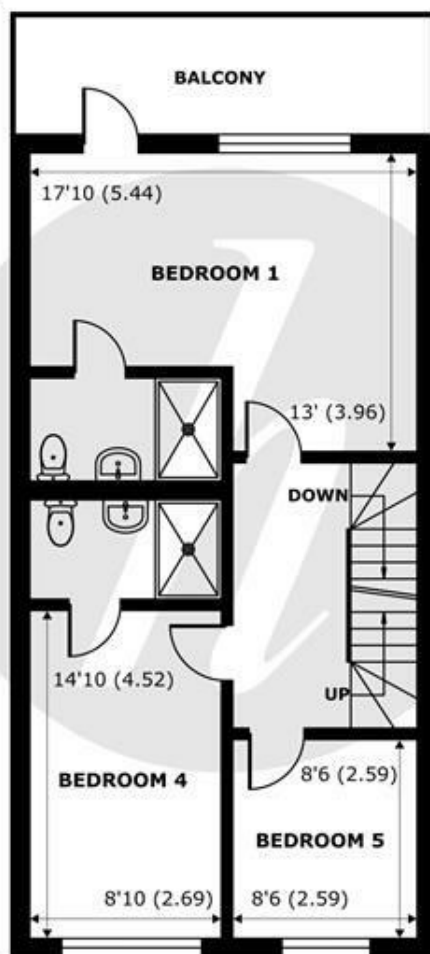

**FIRST FLOOR**  
abt 712 SQFT (66.1 SQMT)

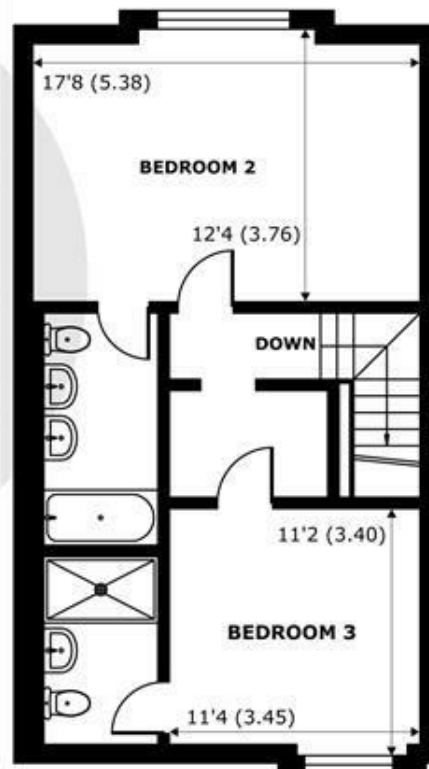

**FIRST FLOOR**  
abt 649 SQFT (60.2 SQMT)

## Vansittart Road, Windsor, SL4

Approximate Internal Area = 1910 sq ft / 177.4 sq m

Approximate External Area = 2185 sq ft / 203 sq m

For identification only - Not to scale



Floor plan produced in accordance with RICS Property Measurement Standards incorporating International Property Measurement Standards (IPMS2 Residential). © nichecom 2024. Produced for Hardings. REF: 1164092





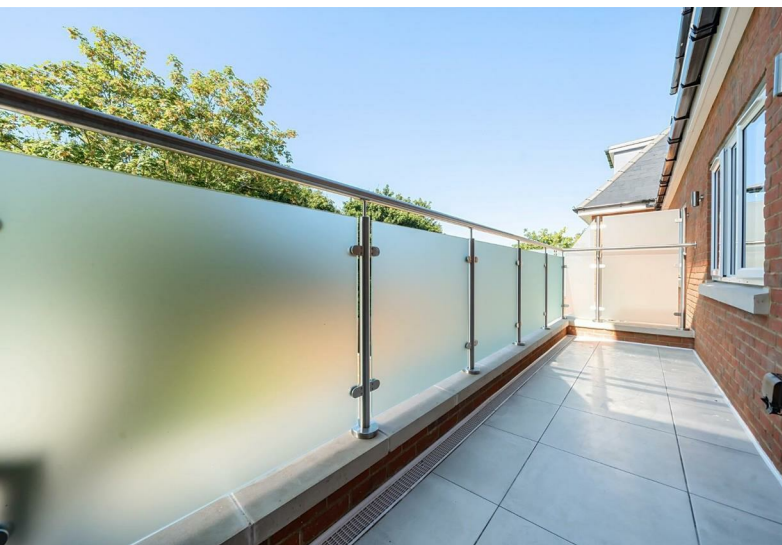

11 High Street, Windsor, Berkshire, SL4 1LD,  
T: 01753 833 118 | E: [info@hardings.co.uk](mailto:info@hardings.co.uk)  
[www.hardings.co.uk](http://www.hardings.co.uk)

