



HARDINGS



30 Edinburgh Gardens
Price Guide £575,000





A well-presented three bedroom home situated in a popular gated development adjacent to the Long Walk, just a short distance from the High Street, shops and train stations. The property includes a modern kitchen with a bright, airy living room overlooking a good-sized private garden. There is resident and visitor parking in the development controlled via permits and this property also has the added benefit of a garage.

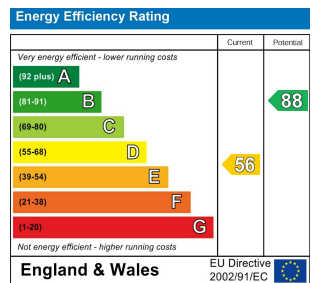

Features

- Three Bedroom Terrace Property
- Dining Room
- Downstairs Cloakroom
- Enclosed Front Garden
- Share of Freehold
- Separate Modern Integrated kitchen
- Bright Reception Room
- Private Garden
- Gated Development
- Sought After Location

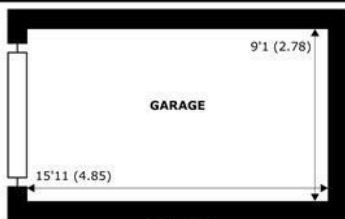

GARAGE
abt 145 SQFT (13.4 SQMT)

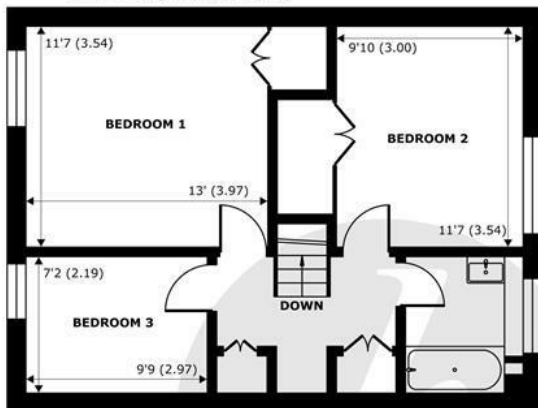

FIRST FLOOR
abt 506 SQFT (47 SQMT)

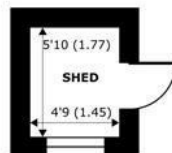

OUTBUILDING
abt 28 SQFT (2.6 SQMT)

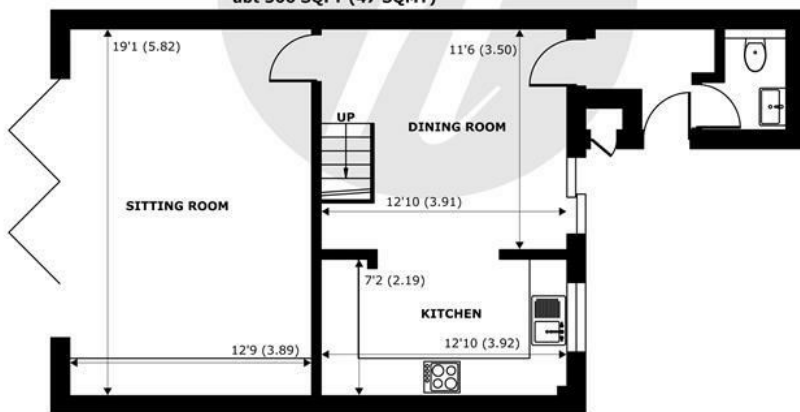

GROUND FLOOR
abt 679 SQFT (63 SQMT)

Approximate Internal Area = 1065 sq ft / 98.9 sq m (Exclude Garage & Outbuildings)
 Approximate External Area = 1278 sq ft / 118.7 sq m (Exclude Garage & Outbuildings)
 Total = 2343 sq ft / 217.6 sq m

For identification only - Not to scale



Floor plan produced in accordance with RICS Property Measurement 2nd Edition, Incorporating International Property Measurement Standards (IPMS2 Residential). © nichecom 2026. Produced for Hardings. REF: 1395555





11 High Street, Windsor, Berkshire, SL4 1LD,
T: 01753 833 118 | E: info@hardings.co.uk
www.hardings.co.uk

