





Reception Hall	14'11" x 12'5" (4.563 x 3.800)
Formal Dining Room	12'6" x 10'11" (3.823 x 3.348)
Kitchen	15'8" x 11'0" (4.788 x 3.356)
Walk in Pantry	9'9" x 6'9" (2.984 x 2.079)
Dining Area	10'6" x 10'3" (3.210 x 3.144)
Garden Room	13'10" x 8'10" (4.237 x 2.699)
Study or 5th Bedroom	12'3" x 9'5" (3.742 x 2.886)
Lounge	19'0" x 14'9" (5.815 x 4.499)
Utility Room	7'4" x 5'6" (2.249 x 1.700)
Cloakroom WC	
Garage	18'8" x 17'7" (5.708 x 5.376)
First floor Landing	
Bedroom 1	13'6" x 11'3" (4.134 x 3.448)
En-suite Shower Room	7'4" x 7'11" (2.249 x 2.435)
Walk-in Wardrobe	
Bedroom 2	12'6" x 11'0" (3.823 x 3.369)
Bedroom 3	11'7" x 8'8" (3.554 x 2.644)
Bedroom 4	11'5" x 7'6" (3.482 x 2.292)
Family Bathroom	8'0" x 6'7" (2.453 x 2.021)





GROUND FLOOR

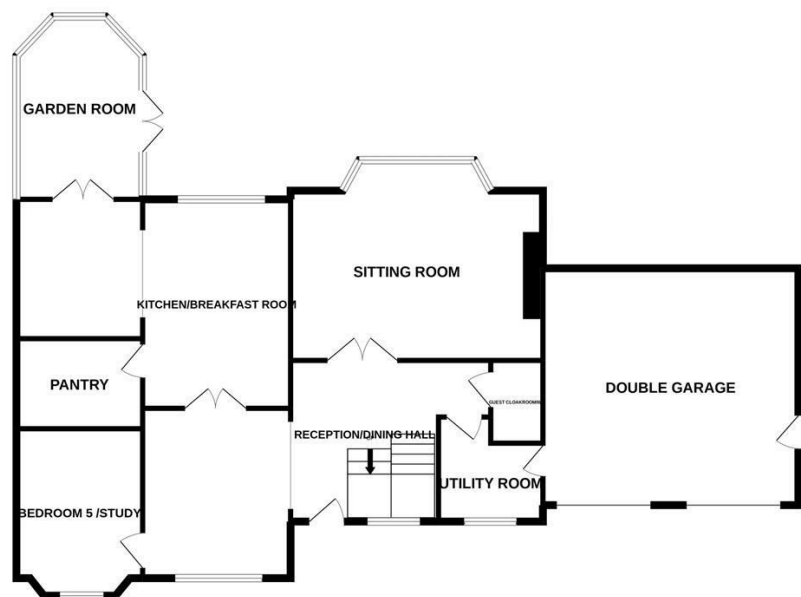

1ST FLOOR

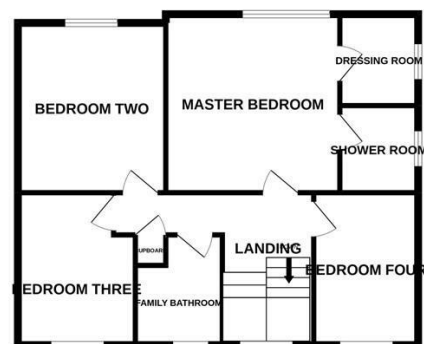

Whilst every attempt has been made to ensure the accuracy of the floorplan contained here, measurements of doors, windows, rooms and any other items are approximate and no responsibility is taken for any error, omission or mis-statement. This plan is for illustrative purposes only and should be used as such by any prospective purchaser. The services, systems and appliances shown have not been tested and no guarantee as to their operability or efficiency can be given.
Made with Metropix ©2022

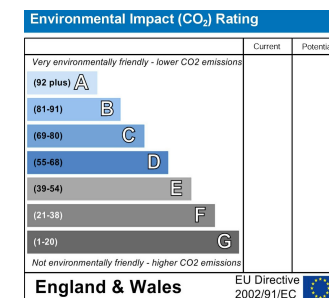
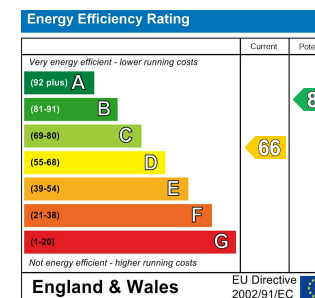
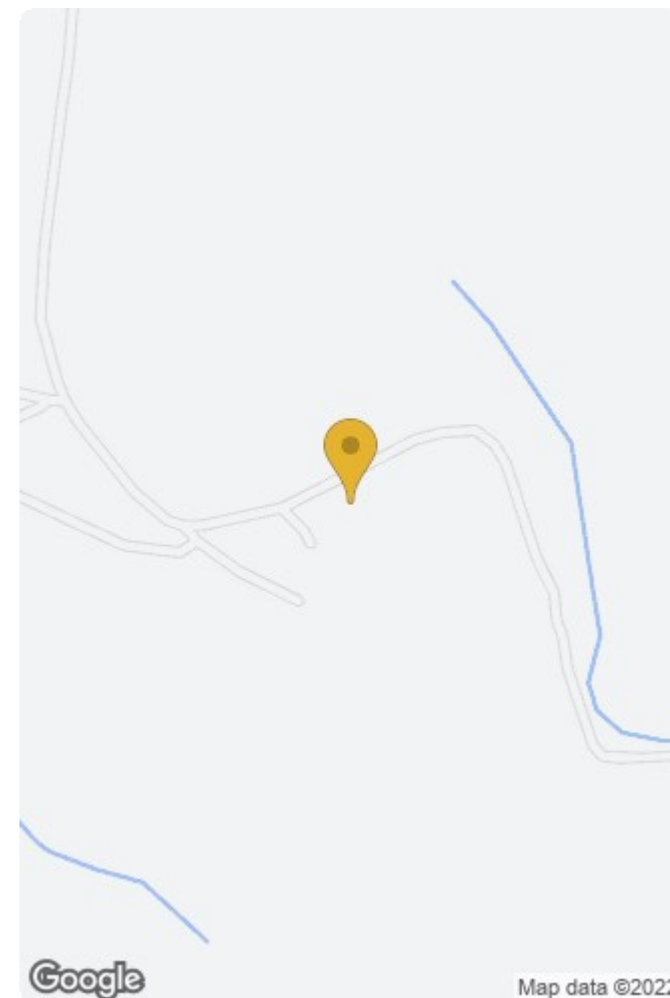

11 West Road, Ponteland, Northumberland, NE20 9SU Tel: 01661 829164 Email: office@goodfellowsestateagents.com