



£775,000 **Freehold**

Edwardian semi detached house situated in a desirable location within walking distance of Sevenoaks mainline station & the town centre.



St Johns Road, Sevenoaks



Bedrooms: 3



Bathrooms: 1



Receptions: 2

- Attractive Edwardian house
- 3 double bedrooms
- Close to local amenities & schools
- Off street parking for 1 car
- CHAIN FREE

Deceptively spacious Edwardian semi-detached house set over three floors situated in a desirable location. The property is located close to local schools, under a mile from the town centre and main line station. Within walking distance to several state and private schools. CHAIN FREE

Entrance hallway. Living room with bay window. Second reception room with under stairs storage, leading to kitchen diner with fitted wall and base units, patio doors out to the garden. Downstairs WC. Stairs up to first floor, master bedroom with built in wardrobes and feature fireplace. Second double room with feature fireplace. Spacious bathroom with separate bath and shower cubicle, feature fireplace. Stairs up to third double bedroom with velux windows.

Garden with lawn, patio, shed and side access. Driveway parking for one car.

LOCAL AUTHORITY - Sevenoaks District Council - Tax band E

Mains gas/electricity/water/sewage

Heating: Mains gas

Local Authority: Sevenoaks District Council

Council Tax Band: E

Tenure: Freehold



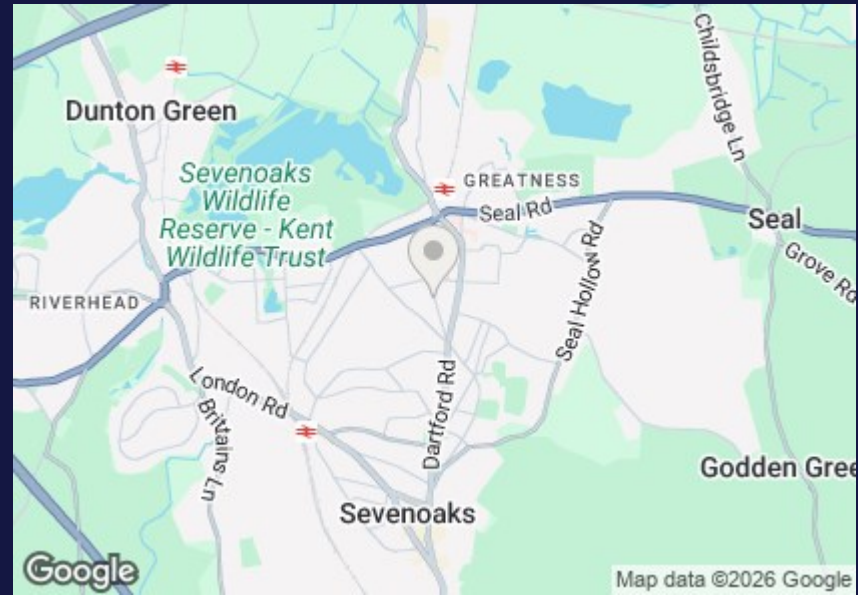



Ground floor



First floor

Gross internal area (approx.)
House - 116.2 sq m (1250 sq ft)

For identification only - Not to scale
© Trueplan (UK) Limited

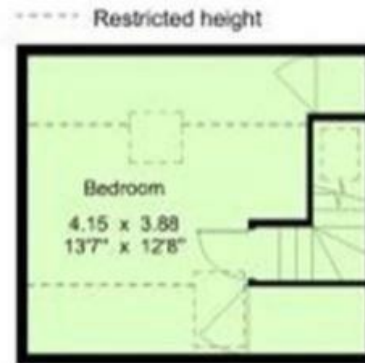

Second floor

Energy Efficiency Rating		Current	Potential
Very energy efficient - lower running costs			
(92 plus) A			82
(81-91) B			
(69-80) C			
(55-68) D		68	
(39-54) E			
(21-38) F			
(1-20) G			
Not energy efficient - higher running costs			
England & Wales		EU Directive 2002/91/EC	



CAVENDISH

LETTINGS, SALES & PROPERTY MANAGEMENT

2 - 3 The Shambles

Sevenoaks

Kent

TN13 1LJ

01732 464498

mail@cavendish.pro

www.cavendish.pro