



Sansome Place

Worcester |

FOX TOWN & COUNTRY HOMES

FOX TOWN & COUNTRY HOMES

Sansome Place, Worcester,

- CITY CENTRE LOCATION
- 3 Story town house
- Freehold
- Open plan kitchen diner
- Separate utility room
- 3 bed property
- Family bathroom and ensuite facilities to master bedroom
- 2 further reception rooms
- Good size AstroTurf courtyard style garden
- New double glazed windows throughout
- Small Garage perfect for storage
- Off road parking for 2 vehicles
- Great city centre location near to Worcester Foregate Railway Station





An Elegant Three-Story Townhouse in the Heart of the City

Set across three beautifully arranged floors, this refined townhouse combines contemporary design with everyday practicality. The property offers three well-proportioned bedrooms, including a master suite with private en-suite, alongside a thoughtfully designed family bathroom.

The heart of the home lies within the open-plan kitchen and dining area, where sleek quartz worktops, integrated white goods, and modern finishes create a space as stylish as it is functional. A separate utility room adds further convenience, while two inviting reception rooms provide versatile living and entertaining areas. The light and airy living room feels open, fresh, and inviting. It features two large windows that allow natural light to flood the space. Newly fitted bathrooms with contemporary tiling, modern fixtures, and plenty of light make them both stylish and comfortable, creating a relaxing place to start and end the day.

Further features include a private garage with off-road parking for two vehicles

A prime city centre location, moments from the racecourse and cultural attractions. In recent years, Worcester's High Street has seen the addition of new coffee shops, eateries, theatres, pubs, and restaurants, further enhancing the area's appeal. The nearby riverside walks add a touch of tranquility, making it a delightful place to live.

The property boasts excellent access to both renowned private and state schools including Royal Grammar School and Kings School.

With its elegant proportions, exceptional finishes, and enviable setting, this townhouse presents a rare opportunity to enjoy sophisticated city living within a home designed for modern lifestyles. Great for both working professionals or as a family home in the heart of the city.





Services: Mains Drainage, Mains Water, Mains Electric, Mains Gas and central heating, Freehold, Worcester City Council

Yearly service charge of £400

Tax Band E

Administrative Deposit:

Fox Town and Country Homes requires a £1,000.00 deposit payable by the purchaser prior to issuing the Memorandum of Sale. This will be reimbursed at the point of completion. If you decide to withdraw from the purchase this deposit may not be reimbursed and the deposit collected either in part or in full and retained by Fox Town and Country Homes to cover administration and re-marketing costs of the property. THIS IS REFUNDABLE

Should any structural defects be found following a survey of the property - a defective legal title, information gathered by usual searches that your solicitor orders that dramatically affect the value of the property and therefore you have no choice but to withdraw from the purchase, or should the sellers withdraw from the sale, you will be reimbursed the full deposit amount paid.





FOX

TOWN &
COUNTRY
HOMES

43 Sansome Place, Worcester, Worcestershire, WR1 1UA

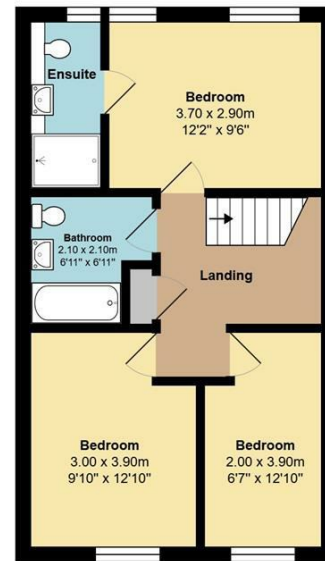
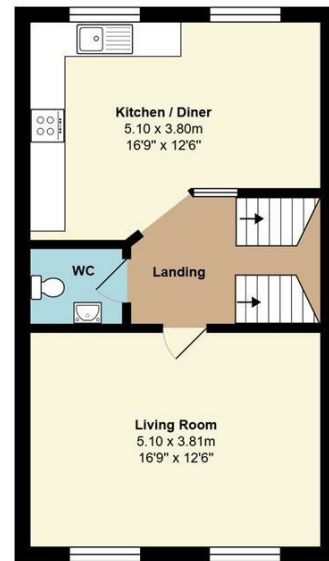
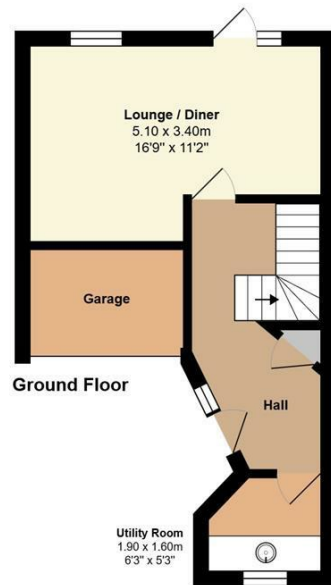

Total Approx Area: 131.0 m² ... 1410 ft²

All measurements of doors, windows, rooms are approximate and for display purposes only.

No responsibility is taken for any error, omission or mis-statement.

This plan is for illustrative purposes only and should be used as such by any prospective purchaser.

The services, systems and appliances shown have not been tested and no guarantee as to the operability or efficiency can be given.

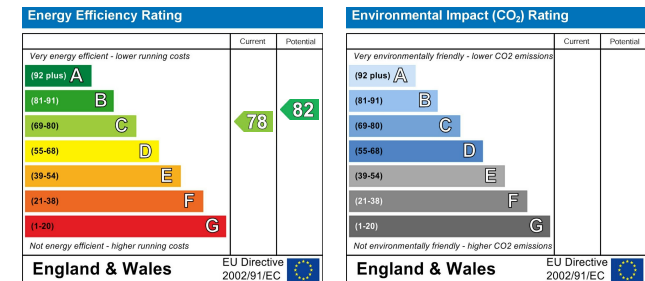

Tel: 01684 210950 or 01905 947640

contact@foxtownandcountryhomes.co.uk

39, Worcester Road, Malvern, Worcestershire, WR14 4RB

www.foxtownandcountryhomes.co.uk

