



4 Manor Farm Court

Bishopton, Stockton-On-Tees, TS21 1GL

Offers in excess of £625,000



Located In The Heart Of Beautiful Bishopton Village, This Impressive 4/5 Bedroom Detached Home Is One Of Only Two Bespoke Designs Built In 2010. Set On A Generous Plot, The Property Enjoys Breathtaking Open Views Over Farmland And Horses, With Additional Land Included That Leads Down To A Stream And Historic Humpback Bridge - Perfect For Nature Lovers And Those Seeking Privacy.



Full Description

The Home Offers A Split-Level Layout, Ideal For Flexible Family Living, With Potential For A Fifth Bedroom/Office/Cinema Room Or Independent Living Space On The Entrance Level. A Utility Room And WC Are Also Located Here For Added Convenience.

The Heart Of The Home Is The Open-Plan Kitchen/Family Area, Complete With Granite Worktops, Integrated Appliances, Underfloor Heating, And French Doors Leading To The Beautifully Landscaped South Facing Rear Garden. The Marble & Karndeian Flooring To The Ground Floor & First Level Adds A Premium Touch, While The Generous Lounge/Diner Provides The Perfect Space For Entertaining.

The Master Suite Includes A Walk-In Wardrobe And Modern En-Suite, With Three Further Bedrooms Served By A Luxurious Family Bathroom Featuring A Separate Shower And Designer Bathtub.

Outside, The Property Boasts A Double Garage With New R/C Electric Roller Door, Block-Paved Driveway, Mature And Well-Stocked Garden, Patio, Glass Roof Veranda, Pergola, And Two Garden Sheds. External Power And Water Outlets Are Also Installed, Adding Practicality To This Idyllic Outdoor Space.

This Is A Rare Opportunity To Secure A Spacious, Energy-Conscious Home In A Stunning Village Setting - Ideal For Families Or Multi-Generational Households.

Location

From Bishopton High Street Turn Onto The Green, The Property Sits Opposite The Talbot Restaurant/Village Pub.

- The Talbot, 47-49 The Grn - 1 Minute Walk
- Blue Bell Inn, 31 High St - 4 Minute Walk
- Stockton Country Parish, St Peter's Church - 1 Minute Walk
- North East Wake Park, Surf Store, Bishopton Lake - 15 Minute Walk / 2 Minute Drive
- Bishopton Redmarshall Primary School - 3 Minute Walk

Distance Times Estimated Using Google Maps.

Note

Please Find The Attached Brochure With Material Information For Buyers.

Disclaimer

Although Issued In Good Faith, These Particulars Are Not Factual Representations And Are Not A Part Of Any Offer Or Contract. Prospective Buyers Should Independently Verify The Matters Mentioned In These Particulars. There Is No Authority For Harper & Co Estate Agents Limited Or Any Of Its Employees To Make Any Representations Or Warranties About This Property.

While We Try To Be As Accurate As Possible With Our Sales Particulars, They Are Only A General Overview Of The Property. If There Is Anything In Particular That Is Important To You, Please Contact The Office And We Will Be Happy To Check The Situation For You, Especially If You Are Considering Traveling A Significant Distance To View The Property. The Measurements Provided Are Only For Guidance, Thus They Must Be Regarded As Inaccurate. Please Be Aware That Harper & Co Have Not Tested Any Of The Services, Appliances, Or Equipment In This Property; As A Result, We Advise Prospective Buyers To Commission Their Own Surveys Or Service Reports Before Submitting A Final Offer To Purchase. Money Laundering Regulations:In Order To Avoid Any Delays In Finalising The Sale, Intending Buyers Will Be Required To Provide Identification Documentation At A Later Time. Please Cooperate With Us In This Process.

These particulars, whilst believed to be accurate are set out as a general outline only for guidance and do not constitute any part of an offer or contract. Intending purchasers should not rely on them as statements of representation of fact, but must satisfy themselves by inspection or otherwise as to their accuracy. No person in this firms employment has the authority to make or give any representation or warranty in respect of the property.

Area Map



Floor Plans

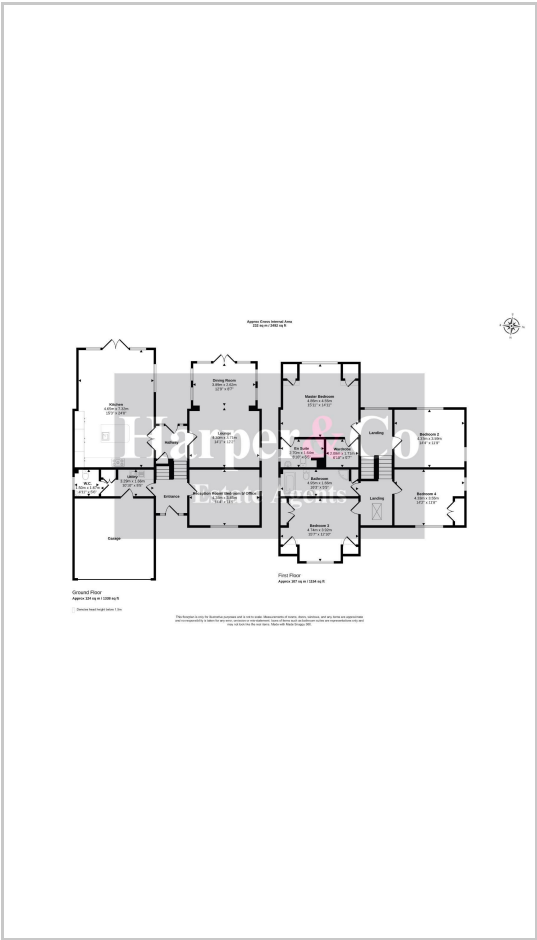

Energy Efficiency Graph

