



## 152 Whitehouse Road

Wolviston Court, Billingham, TS22 5BQ

**£475,000**



Offered For Sale With The Advantage Of No Onward Chain! Whitehouse Road, Wolviston Court, Billingham - A Truly Exceptional Property That Offers A Unique Living Experience. This Detached House Boasts 3 Reception Rooms, 5 Bedrooms, 3 Bathrooms & Sauna, Providing Ample Space For Comfortable Living.

The Property's Versatile Accommodation Over Split Levels Allows For Various Possibilities, Making It Perfect For Those Seeking A Home With Character And Charm. The Extension/Annex, Which Includes A Ground Level Living Room, Bedroom, And Bathroom, Adds To The Property's Appeal And Functionality Being Easily Accessible.

One Of The Standout Features Of This Home Is The Potential Business From Home Opportunity It Presents. With A Separate Space That Could Be Utilised For A Home Office Or Studio, Working From Home Has Never Been More Convenient.





**Location**  
Whitehouse Road Is Positioned In A Sought After Area Of Wolviston Court, Billingham.

Priors Mill C of E Primary School - 12 Minute Walk  
Northfield School & Sports College - 11 Minute Walk  
St Paul's Catholic Primary School - 10 Minute Walk  
St Michael's Catholic Academy - 8 Minute Drive  
The Wynyard, Sainsburys, Parade Of Shops - 10 Minute Walk  
Forum Theatre Billingham - 30 Minute Walk/6 Minute Drive  
Billingham Golf Club - 13 Minute Walk/3 Minute Drive

Distance Times Estimated Using Google Maps.

**ENTRANCE LEVEL**

**Entrance Porch**  
Entrance Porch Leads To The Hallway.

**Entrance Hallway**  
Entrance Door, Leads To The Longe & Staircase To First Floor, Storage Cupboard & Understairs Storage.

**Lounge**  
Feature Brick Fireplace With Gas Fire, uPVC Double Glazed Windows x2, Radiator.

**Dining Room**  
Feature Fireplace, uPVC Double Glazed Window, Radiator, Doors Leading To The Extension/Ground Floor Living Accommodation, Door Leading To The Kitchen.

**Kitchen**  
Cooking Range, Fridge & Freezer, Dishwasher, Units & Work Surface With Stainless Steel Sink, Space For Table & Chairs, uPVC Double Glazed Window, Radiator, Door Leading To The Utility Room.

**GROUND LEVEL**

**Ground Floor W/C**  
Fitted With White W/C, uPVC Double Glazed Window.

**Utility Room**  
Space For Appliances, Door Leading To The Garage.

**Storage Room**  
uPVC Double Glazed Window, Door Leading To The Office/Music Room.

**Office/Music Room**  
Full Soundproof Boarding & Insulated, Electric Points & Ventilation System.

**Integral Garage**  
Up & Over Door, Power Supply, Door Leading Into The Utility Room.

**EXTENSION**

**Ground Floor Living Room**  
Balcony Landing Leading From The Dining Room, uPVC Double Glazed Window, French Doors To The Garden, Exposed Beams, Radiator, Door Leading To The Bedroom.

**Ground Floor Bedroom**  
uPVC Double Glazed French Doors To The Garden, Storage Cupboard, Door Leading To The En-Suite.

**En-Suite Shower Room**  
Fitted With A White Suite Comprising; Hand Wash Basin, W/C, Walk In Shower, Radiator.

**FIRST LEVEL**

**First Floor Half Landing**  
Open Spindle Balustrade, Leads To Bedroom, Family Bathroom & Separate W/C.

**Bedroom**  
Fitted Wardrobes, uPVC Double Glazed Window, Radiator.

**W/C**  
Fitted With A White W/C, uPVC Double Glazed Window.

**Family Bathroom**  
Fitted With A White Three Piece Suite Comprising; Hand Wash Basin, Walk In Shower, Panelled Bath, uPVC Double Glazed Window, Radiator, Airing Cupboard.

**SECOND LEVEL**

**Second Floor Landing**  
Leading To Bedrooms & Sauna Room.

**Bedroom**  
Fitted Wardrobes, uPVC Double Glazed Window, Radiator, Door Leading To The En-Suite.

**En-Suite Bathroom**  
Fitted With A White Four Piece Suite Comprising; Hand Wash Basin, W/C, Panelled Bath, Walk In Shower, uPVC Double Glazed Window, Radiator.

**Sauna Room**  
Operational Sauna, Timber Structure, Glazed Panel To The Shower In The En-Suite.

**Bedroom**  
uPVC Double Glazed Window, Radiator, Storage Aea.

**Bedroom**  
uPVC Double Glazed Window, Radiator, Study Area.

**Loft Space**  
Insulated.

**Area Map**



**Floor Plans**

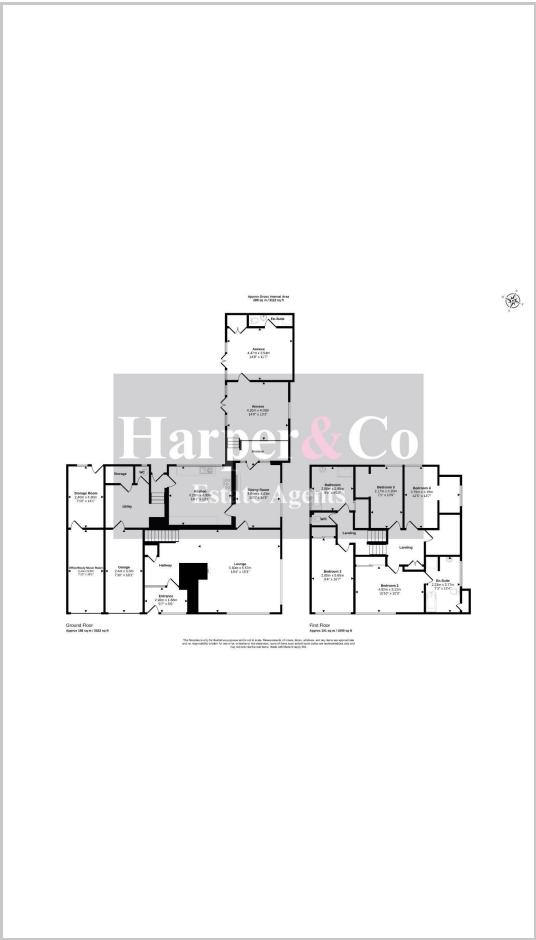

**Energy Efficiency Graph**

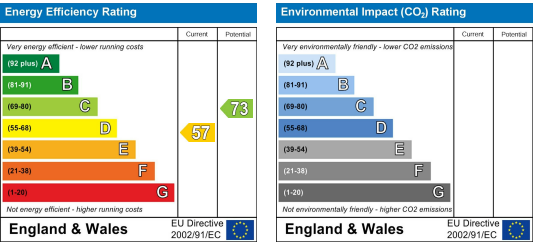

These particulars, whilst believed to be accurate are set out as a general outline only for guidance and do not constitute any part of an offer or contract. Intending purchasers should not rely on them as statements of representation of fact, but must satisfy themselves by inspection or otherwise as to their accuracy. No person in this firms employment has the authority to make or give any representation or warranty in respect of the property.