

# Harper & Co

Estate Agents Ltd

<https://www.harperandcoestateagents.co.uk>



## Leam Lane

Bishopsgarth, Stockton-On-Tees, TS19 8UJ

Well Presented Three Bedroom Family Home | Corner Plot | Sought After Location

Situated Within A Popular And Convenient Area Of Stockton-On-Tees, This Well Presented Three Bedroom Family Home Occupies A Generous Corner Plot And Offers Comfortable Accommodation Ideal For Families, First Time Buyers Or Investors.

**Offers in excess of £150,000**

# Leam Lane

Bishopsgarth, Stockton-On-Tees, TS19 8UJ



- Well Presented Three Bedroom Family Home
- Spacious Lounge With Feature Fireplace
- Three Well Appointed Bedrooms And Family Bathroom
- Driveway Providing Off Road Parking Close To Amenities And Schools
- Situated Within A Sought After Residential Location
- Separate Dining Area Ideal For Family Living
- Private Rear Garden With Lawn And Patio Seating Area
- Generous Corner Plot Offering Additional Outdoor Space
- Practical Kitchen With Good Storage And Workspace
- Detached Garage With Potential To Convert STPP

## Full Description

## Location

## Note

## Disclaimer

## Money Laundering Notice



## Directions



# Floor Plan

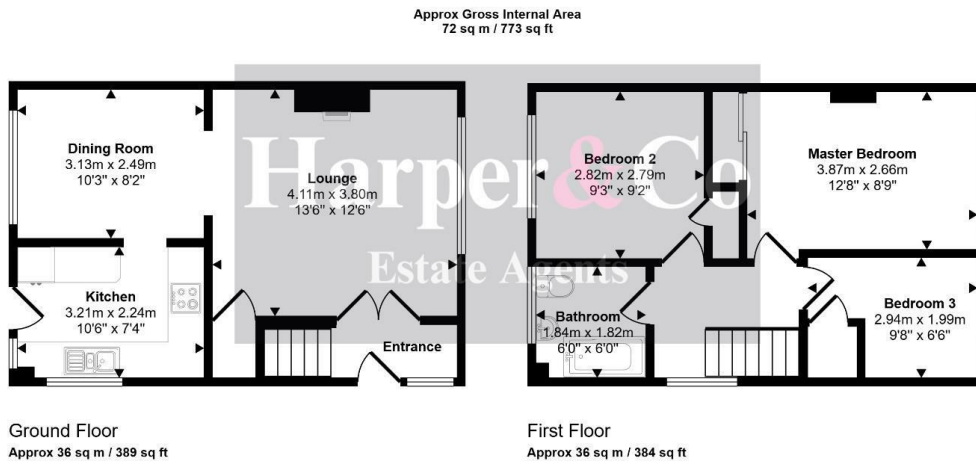

This floorplan is only for illustrative purposes and is not to scale. Measurements of rooms, doors, windows, and any items are approximate and no responsibility is taken for any error, omission or mis-statement. Icons of items such as bathroom suites are representations only and may not look like the real items. Made with Made Snappy 360.

These particulars, whilst believed to be accurate are set out as a general outline only for guidance and do not constitute any part of an offer or contract. Intending purchasers should not rely on them as statements of representation of fact, but must satisfy themselves by inspection or otherwise as to their accuracy. No person in this firm's employment has the authority to make or give any representation or warranty in respect of the property.

