

Lordship Park, N16
Approx. Gross Internal Area 545 Sq Ft - 50.63 Sq M

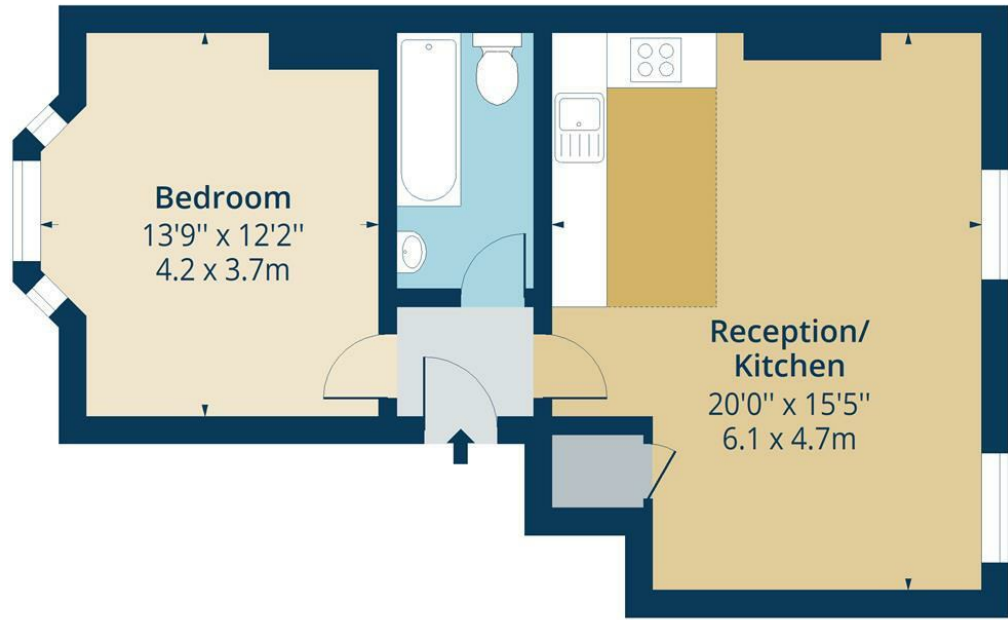

First Floor

Floor Area 545 Sq Ft - 50.63 Sq M



Measured according to RICS IPMS2. Floor plan is for illustrative purposes only and is not to scale. Every attempt has been made to ensure the accuracy of the floor plan shown, however all measurements, fixtures, fittings and data shown are an approximate interpretation for illustrative purposes only. 1 sq m = 10.76 sq feet.
lpaplus.com Date: 24/11/2023

Whilst every attempt has been made to ensure the accuracy of the floor plan contained here, measurements of doors, windows, rooms and any other items are approximate and no responsibility is taken for any error, omission or mis-statement. This plan is for illustrative purposes only and should be used as such by any prospective purchaser. The services, systems and appliances shown have not been tested and no guarantee as to their operability or efficiency can be given.



£1,700

This superb one bedroom property boasts a wealth of space, character and style. Located on the the first floor of a stunning period property on Lordship Park and offers excellent access to local transport links and amenities. There is a beautiful open-plan kitchen/dining/living space, with high ceilings and large windows that let the light flow through.

Lordship Park is a stone's throw away from Clissold Park, and is within easy reach of Woodberry Wetlands Nature Reserve, too. Outstanding local primary schools are close by, and Church Street's excellent mix of independent shops, bars and restaurants are only a short walk away. Connections into the City and Central London couldn't be quicker, with the 106 bus (stopping just outside) and stopping at Finsbury Park (Victoria, Piccadilly and National Rail) in under 10 minutes.



- GREAT LOCATION
- ONE DOUBLE BEDROOM

- LOTS OF NATURAL LIGHT

