

Flanders House, N16
Approx. Gross Internal Area 680 Sq Ft - 63.17 Sq M

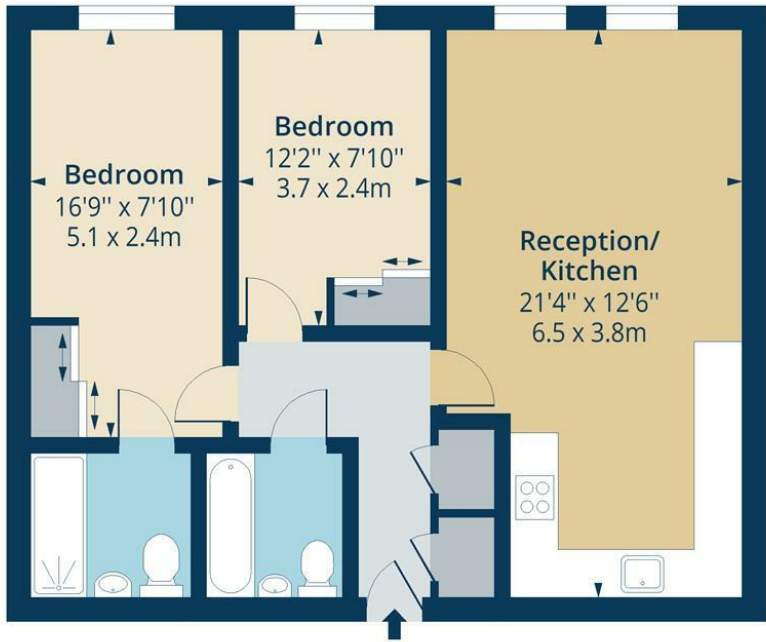

First Floor

Floor Area 680 Sq Ft - 63.17 Sq M



Measured according to RICS IPMS2. Floor plan is for illustrative purposes only and is not to scale. Every attempt has been made to ensure the accuracy of the floor plan shown, however all measurements, fixtures, fittings and data shown are an approximate interpretation for illustrative purposes only. 1 sq m = 10.76 sq feet.
lpaplus.com Date: 23/9/2024

Whilst every attempt has been made to ensure the accuracy of the floor plan contained here, measurements of doors, windows, rooms and any other items are approximate and no responsibility is taken for any error, omission or mis-statement. This plan is for illustrative purposes only and should be used as such by any prospective purchaser. The services, systems and appliances shown have not been tested and no guarantee as to their operability or efficiency can be given.



Defoe Road, N16



£2,300

This spacious and bright two-bedroom, two-bathroom apartment is ideally situated just off of Church Street in the heart of Stoke Newington. The property features two generous double bedrooms, and is flooded with natural light

Located within walking distance of both Stoke Newington and Rectory Road stations with the lovely Clissold Park is only moments away and an array of cafes, restaurants, and boutiques on your doorstep. This is a fantastic opportunity to experience the best of Stoke Newington living!



- TWO DOUBLE BEDROOMS
- TWO BATHROOMS

- AMAZING LOCATION

