

Poplar Grove, N11

Approx. Gross Internal Area Floor Area 465 Sq Ft - 43.20 Sq M

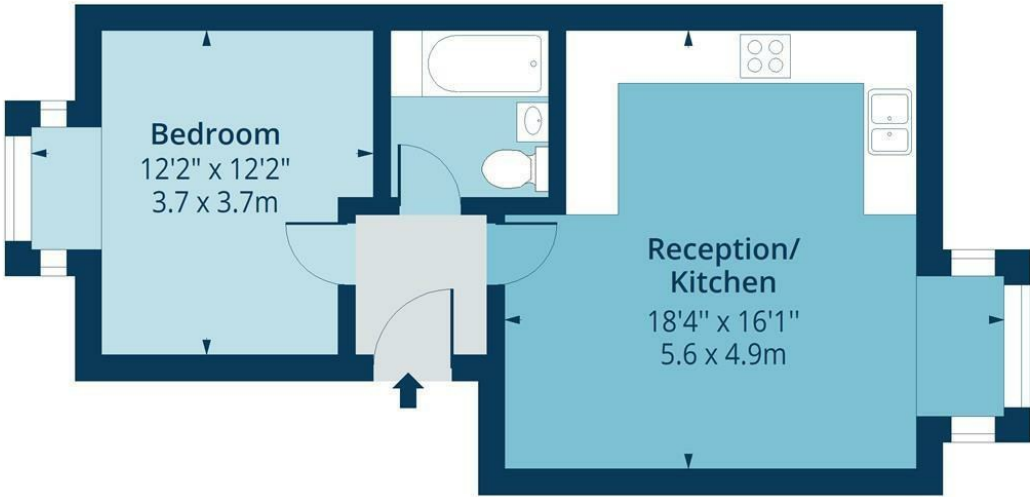

Ground Floor

Floor Area 465 Sq Ft - 43.20 Sq M



Measured according to RICS IPMS2. Floor plan is for illustrative purposes only and is not to scale. Every attempt has been made to ensure the accuracy of the floor plan shown, however all measurements, fixtures, fittings and data shown are an approximate interpretation for illustrative purposes only. 1 sq m = 10.76 sq feet.

lpaplus.com

Whilst every attempt has been made to ensure the accuracy of the floor plan contained here, measurements of doors, windows, rooms and any other items are approximate and no responsibility is taken for any error, omission or mis-statement. This plan is for illustrative purposes only and should be used as such by any prospective purchaser. The services, systems and appliances shown have not been tested and no guarantee as to their operability or efficiency can be given.



£1,325 PCM

A nicely presented one bedroom apartment located on the ground floor of a popular modern development. The property comprises a large open plan reception room with modern integrated kitchen, a contemporary bathroom, and a double bedroom. The property also benefits from double glazing and gas central heating, and comes with parking for residents.

Conveniently located, offering easy access to nearby transport links such as the A406 and New Southgate train station. Local hotspots such as Friern Barnet and Muswell Hill are nearby and easy to get to.



