

Lea View House, E5
Approx. Gross Internal Area 533 Sq Ft - 49.52 Sq M
Approx. Gross Balcony Area 24 Sq Ft - 2.23 Sq M

OAKWOOD

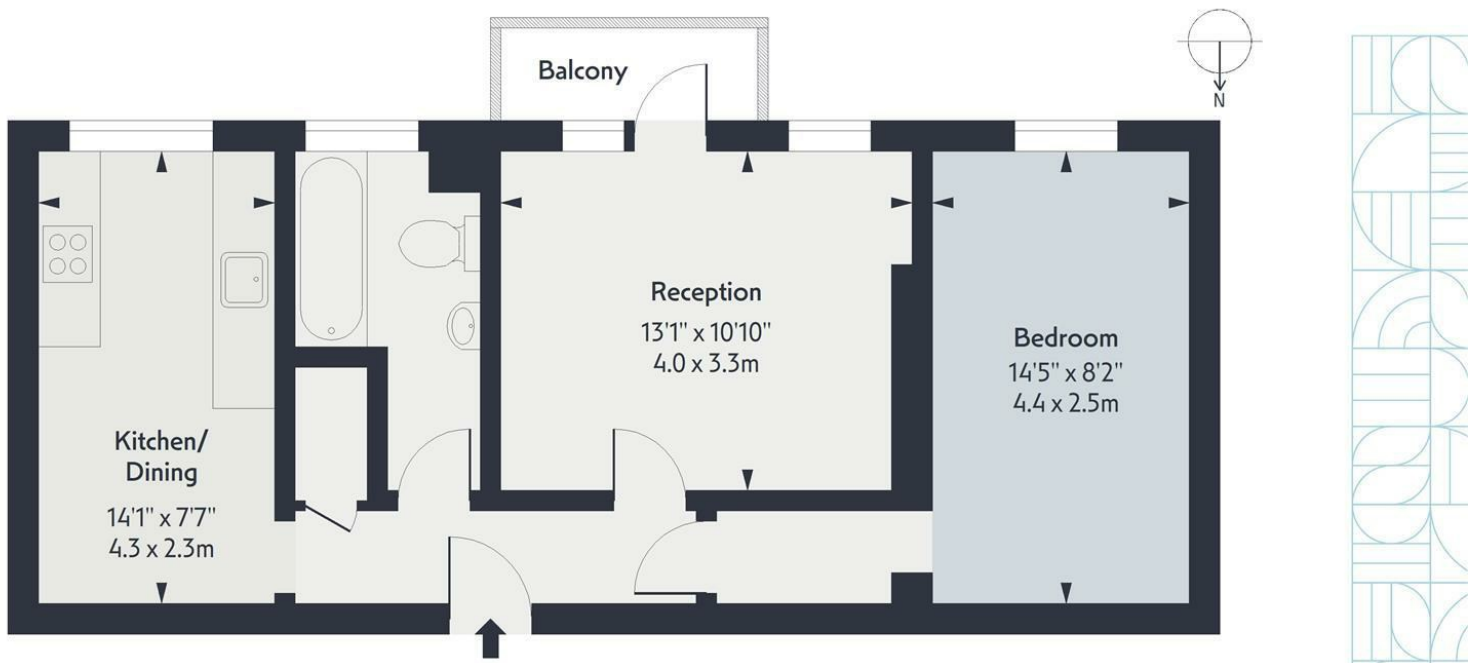

Measured according to RICS IPMS2. Floor plan is for illustrative purposes only and is not to scale. Every attempt has been made to ensure the accuracy of the floor plan shown, however all measurements, fixtures, fittings and data shown are an approximate interpretation for illustrative purposes only. 1 sq m = 10.76sq feet.

Date: 8/9/2025

Whilst every attempt has been made to ensure the accuracy of the floor plan contained here, measurements of doors, windows, rooms and any other items are approximate and no responsibility is taken for any error, omission or mis-statement. This plan is for illustrative purposes only and should be used as such by any prospective purchaser. The services, systems and appliances shown have not been tested and no guarantee as to their operability or efficiency can be given.



Springfield, E5



£1,600

Located on the fourth floor of a purpose-built block, this one-bedroom flat offers bright and well-proportioned living space, along with a private balcony overlooking Springfield Park. The property includes a spacious living room, separate kitchen, double bedroom, and bathroom. Ideally situated within walking distance of Clapton Overground Station, local shops, cafés, and bus routes, with excellent green space on your doorstep.



- ONE BEDROOM
- PRIVATE BALCONY

• OPPOSITE SPRINGFIELD PARK

