



Redcroft Road, Southall, UB1 3PB

A very well presented and spacious 2 bed flat enjoying both double glazing & GCH. Accommodation comprises entrance with fitted storage cupboards, tastefully decorated living room, fitted kitchen & modern bathroom & 2 double bedrooms. The property would make an ideal first time buy or rental investment.

Located with walking distance of local shops & public transport with direct access to Ealing Broadway and Ealing underground station & Greenford Broadway & underground station (Central Line) and also Lady of the Visitation primary School & Cardinal Wiseman High School and also Ealing Hospital.

Offers In Excess Of £250,000

Tel: 020 8573 9922 Fax: 020 8569 3495

254 Kingshill Avenue, Hayes, Middlesex, UB4 8BZ

Email: info@charrisondavis.com www.charrisondavis.co.uk

3 Redcroft Road, Southall, UB1 3PB



3 Redcroft Road, Southall, UB1 3PB



3 Redcroft Road, Southall, UB1 3PB



3 Redcroft Road, Southall, UB1 3PB



3 Redcroft Road, Southall, UB1 3PB



3 Redcroft Road, Southall, UB1 3PB



3 Redcroft Road, Southall, UB1 3PB

First Floor

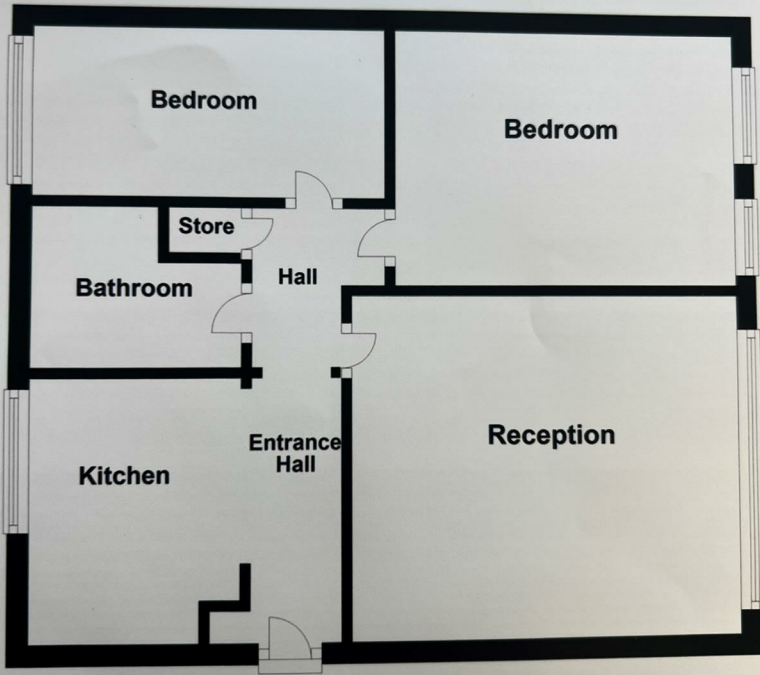

https://www.charrison.co.uk/properties/155192810/floorplan?activePlan=1&channel=RES_BUY

Energy Efficiency Rating

	Current	Potential
<p><i>Very energy efficient - lower running costs</i></p> <p>(92 plus) A</p> <p>(81-91) B</p> <p>(69-80) C</p> <p>(55-68) D</p> <p>(39-54) E</p> <p>(21-38) F</p> <p>(1-20) G</p> <p><i>Not energy efficient - higher running costs</i></p>	<p>58</p>	<p>74</p>
<p>England & Wales</p>	<p>EU Directive 2002/91/EC</p>	

3 Redcroft Road, Southall, UB1 3PB

