



26 High Street, Royal Wootton Bassett, Wiltshire SN4 7AA  
Telephone SALES: 01793 840222 or LETTINGS 01793 855222  
Email: sales@alanhawkins.co.uk or lettings@alanhawkins.co.uk

alanhawkins.co.uk  
alan hawkins  
PROPERTY SALES & LETTINGS

alan hawkins  
PROPERTY SALES & LETTINGS



124 Lillybrook Estate, Lyneham, SN15 4AA

Library Image



# 124 Lillybrook Estate, Lyneham, SN15 4AA

## POA

Plot 124 is an impressive 47' x 22' park home. (Delivery to be confirmed)

- Brand New -
- Arrival to be confirmed -
- Spacious 47' x 22' Park Home -
- Eco-Friendly - Low Energy! -
- Garage -
- Off Road Parking -
- uPVC Triple Glazing -
- Air Source Heat Pump -

### Council Tax - Wiltshire Council

Tax Band 'A'

For information on tax banding and rates, please call Wiltshire Council, Monkton Park. Chippenham. Wiltshire. SN15 1ER. Tel: 0300 456 0109

### Lillybrook

LUXURY LIVING FOR THE OVER 50's.

Lillybrook Estate is situated in the North Wiltshire countryside located between the villages of Bradenstoke and Lyneham and is a registered residential site exclusively for the over fifties.

Being predominantly open plan gardens, as a site they are unable to accommodate dogs, although visitors are welcome to bring their dog provided it is kept on a lead.

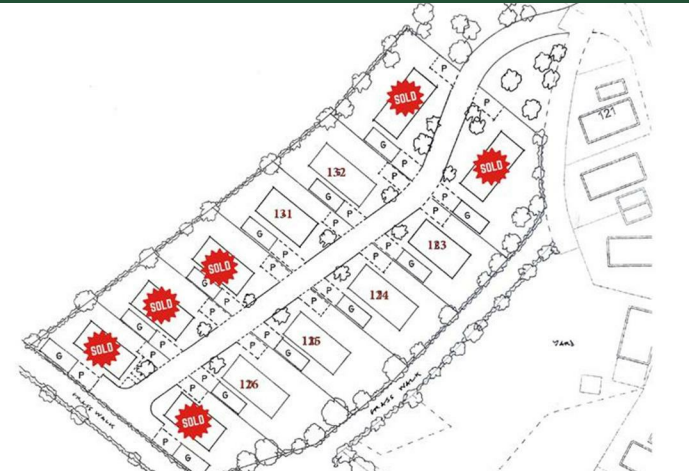

alan hawkins

PROPERTY SALES & LETTINGS

RESERVE NOW

- EXCITING NEW DEVELOPMENT
- OVER 50'S
- 12 NEW PARK HOMES **100% NOW SOLD**
- HOMES SIZES FROM 42' X 22'
- PRICES STARTING FROM £220,000

Lillybrook

PARK HOMES