



1 Dior Drive, Royal Wootton Bassett, SN4 7FQ

- Three Bedroom End Terrace
- Driveway & Garage
- Garage With Power & Lighting
- Rear Gated Access
- Generous South-East Facing Rear Garden
- Kitchen/Diner
- French Doors To Rear Garden
- Cloakroom
- En-Suite Shower Room
- Family Bathroom With Window



1 Dior Drive, Royal Wootton Bassett, SN4 7FQ

Offers in excess of £265,000

An attractive three bedroom end of terrace family home benefiting a generous and low maintenance, 40ft private and fully enclosed rear garden with gated access direct to the driveway and garage which includes power & lighting.

The home itself offers a front entrance hallway with cloakroom, a spacious living room, inner hallway with stairs to the first floor landing and a kitchen/diner across the rear which includes French doors opening out to the rear garden.

Upstairs and to the first floor you will find three bedrooms with both bedrooms one and two having built in or fitted wardrobes, an en-suite shower room to bedroom one and a family bathroom benefiting a uPVC double glazed window.

Further benefits of this wonderful home include a South-East facing rear garden, uPVC double glazed windows throughout and gas radiator central heating via a combination boiler.

For more information or to arrange a viewing, contact Alan Hawkins Property Sales today to avoid missing out.

Viewings

Viewing: By appointment through Alan Hawkins Property Sales. Tel: 01793 840222

Council Tax - Wiltshire Council

Council Tax Band C

For information on tax banding and rates, please call Wiltshire Council, Monkton Park. Chippenham. Wiltshire. SN15 1ER. Tel: 0300 456 0109

Royal Wootton Bassett

Royal Wootton Bassett is a thriving Wiltshire Market Town with a population now totalling approximately 12500. The town is generally considered to date from the 681 AD Malmesbury charter, although it may have existed in Roman times. In the 13th century, Alan Bassett created the layout of the 'new' town as he sought to enlarge his then small settlement of Wootton, and thereby gave rise to the present name of Wootton Bassett.

Royal Wootton Bassett is a lively self-contained community with a wide variety of local schools, shops, services and leisure facilities including its own sports centre, the 'Wiltshire Golf Course', just a mile outside of town and a restored stretch of the Wilts and Berks Canal.







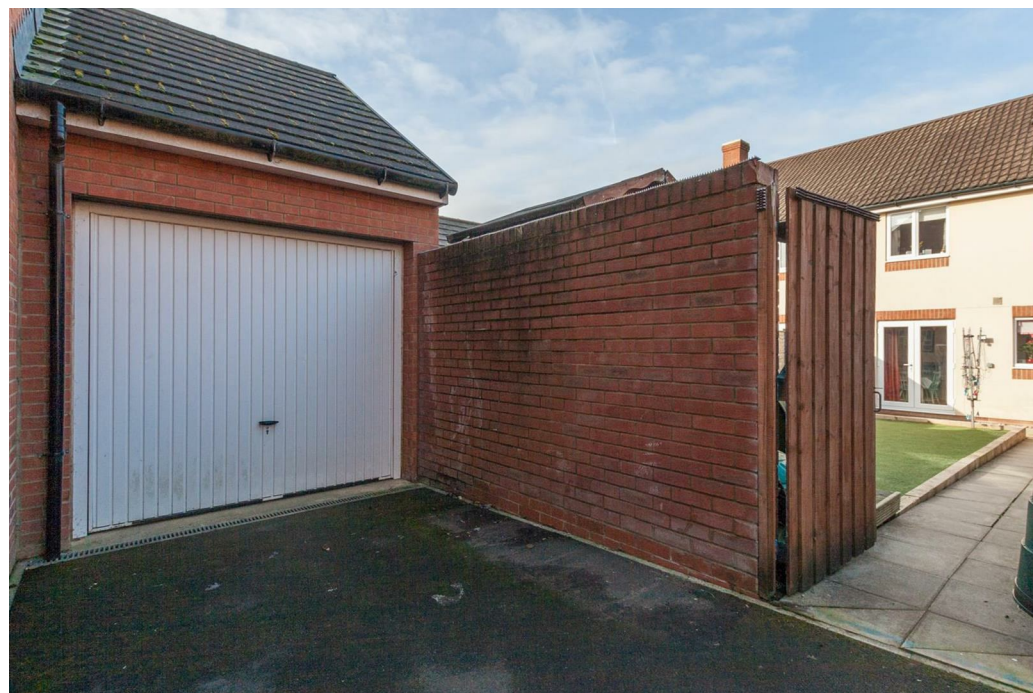

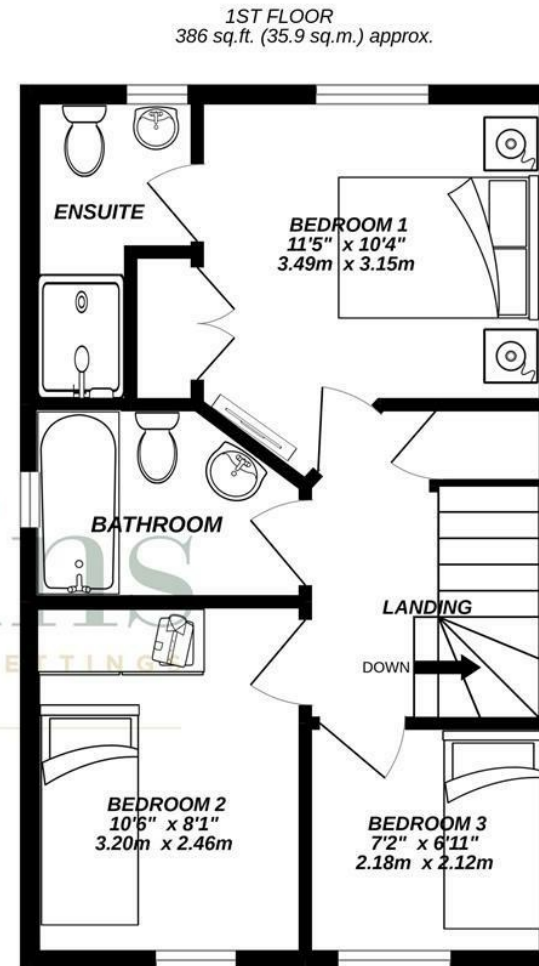
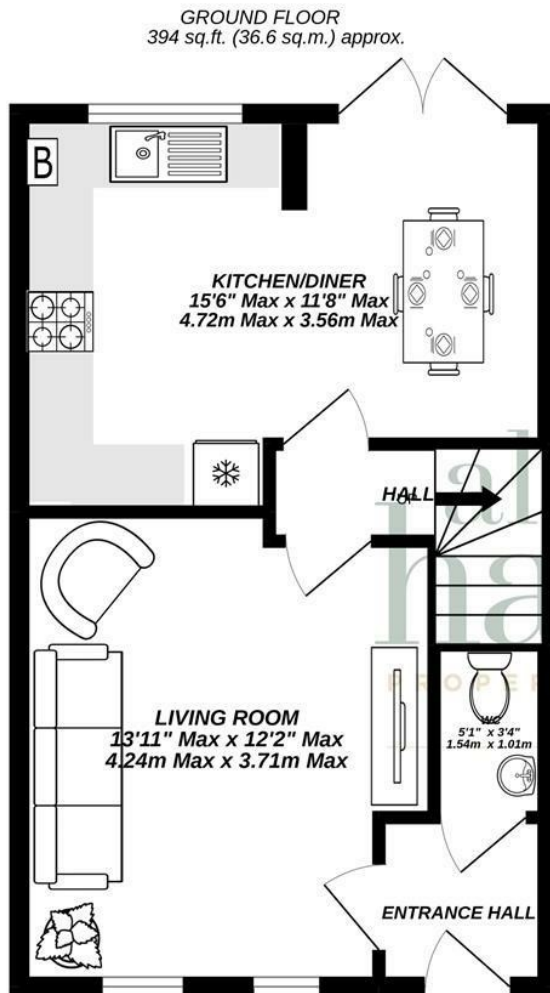

THREE BED END TERRACE

TOTAL FLOOR AREA : 780 sq.ft. (72.5 sq.m.) approx.

Whilst every attempt has been made to ensure the accuracy of the floorplan contained here, measurements of doors, windows, rooms and any other items are approximate and no responsibility is taken for any error, omission or mis-statement. This plan is for illustrative purposes only and should be used as such by any prospective purchaser. The services, systems and appliances shown have not been tested and no guarantee as to their operability or efficiency can be given.
Made with Metropix ©2022

Disclaimer: These particulars are believed to be correct but their accuracy cannot be guaranteed. They do not form part of the contract and Alan Hawkins Estate Agents are not to be held liable in any way for any mistakes or inaccuracies in these particulars. The agents have not tested any apparatus, equipment, fixtures or services and so cannot verify they are in working order, or fit for their purposes, neither have the agents checked the legal documents to verify the freehold/leasehold status of the property. The buyer is advised to obtain verification from their solicitor/surveyor.

alanhawkins.co.uk



26 High Street, Royal Wootton Bassett, Wiltshire SN4 7AA
Telephone SALES: 01793 840222 or LETTINGS 01793 855222
Email: sales@alanhawkins.co.uk or lettings@alanhawkins.co.uk

