

26 High Street, Royal Wootton Bassett, Wiltshire SN4 7AA
Telephone SALES: 01793 840222 or LETTINGS 01793 855222
Email: sales@alanhawkins.co.uk or lettings@alanhawkins.co.uk



alanhawkins.co.uk
PROPERTY SALES & LETTINGS
alan hawkins

alan hawkins
PROPERTY SALES & LETTINGS



4 Hart Close, Royal Wootton Bassett, SN4 7FN

4 Hart Close, Royal Wootton Bassett, SN4 7FN

£184,995

A surprisingly spacious TWO DOUBLE bedroom FREEHOLD COACH HOUSE situated in a cul-de-sac location in Royal Wootton Bassett. Constructed c2009, this style of property offers an entrance hall leading to the landing, a living room with a large opening to the c18ft Kitchen/diner with built-in oven & hob, two large double bedrooms & an updated bathroom with shower over bath. There is a garage under providing power and lighting with a secure and spacious under stair cupboard and further storage provided via the loft space.

Further attributes of this property includes gas central heating and uPVC double glazing. This is rare style of coach house for this location and a viewing is highly recommended. Call Alan Hawkins Property Sales today to request your virtual video tour and to arrange a viewing.

Virtual Video Tour

A virtual video tour is available on request. For more details email sales@alanhawkins.co.uk or call us on 01793 840222.

Viewings

Viewing: By appointment through Alan Hawkins Property Sales. Tel: 01793 840222

Council Tax - Wiltshire Council

For information on tax banding and rates, please call Wiltshire Council, Monkton Park. Chippenham. Wiltshire. SN15 1ER. Tel: 0300 456 0109

Royal Wootton Bassett

Royal Wootton Bassett is a thriving Wiltshire Market Town with a population now totalling approximately 12500. The town is generally considered to date from the 681 AD Malmesbury charter, although it may have existed in Roman times. In the 13th century, Alan Bassett created the layout of the 'new' town as he sought to enlarge his then small settlement of Wootton, and thereby gave rise to the present name of Wootton Bassett.

Royal Wootton Bassett is a lively self-contained community with a wide variety of local schools, shops, services and leisure facilities including its own sports centre, the 'Wiltshire Golf Course', just a mile outside of town and a restored stretch of the Wilts and Berks Canal.

Ground Floor
Approx. 20.4 sq. metres (219.3 sq. feet)

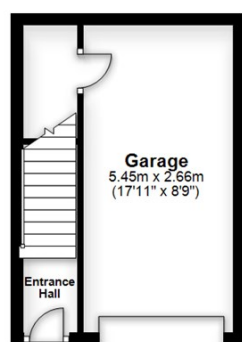

First Floor
Approx. 72.7 sq. metres (783.0 sq. feet)

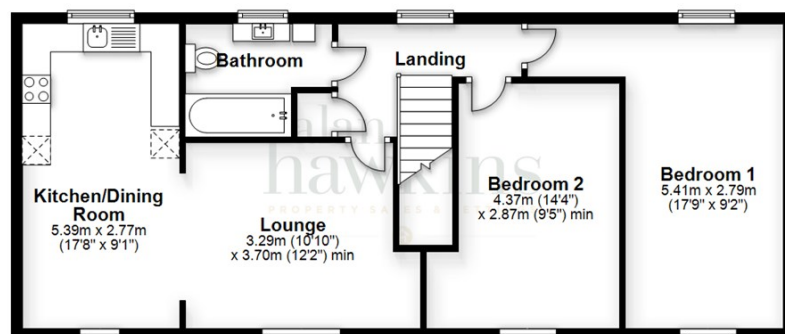

Total area: approx. 93.1 sq. metres (1002.3 sq. feet)

All measurements of doors, windows, rooms and any other items are approximate and no responsibility is taken for any error, omissions or mis-statement. This plan is for illustrative purposes only and should be used as such. Not to scale. All Rights Reserved. No unauthorised use, copying or reproduction permitted.
Plan produced using PlanUp.

