



Greenfield Estate, Lyneham, SN15 4PA

01793 840 222 | alanhawkins.co.uk

alan
hawkins
PROPERTY SALES & LETTINGS



alan

- Brand New Park Home
- Two Bedrooms
- Contemporary Kitchen with Appliances
- Surrounding Gardens
- Pets Permitted (Subject to owners permission)
- 40' x 20'
- Stunning Open Plan Design
- Delightful Bedroom Suite
- Off Road Parking
- Over 50's Only

24 Greenfield Estate Lyneham, SN15 4PA

£220,000

Plot 24 is a stunning 40 x 20 Stately Albion home built to the 'Hardwick' design. It has a contemporary open plan living area with a stunning kitchen with integrated appliances and central island. The living area is wonderfully light with windows to 3 aspects and features a wall hung fire. An internal hallway gives access to a stylish bathroom, bedroom two with built in wardrobe and an impressive main bedroom with dressing area leading to the en-suite shower room. This property is sited now and nearing completion ready for occupation. To the outside is a surrounding garden and block paved driveway providing off road parking.

Greenfields Estate is a small licenced residential mobile home site catering for the over fifties located in the village of Lyneham providing access to local amenities and bus routes to neighbouring towns of Chippenham, Royal Wootton Bassett and Swindon. Pets, including dogs, are permitted on site subject to the site owners permission.

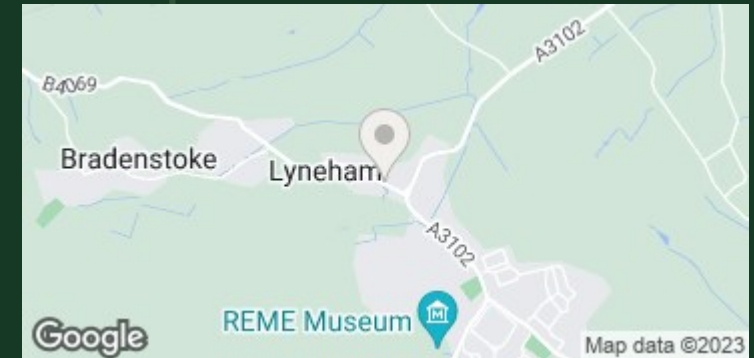

Viewings

By appointment through Alan Hawkins Property Sales. Tel: 01793 840 222

Council Tax: Wiltshire Council

Tax Band A For information on tax banding and rates, please call Wiltshire Council

Tenure

Mobile Homes Act 1983

Management Fee

Pitch Fee for 2022/23 = £203.49 inc Water + Sewage

Energy Efficiency Rating (England & Wales)

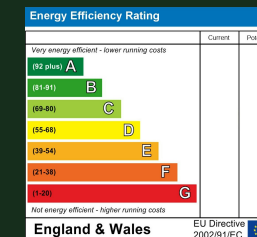







GROUND FLOOR
713 sq.ft. (66.2 sq.m.) approx.

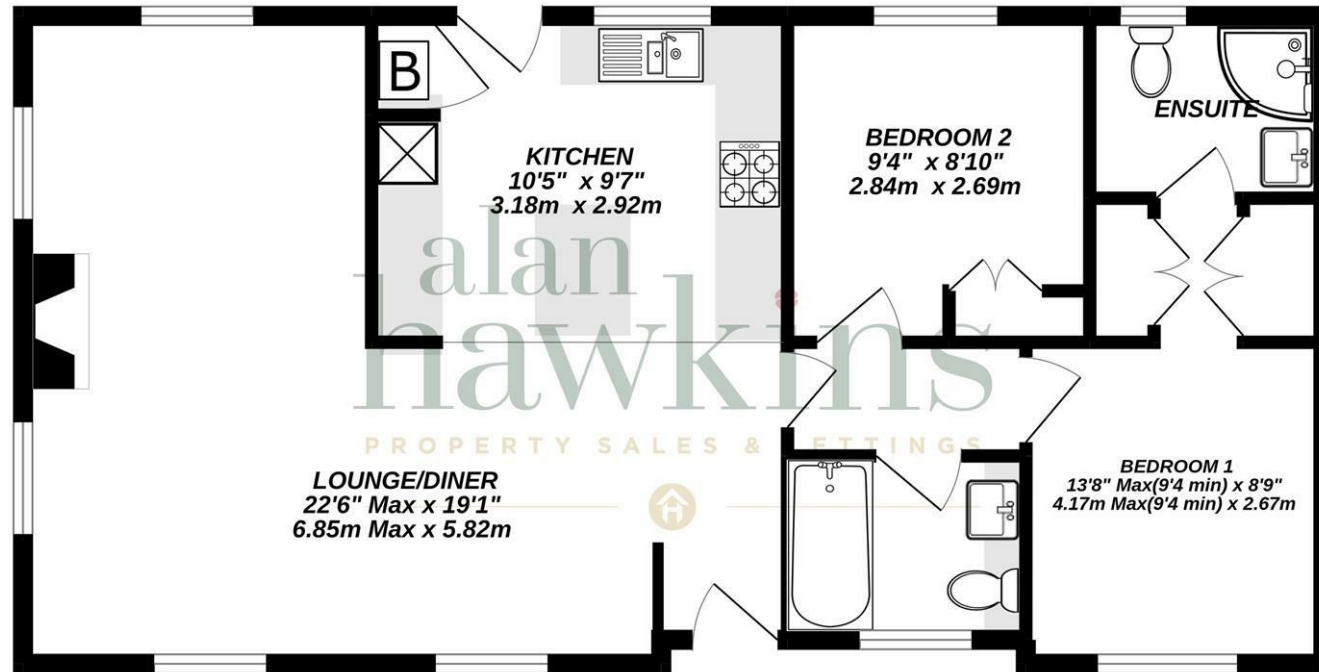

TOTAL FLOOR AREA : 713 sq.ft. (66.2 sq.m.) approx.

Whilst every attempt has been made to ensure the accuracy of the floorplan contained here, measurements of doors, windows, rooms and any other items are approximate and no responsibility is taken for any error, omission or mis-statement. This plan is for illustrative purposes only and should be used as such by any prospective purchaser. The services, systems and appliances shown have not been tested and no guarantee as to their operability or efficiency can be given.

Made with Metropix ©2022

Disclaimer: These particulars are believed to be correct but their accuracy cannot be guaranteed. They do not form part of the contract and Alan Hawkins Estate Agents are not to be held liable in any way for any mistakes or inaccuracies in these particulars. The agents have not tested any apparatus,

equipment, fixtures or services and so cannot verify they are in working order, or fit for their purposes, neither have the agents checked the legal documents to verify the freehold/leasehold status of the property. The buyer is advised to obtain verification from their solicitor/surveyor.

alan hawkins

PROPERTY SALES & LETTINGS

01793 840 222 | alanhawkins.co.uk

Alan Hawkins

26/26a High Street,
Royal Wootton Bassett
Wiltshire, SN4 7AA

