

26 High Street, Royal Wootton Bassett, Wiltshire SN4 7AA
Telephone SALES: 01793 840222 or LETTINGS 01793 855222
Email: sales@alanhawkins.co.uk or lettings@alanhawkins.co.uk



alanhawkins.co.uk
alan hawkins
PROPERTY SALES & LETTINGS

alan hawkins
PROPERTY SALES & LETTINGS



Blain Place, Royal Wootton Bassett, SN4 8FF

Blain Place, Royal Wootton Bassett, SN4 8FF

Offers in excess of £335,000

A desirable 2014 'Taylor Wimpey' constructed 3 bedroom DETACHED family home with CONSERVATORY addition, GARAGE and off road parking located on this very popular development in the historic market town of Royal Wootton Bassett. The internal accommodation offers a front entrance hallway, cloakroom, kitchen/breakfast room with built-in oven & hob & dishwasher and a lounge/diner to the rear of the property with French patio doors leading to a conservatory with glass roof. To the first floor is a 'like new' bathroom, two double bedrooms with the master providing an en-suite shower room and fitted wardrobes with bedroom 3 being a generous single room. Outside to the front is a garden laid to lawn with side gated access to the rear garden which again is laid to lawn and non-overlooked from the immediate rear.

Further attributes include gas radiator central heating, uPVC double glazing, NEWLY fitted carpets and solar panels to the roof (25 year lease) as well as the remainder of a 10 year NHBC warranty. Offered with 'No Onward Chain' an internal viewing is highly recommended. Call Alan Hawkins Property Sales on 01793 840222.

Council Tax - Wiltshire Council

Council Tax Band D

For information on tax banding and rates, please call Wiltshire Council, Monkton Park, Chippenham, Wiltshire, SN15 1ER. Tel: 0300 456 0109

Viewings

Viewing: By appointment through Alan Hawkins Property Sales. Tel: 01793 840222

Tenure

Freehold.

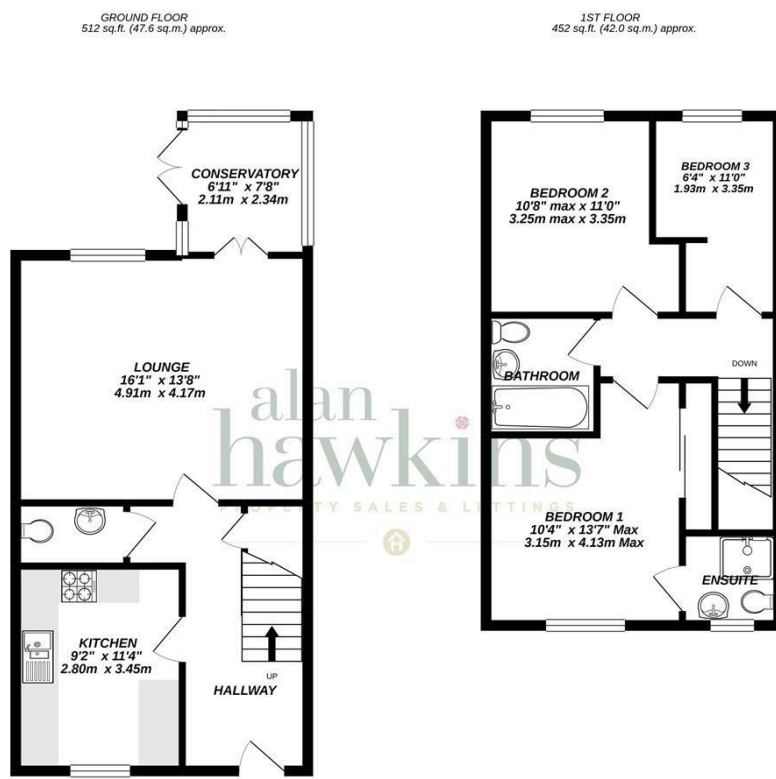
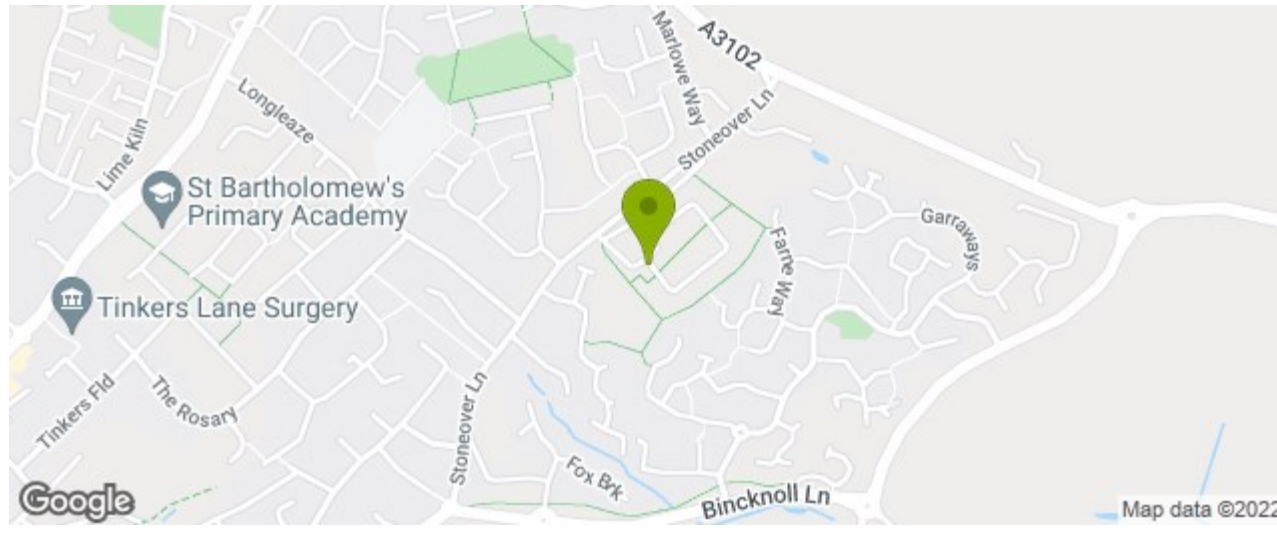

TOTAL FLOOR AREA: 965 sq. ft. (89.6 sq. m.) approx.
Whilst every attempt has been made to ensure the accuracy of the floorplan contained here, measurements of doors, windows, rooms and any other items are approximate and no responsibility is taken for any error, omission or misstatement. This plan is for guidance purposes only and should be used as such by any prospective purchaser. The services, systems and appliances shown have not been tested and no guarantee is given as to their operability or efficiency can be given.
Made with floorplan 02022

