

26 High Street, Royal Wootton Bassett, Wiltshire SN4 7AA
Telephone SALES: 01793 840222 or LETTINGS 01793 855222
Email: sales@alanhawkins.co.uk or lettings@alanhawkins.co.uk



alanhawkins.co.uk
PROPERTY SALES & LETTINGS
alan hawkins

alan hawkins
PROPERTY SALES & LETTINGS



27 Cricketers Close, Royal Wootton Bassett, SN4 8JD

27 Cricketers Close, Royal Wootton Bassett, SN4 8JD

Offers in excess of £310,000

A very well maintained and spacious FOUR DOUBLE bedroom semi-detached house with GARAGE being centrally located and within walking distance of the high street in the market town of Royal Wootton Bassett allowing ease of access to local amenities including schools and the 'Outstanding' Royal Wootton Bassett Academy. Constructed in 2015, this property comprises an entrance hallway with cloakroom, Kitchen and a generous living/dining room with French door to the rear garden. To the first floor, a master bedroom complete with en-suite shower room and bedroom two whilst to the second floor is a family bathroom and bedrooms three and four, all being very generous doubles in size. The rear garden is fully enclosed by fencing with a side gate providing access to the garage and parking space. Further attributes include gas radiator central heating via a combination boiler, uPVC double glazing and c4 years remaining of the NHBC warranty.

An ideal purchase for any growing family. Call Alan Hawkins Property Sales today on 01793 840222 to arrange a viewing.

- End of Terrace Town House
- 4 Double Bedrooms
- Two Bathrooms
- Kitchen with Appliances
- Lounge/Diner
- Garage
- Enclosed Rear garden with patio and Lawn

Council Tax - Wiltshire Council

For information on tax banding and rates, please call Wiltshire Council, Monkton Park, Chippenham, Wiltshire, SN15 1ER. Tel: 0300 456 0109

Viewings

Viewing: By appointment through Alan Hawkins Property Sales. Tel: 01793 840222

Tenure

Freehold. The garage is subject to a 999 year Lease.
An annual maintenance fee for the upkeep of communal areas is also payable at c£120 p/a.

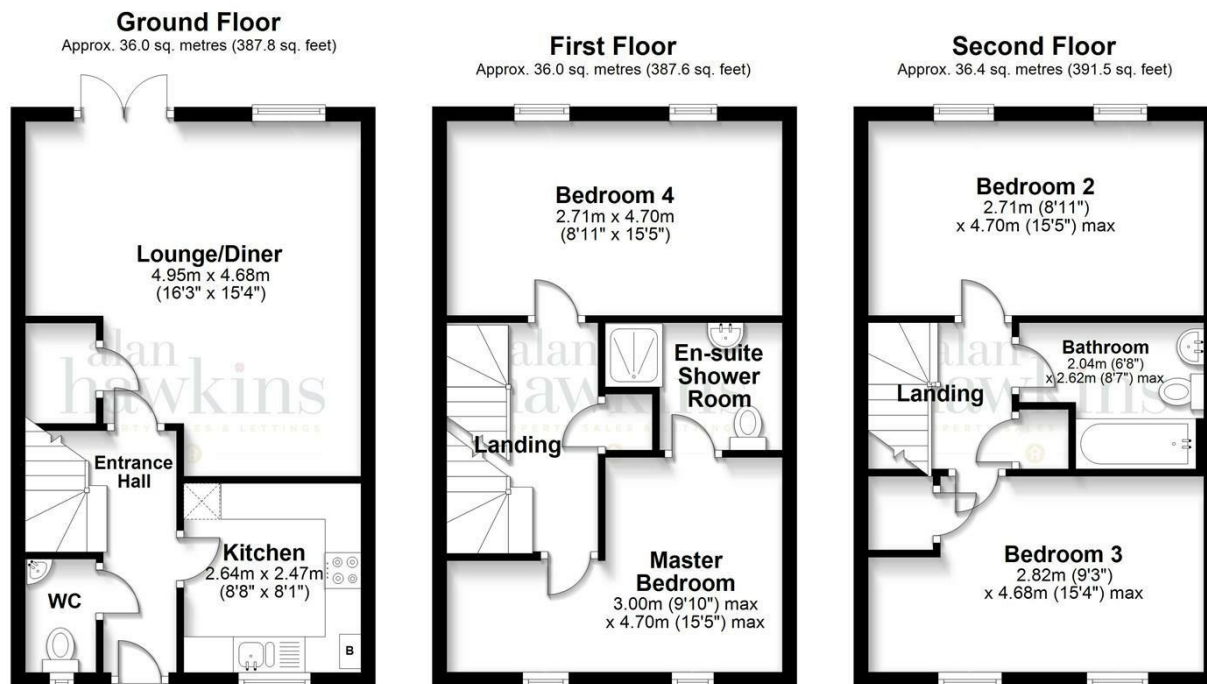

Total area: approx. 108.4 sq. metres (1167.0 sq. feet)

Produced by Alan Hawkins Est Agts for use only by Alan Hawkins. All measurements of doors, windows, rooms and any other items are approximate and no responsibility is taken for any error, omissions or mis-statement. This plan is for illustrative purposes only and should be used as such. Not to scale. All Rights Reserved, no unauthorised use copying or reproduction permitted.
Plan produced using PlanUp.

