

26 High Street, Royal Wootton Bassett, Wiltshire SN4 7AA
Telephone SALES: 01793 840222 or LETTINGS 01793 855222
Email: sales@alanhawkins.co.uk or lettings@alanhawkins.co.uk

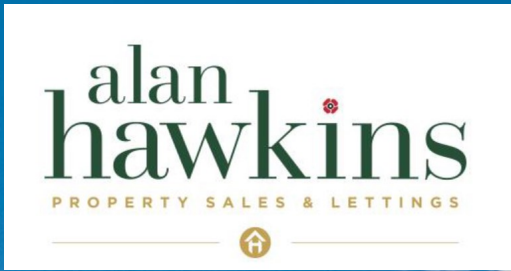

alanhawkins.co.uk



Pastorale York Lane, Brinkworth, SN15 5AN

Pastorale York Lane, Brinkworth, SN15 5AN
£359,950

An extended 2/3 bedroom detached bungalow occupying a generous corner plot with garage and ample parking in the village of Brinkworth, a desirable village nestled between the historic market towns of Malmesbury, Cricklade and Royal Wootton Bassett. Offered with 'no onward chain' and in need of some updating, this particular well cared for property offers versatile accommodation which includes a conservatory, hallway, dining room/bedroom three, an inner study, large living room, kitchen, shower room and two good bedrooms to the rear. To the outside are surrounding garden which a hedgerow border and gravelled driveway providing off road parking for several vehicles or caravan/motor home and single garage.

- Hallway
- Kitchen
- Dining Room/Bedroom 3
- Study Area
- Living Room
- Bedroom 1
- Bedroom 2
- Shower Room
- Garage

Council Tax - Wiltshire Council
For information on tax banding and rates, please call Wiltshire Council, Monkton Park. Chippenham. Wiltshire. SN15 1ER. Tel: 0300 456 0109

Viewings
Viewing: By appointment through Alan Hawkins Property Sales. Tel: 01793 840222

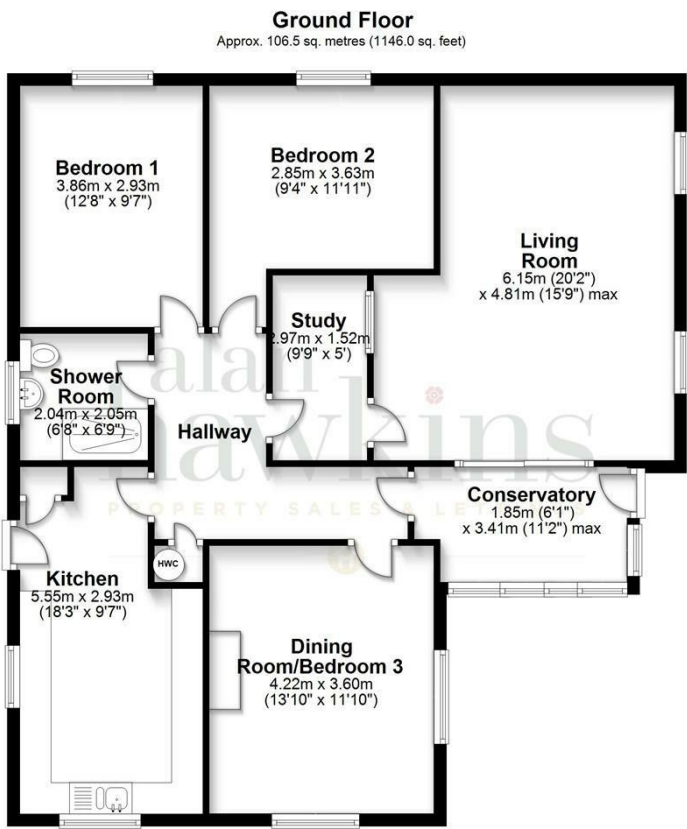

Total area: approx. 106.5 sq. metres (1146.0 sq. feet)
All measurements of doors, windows, rooms and any other items are approximate and no responsibility is taken for any error, omissions or mis-statement. This plan is for illustrative purposes only and should be used as such. Not to scale. All Rights Reserved, no unauthorised use, copying or reproduction permitted.
Plan produced using PlanUp.

